

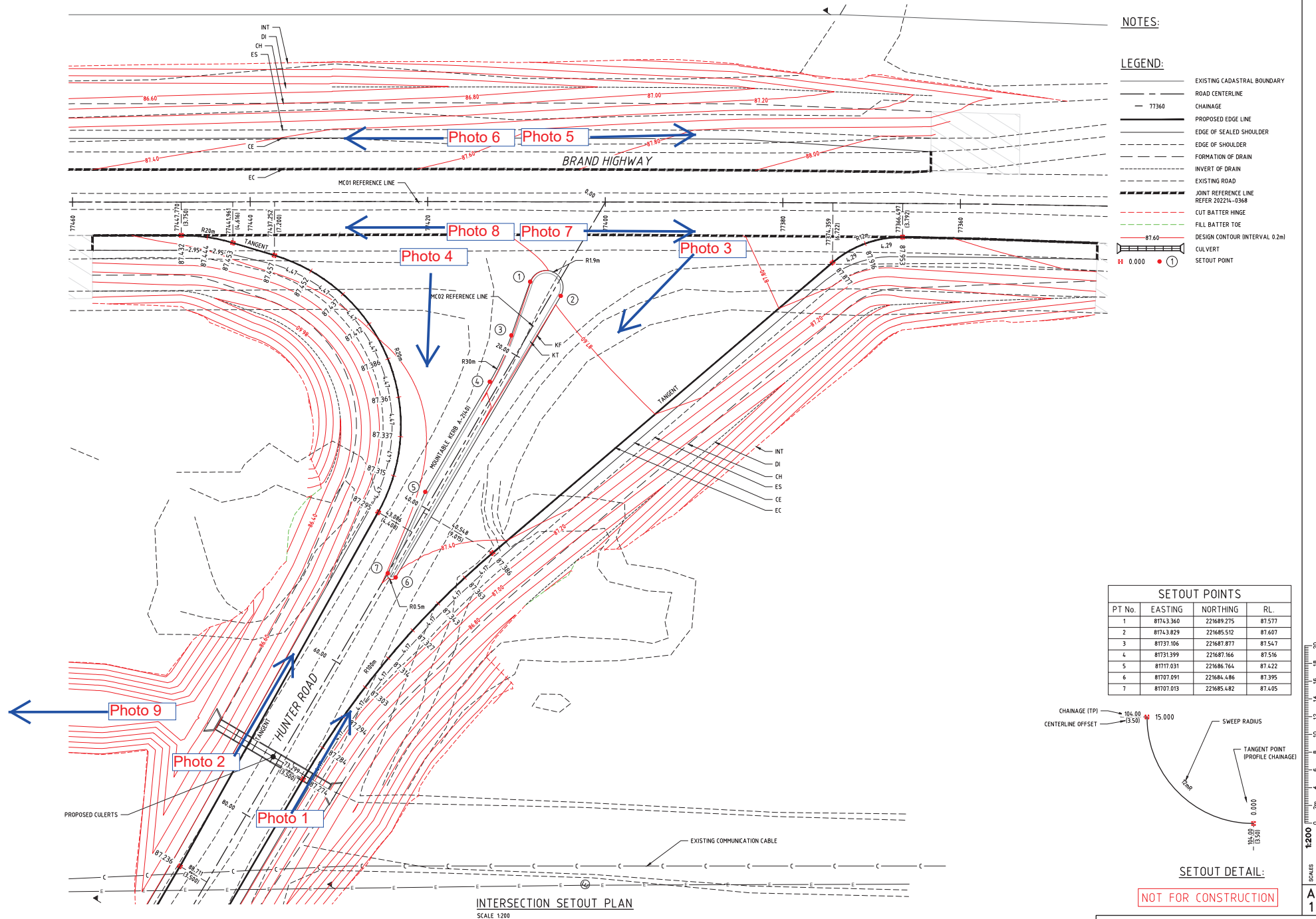

NOTES:

LEGEND:

- EXISTING CADASTRAL BOUNDARY
- ROAD CENTERLINE
- CHAINAGE
- PROPOSED EDGE LINE
- EDGE OF SEALED SHOULDER
- EDGE OF SHOULDER
- FORMATION OF DRAIN
- INVERT OF DRAIN
- EXISTING ROAD
- JOINT REFERENCE LINE REFER 202214-0368
- CUT BATTER HINGE
- FILL BATTER TOE
- DESIGN CONTOUR INTERVAL 0.2m
- CULVERT
- SETOUT POINT



SETOUT POINTS			
PT No.	EASTING	NORTHING	RL
1	87143.360	221689.275	87.577
2	87143.829	221685.512	87.607
3	87137.106	221687.877	87.547
4	87131.399	221687.166	87.516
5	87177.031	221686.764	87.422
6	87107.091	221684.486	87.395
7	87107.013	221685.482	87.405

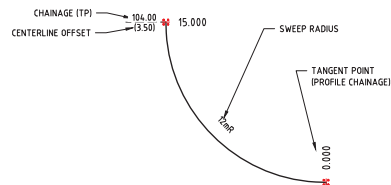

SETOUT DETAIL:

NOT FOR CONSTRUCTION

BRAND HWY INTERSECTION DESIGN

BRAND HWY (H004)
SLK 77.30 TO SLK 77.50
INTERSECTION LAYOUT PLAN

LOCAL AUTHORITY (S04) SHIRE OF DANDARAGAN

MRWA DRAWING NUMBER

202214-0362-D



AMENDMENTS	
No.	DESCRIPTION
D	ISSUED FOR 100% DESIGN REVIEW
C	ISSUED FOR 85% DESIGN REVIEW
B	ISSUED FOR 15% DESIGN REVIEW
A	ISSUED FOR 15% DESIGN REVIEW



METADATA
GROUND SURVEY STANDARD: 67-08-43
DATE OF CAPTURE: 07/04/2022
MAPPING SURVEY STANDARD: NA
DATE OF CAPTURE: NA
MAIN ROADS PROJECT ZONE: LCG94
HEIGHT DATUM: AHD

Cardno Limited
All Rights Reserved.
This document is produced by Cardno Limited solely for the benefit of and use by the client.
Cardno Limited does not and shall not assume any responsibility or liability whatsoever to any third party arising out of any use or reliance by third party on the content of this document.

Cardno (WA) Pty Ltd (ABN 77 000 119 000)
11 Harvest Terrace
West Perth WA 6005
Tel: 08 9273 3888 Fax: 08 9486 8664
Web: www.cardno.com.au

DESIGNED/DRAWN
A.PEARCE / A.PEARCE
VERIFIED
M.WANSBROUGH
DIRECTOR
R.AKROUSH
APPROVED (MRWA)
MRWA FILE No.



CENTRAL AND NORTHERN REGIONS DIRECTORATE
MID WEST-GASCOYNE REGION
Eastward Road
Telephone (08) 9956 1200



Bunbury 4231
Fax (08) 9724 5656



Photo A1 Hunter Road - Facing East toward Brand Highway



Photo A2 Hunter Road - Facing East toward Brand Highway - East Lane



Photo A3 Hunter Road - Facing West off Brand Highway - West Lane Hunter Road



Photo A4 Hunter Road - Facing West off Brand Highway - East Lane Hunter Road



Photo A5 Brand Highway - South Lane Facing South



Photo A6 Brand Highway - South Lane Facing North



Photo A7 Brand Highway - North Lane Facing South



Photo A8 Brand Highway - North Lane Facing North