

# Plan 178/5

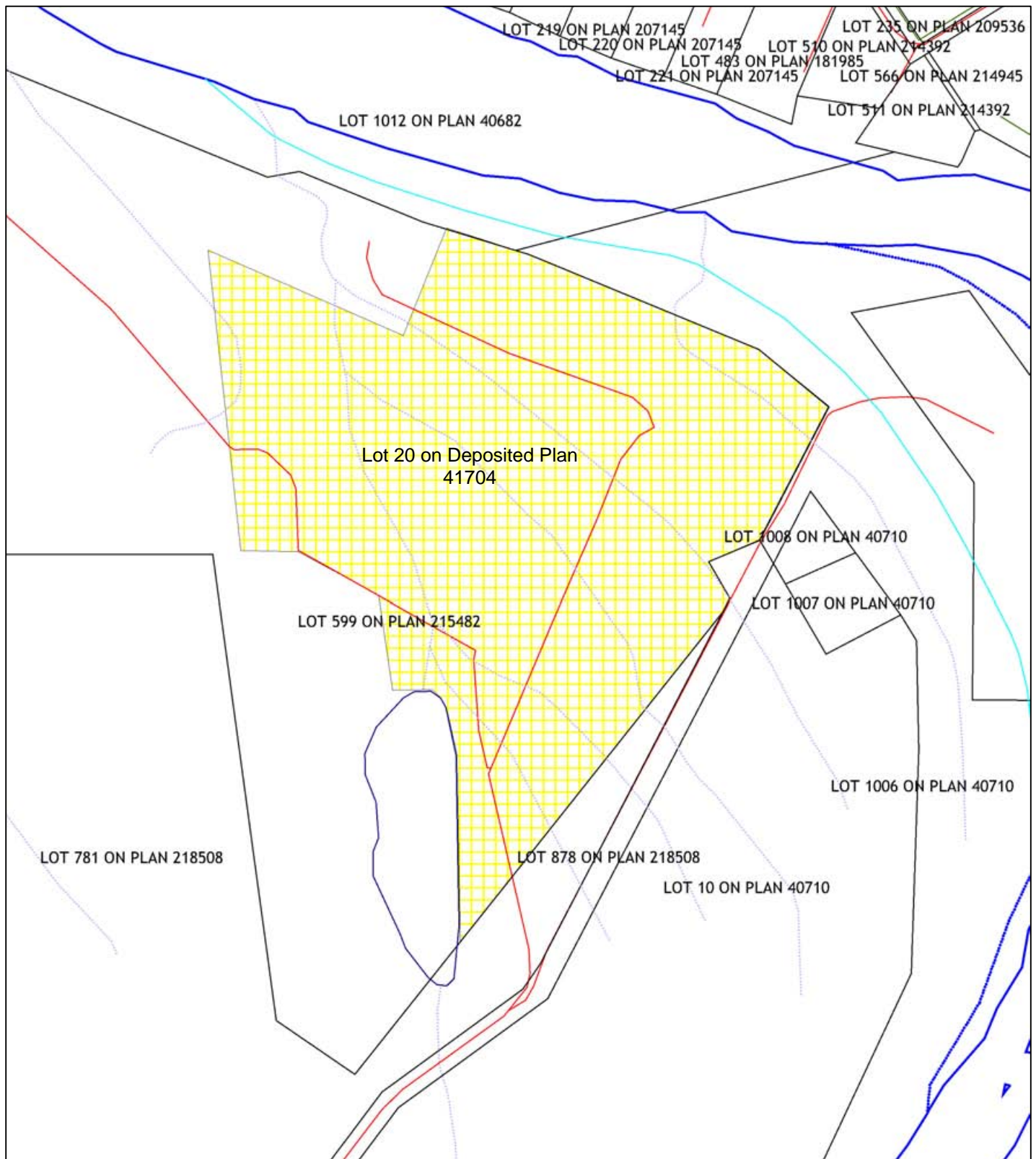

## LEGEND

— Road Centrelines - DLI 1/5/04

□ Cadastre - DLI 1/09/04

Hydrography, linear - DOE  
1/2/04

Area Subject to Inundation

Braided Stream Area

Claypan

Coastal Waterline

Dam Wall

Dam Wall - carrying road

Drain - major

Drain - minor

(cont)

Earth Dam

Estuarine

Flood Limit Area

Flow Direction Arrow

Foreshore Flats or Sandbank

Groyne Area

Lake - artificial

Lake - non-perennial

Lake - perennial

Levee Bank

Marine Construction - wharf/jetty

Marsh Area

Natural Pool - non-perennial

Natural Pool - perennial

(cont)

Reef Area

Rock Awash Offshore

Sump

Supply Channel

Swamp - non-perennial

Swamp - perennial

Tidal Flat

Wash Area

Water Reservoir

Watercourse - indefinite

Watercourse - major, non-perennial

Watercourse - major, perennial

Watercourse - minor, non-perennial

Watercourse - minor, perennial

(cont)

Watercourse Bank - non-perennial

Watercourse Bank - perennial

Waterfalls

Clearing Instruments<sup>1</sup>

Areas Approved to Clear



0 ————— 250 m

Scale 1:10000

(Approximate when reproduced at A4)

Geocentric Datum Australia 1994

Note: the data in this map have not been projected. This may result in geometric distortion or measurement inaccuracies.

..... Date .....

Derek Carew-Hopkins

Chief Executive Officer, Department of Environment

Information derived from this map should be confirmed with the data custodian acknowledged by the agency acronym in the legend.