



## **CLEARING PERMIT**

*Granted under section 51E of the Environmental Protection Act 1986*

### **PERMIT DETAILS**

Purpose Permit Number: 233 / 1

File Number: 19235

Duration of Permit: From 8 April 2005 to 8 April 2010

### **PERMIT HOLDER**

Jabiru Metals Ltd

### **LAND ON WHICH CLEARING IS TO BE DONE**

M37/44

M37/1153

M37/1132

### **AUTHORISED ACTIVITY**

1. Clearing of up to 242 hectares of native vegetation within the area cross-hatched yellow on attached Plan 233/1a.
2. Clearing of up to 15.4 hectares of native vegetation within the area cross-hatched yellow on attached Plan 233/1b.

### **CONDITIONS**

1. Nil.

A handwritten signature in blue ink, appearing to read "Derek Carew-Hopkins".

---

Derek Carew-Hopkins

Chief Executive Officer, Department of Environment.  
18 March 2005

# Plan 233/1 a

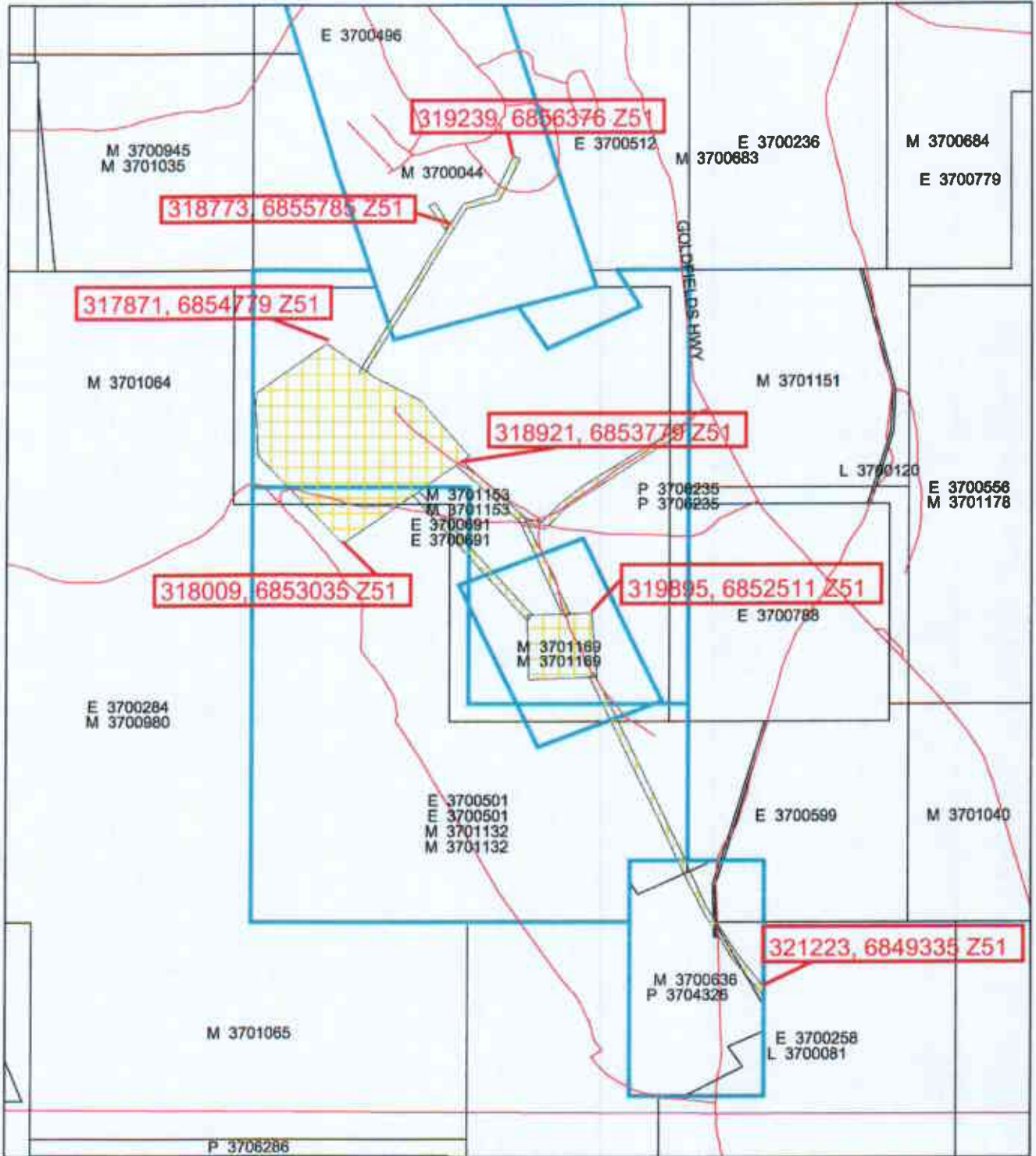

## LEGEND

- Mining Tenements - DOIR 1/89/03
- Road Centrelines - DLI 1/8/04
- Land parcels related to instrument
- Cadastre - DLI 1/89/04
- Clearing Instruments**
- Areas Approved to Clear



Geocentric Datum Australia 1994

Note: the data in this map have not been projected. This may result in geometric distortion or measurement inaccuracies.

*Handwritten signature and date: 12/5/05*  
Date 12/5/05

Derek Carew Hopkins  
Chief Executive Officer of the Department of Environment

Information derived from this map should be confirmed with the data custodian acknowledged by the agency acronym in the legend.



# Plan 233/1 b

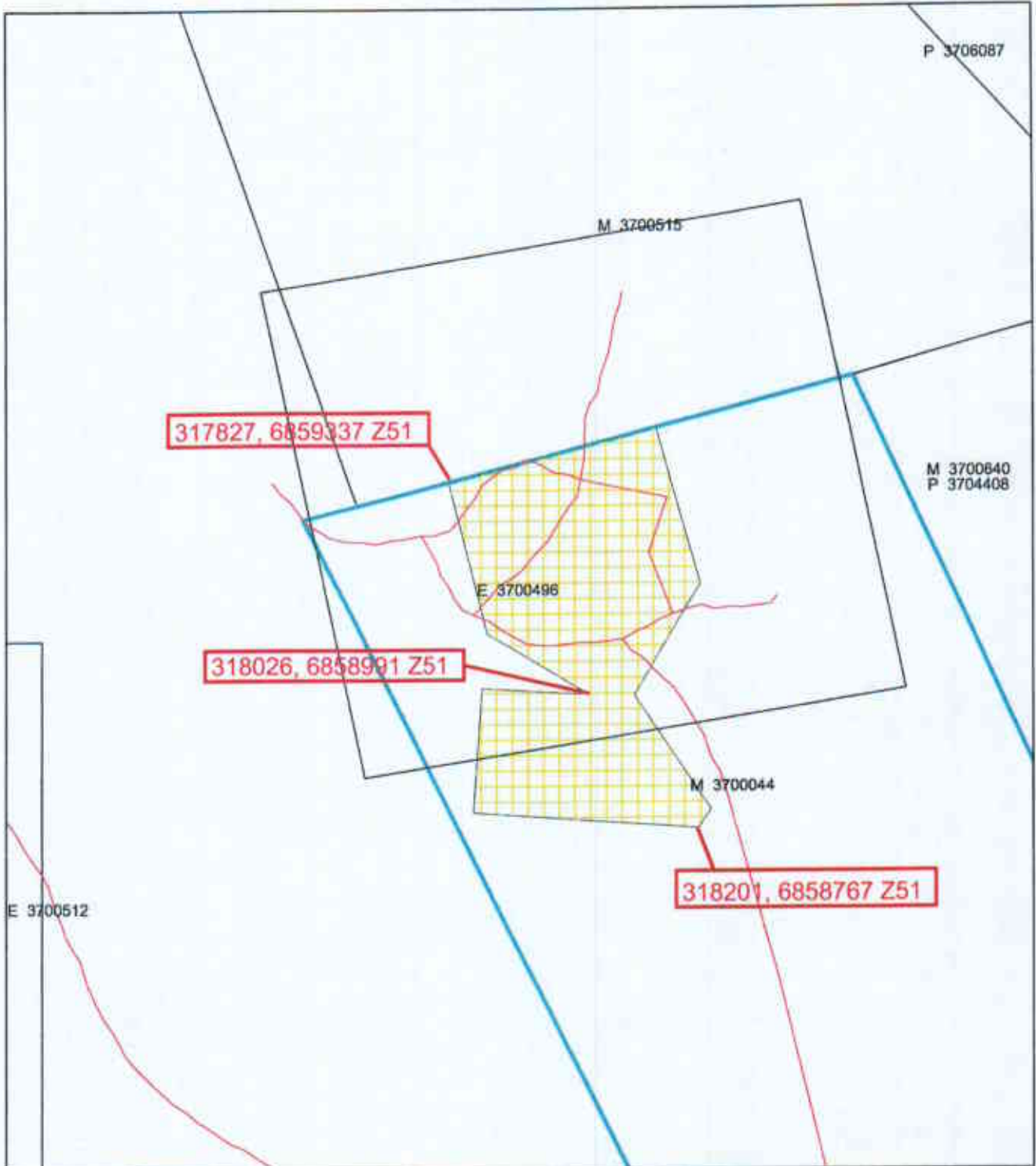

## LEGEND

- Mining Tenements - DOIR 1/09/03
- Road Centrelines - DLI 1/8/04
- Land parcels related to instrument
- Cadastra - DLI 1/09/04
- Clearing Instruments**
- Areas Approved to Clear



Scale 1:9000  
(Approximate when reproduced at A4)

Geocentric Datum Australia 1994

*Note: the data in this map have not been projected. This may result in geometric distortion or measurement inaccuracies.*

*Derek Carraw Hopkins* Date 18/3/05  
Derek Carraw Hopkins

Chief Executive Officer of the Department of Environment

Information derived from this map should be confirmed with the data custodian acknowledged by the agency acronym in the legend.



Government of Western Australia  
WA Crown Copyright 2005