



CLEARING PERMIT

Granted under section 51E of the Environmental Protection Act 1986

Purpose permit number:	CPS 2426/2
Permit holder:	Dioro Exploration NL
Purpose of clearing:	Mineral Exploration
Shire:	City of Kalgoorlie-Boulder Shire of Coolgardie
Duration of permit:	29 June 2008 – 29 June 2025

TABLE OF CONTENTS

1. LAND ON WHICH CLEARING IS TO BE DONE.....	2
2. AREA OF CLEARING	2
3. APPLICATION	2
4. COMPLIANCE WITH ASSESSMENT SEQUENCE AND MANAGEMENT PROCEDURES	2
5. AVOID, MINIMISE ETC CLEARING.....	2
6. FAUNA MANAGEMENT	2
7. REVEGETATION.....	3
8. WEED CONTROL.....	3
9. RECORDS MUST BE KEPT	3
10. REPORTING	4
DEFINITIONS.....	4

Purpose permit number:	CPS 2426/2
Permit holder:	Dioro Exploration NL
Purpose of clearing:	Mineral Exploration
Shire:	City of Kalgoorlie-Boulder Shire of Coolgardie
Duration of permit:	29 June 2008 – 29 June 2025

The permit holder is authorised to clear native vegetation for the above stated purposes, subject to the conditions of this Permit.

PART I – CLEARING AUTHORISED

1. Land on which clearing is to be done

Lot 51 on Plan 226303

2. Area of clearing

The Permit holder must not clear more than 60 hectares within the area cross-hatched yellow on attached Plan 2426/2.

3. Application

This Permit allows the Permit holder to authorise persons, including employees, contractors and agents of the Permit holder, to clear native vegetation for the purposes of this Permit subject to compliance with the conditions of this Permit and approval from the Permit holder.

4. Compliance with Assessment Sequence and Management Procedures

Prior to clearing any native vegetation under conditions 1 and 2 of this Permit, the Permit holder must comply with the Assessment Sequence and the Management Procedures set out in Part II of this Permit.

PART II – ASSESSMENT SEQUENCE AND MANAGEMENT PROCEDURES

5. Avoid, minimise etc clearing

(a) In determining the amount of native vegetation to be cleared for the purposes of mineral exploration the Permit holder must have regard to the following principles, set out in order of preference:

- (i) avoid the clearing of native vegetation;
- (ii) minimise the amount of native vegetation to be cleared; and
- (iii) reduce the impact of clearing on any environmental value.

6. Fauna Management

(a) Prior to clearing, the site shall be walked, inspected and surveyed by a *fauna specialist* to identify the presence of Malleefowl (*Leipoa ocellata*) mounds.

(b) The Permit holder shall not clear within 50m of Malleefowl (*Leipoa ocellata*) mounds identified in condition 6(a) above.

7. Revegetation

The Permit holder must *revegetate* all areas cleared for the purpose of exploration and prospecting in accordance with the following:

- (a) The Permit holder shall retain the vegetative material and topsoil removed by clearing in accordance with this Permit;
- (b) Within six months of the area no longer being required for the purpose of the exploration and prospecting the Permit holder must *revegetate* the area by:
 - (i) Deep ripping the soil of any area to be rehabilitated;
 - (ii) Laying topsoil retained in accordance with condition 7(a) on the area;
- (c) Within one year of undertaking *revegetation* in accordance with condition 7(b), the Permit holder must:
 - (i) Determine the species composition, structure and density of the area *revegetated*;
 - (ii) Where, in the opinion of an *flora specialist*, the composition structure and density determined under condition 7(c)(i) will not result in a similar species composition, structure and density to pre-clearing vegetation types in that area the Permit holder must undertake planting or seeding of native vegetation; and
 - (iii) Propagative material must be sourced from within 50km of the area to be *revegetated*.

8. Weed Control

- (a) When undertaking any clearing and *revegetation*, or other activity pursuant to this Permit the Permit holder must take the following steps to minimise the risk of the introduction and spread of *weeds*:
 - (i) clean earth-moving machinery of soil and vegetation prior to entering and leaving the area to be cleared;
 - (ii) ensure that no *weed-affected mulch, fill* or other material is brought into the area to be cleared; and
 - (iii) restrict the movement of machines and other vehicles to the limits of the areas to be cleared.

PART III – RECORD KEEPING AND REPORTING

9. Records must be kept

The Permit holder must maintain the following records for activities done pursuant to this Permit, as relevant:

- (a) In relation to the clearing of native vegetation undertaken pursuant to the purpose of clearing:
 - (i) the location where the clearing occurred, recorded using Geocentric Datum Australia 1994;
 - (ii) the date that the area was cleared; and
 - (iii) the size of the area cleared (in hectares).
- (b) In relation to fauna management pursuant to condition 6:
 - (i) The location of each Malleefowl mound in accordance with condition 6(a) recorded using Geocentric Datum Australia 1994.

(c) In relation to the *revegetation* of areas pursuant to conditions 7(b) and (c):

- (i) The location of any area *revegetated* recorded using Geocentric Datum Australia 1994;
- (ii) A description of the *revegetation* activities undertaken; and
- (iii) The size of the area *revegetated* (in hectares).

10. Reporting

The Permit holder must provide to the CEO, on or before 30 June of each year, a written report of records required under condition 9 and activities done by the Permit holder under this Permit between 1 January and 31 December of the preceding year.

DEFINITIONS

The following meanings are given to terms used in this Permit:

fauna specialist means a person with training and specific work experience in fauna identification or faunal assemblage surveys of Western Australian fauna.

fill means material used to increase the ground level, or fill a hollow

flora specialist means a person with specific training and/or experience in the ecology and taxonomy of Western Australian flora;

mulch means the use of organic matter, wood chips or rocks to slow the movement of water across the soil surface and to reduce evaporation.

revegetate, revegetated and revegetation means the re-establishment of a cover of native vegetation in an area such that the species composition, structure and density is similar to pre-clearing vegetation types in that area, and can involve regeneration, direct seeding and/or planting.

weed/s means any plant -

- (a) that is a declared pest under section 22 of the *Biosecurity and Agriculture Management Act 2007*;
or
- (b) published in the Department of Environment and Conservation Regional Weed Assessments, regardless of ranking; or
- (c) not indigenous to the area concerned.



M Warnock
MANAGER
NATIVE VEGETATION CONSERVATION BRANCH

*Officer delegated under Section 20
of the Environmental Protection Act 1986*

30 May 2013

Plan 2426/2

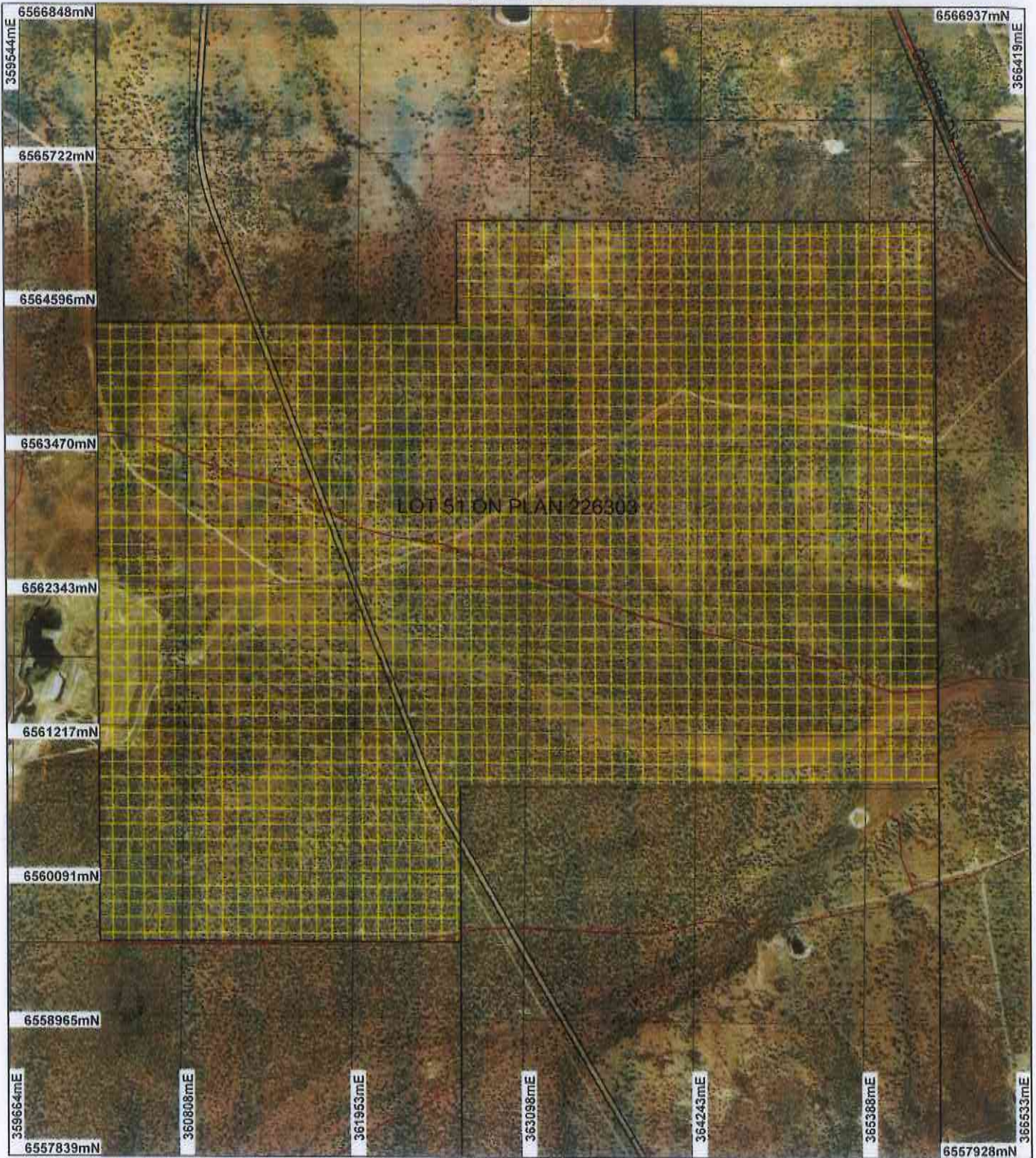

LEGEND

- Clearing Instruments**
- Areas Approved to Clear
 - Road Centrelines
 - Cadastre
 - Cadastre for Labelling

Lake Lefroy 1.4m Orthomosaic
- DLI 02



Scale 1:40000

(Approximate when reproduced at A4)

Geocentric Datum Australia 1994

Note: the data in this map have not been projected. This may result in geometric distortion or measurement inaccuracies.

approved Date *30/5/13*

M. Warlock

Officer with delegated authority under Section 20 of the Environmental Protection Act 1986

Information derived from this map should be confirmed with the data custodian acknowledged by the agency acronym in the legend.



Department of Environment and Conservation

WA Crown Copyright 2002



1. Application details

1.1. Permit application details

Permit application No.: 2426/2
Permit type: Purpose Permit

1.2. Proponent details

Proponent's name: HBJ Minerals Pty Ltd

1.3. Property details

Property: LOT 51 ON PLAN 226303 (FEYSVILLE 6431)
Local Government Area: Shire of Kalgoorlie - Boulder

1.4. Application

Clearing Area (ha)	No. Trees	Method of Clearing	For the purpose of:
60		Mechanical Removal	Mineral Exploration

1.5. Decision on application

Decision on Permit Application: Grant
Decision Date: 30 May 2013

2. Site Information

2.1. Existing environment and information

2.1.1. Description of the native vegetation under application

Vegetation Description	Clearing Description	Vegetation Condition	Comment
Beard vegetation types: 9: Medium woodland; coral gum (E. torquata) & Goldfields blackbutt (E. lesouefi).	The area under application is for clearing of 60 ha for exploration within a 2,592 ha project area (Lot 51). The area is located approximately 35km south south-east of the Kalgoorlie-Boulder town site.	Very Good: Vegetation structure altered; obvious signs of disturbance (Keighery 1994)	The condition of the vegetation was determined via digital imagery.
468: Medium woodland; salmon gum & Goldfields blackbutt. (Shepherd et al., 2001)	The vegetation within the area in which clearing is to occur consists of nine different vegetation habitat types. The area predominantly comprises habitat type 2.2: Eucalypt woodlands with sclerophyll understorey on deep alluvial clays and loams.		

3. Assessment of application against clearing principles

Comments

This amendment has been made to extend the duration of the permit until 29 June 2025.

The assessment against the clearing principles has not changed and can be found in Clearing Permit Decision Report CPS 2426/1.

Methodology

Planning instrument, Native Title, Previous EPA decision or other matter.

Comments

The assessment against Planning Instruments and other matters has not changed and can be found in Clearing Permit Decision Report CPS 2426/1.

Methodology

4. References

- Keighery, B.J. (1994) Bushland Plant Survey: A Guide to Plant Community Survey for the Community. Wildflower Society of WA (Inc). Nedlands, Western Australia.
- Shepherd, D.P., Beeston, G.R., and Hopkins, A.J.M. (2001), Native Vegetation in Western Australia. Technical Report 249. Department of Agriculture Western Australia, South Perth.

5. Glossary

Term	Meaning
DEC	Department of Environment and Conservation
DRF	Declared Rare Flora
GIS	Geographical Information System
ha	Hectare (10,000 square metres)