

2011/00057

	Department of Environment and Conservation - Department of Mines and Petroleum Application for a clearing permit (area permit) <i>Environmental Protection Act 1986 s 51E</i> FORM C1 Clearing of native vegetation is prohibited in Western Australia except where a clearing permit has been granted or an exemption applies. A person who causes or allows unauthorised clearing commits an offence.	CPS No. DEPARTMENT OF ENVIRONMENT & CONSERVATION 06 JAN 2011 Corporate Information Section KENNEDY
---	---	--

Part 1 Land details	
The location of the land where clearing is proposed must be accurately described.	Land description: Volume and Folio number, Lot or location number(s), Crown Lease or Reserve number, Pastoral Lease number or Mining Tenement number for all properties where clearing is proposed. FOLIO 511 TITLE VOLUME 1238 Street address BINGHAM ROAD LOT 2064. MUCHEA. Local government area CHITTERING. Land zoning, e.g. rural, residential, industrial RURAL RESOURCES
FILE REFERENCE	

Part 2 Proposal	
An aerial photograph or map with a north arrow must be attached, clearly showing the area proposed to be cleared. or If you have the facilities, a digital map on CDROM of the area to clear in one of the following formats: 1. ESRI Shapefile with the following properties: • Geometry Type: Polygon shape. • Coordinate System: GDA 1994 (Geographic latitude/longitude). • Datum: GDA 1994 (Geocentric Datum of Australia 1994). 2. Autocad 2000 or earlier; or 3. Microstation 8 or earlier.	Total area of clearing proposed (Hectares) and/or number of individual trees to be removed 17 HECTARES BANKSIA MANY DEAD TREES. Proposed method of clearing FRONT END LOADER Period within which clearing is proposed to be undertaken, e.g. May 2010 – June 2010 JAN - MARCH. Purpose of clearing PASTURE + OLIVE TREES. PLEASE NOTE ALL GUM TREES WILL BE RETAINED AS MUCH AS POSSIBLE.

Part 3 Applicant	
To apply for a permit you must either be: • the landowner; • acting on the landowner's behalf; or • likely to become the landowner. Note: If you are acting on behalf of the landowner, you must attach a letter of authority from the landowner explicitly stating that you, the applicant, has authority to clear on the said land.	Are you applying as an individual, a company or an incorporated body? – Enter details for one only. (Please print) An individual - Applicant's given names, family name and title (Mr, Mrs, Ms, etc) GIUSEPPE + PAMELA MARGARET ROCCA. A company or incorporated body name (Note: companies must supply an Australian Company Number - ACN)

Ownership of Land If granted, the permit will be issued in the name of the landowner (or applicant if acting on behalf of the landowner). A landowner can be: • A person who holds the Certificate of Title; • A person who is the lessee of Crown land, or • A public authority that is responsible for care of the land.	Full name of all landowners as they appear on the Certificate of Title (Please print) (1) PAMELA MARGARET ROCCA (2) GIUSEPPE ROCCA. If more than one Certificate of Title, please include details on a separate sheet.
--	---

<p>Relationship to landowner</p> <p>Please indicate your relationship to the landowner.</p> <p>If you are likely to become the landowner, please attach evidence of the pending transfer of ownership, contract of sale ('offer and acceptance') or letter from current landowner.</p>	<p>I am (tick applicable box)</p> <p><input checked="" type="checkbox"/> the owner of the land; or</p> <p><input type="checkbox"/> acting on behalf of the owner and have attached an agent's authority, expressly authorising me to act on behalf of the landowner; or</p> <p><input type="checkbox"/> likely to become the owner of the land (Please provide copy of 'Offer and Acceptance')</p>										
<p>Contact details</p> <p>Person with whom Department of Environment and Conservation or Department of Mines and Petroleum should liaise concerning the clearing application.</p> <p>*If applying as a company or incorporated body, please also supply the registered business office address.</p>	<p>Given name, Family name and title (Mr, Mrs, Ms, etc) (Please print)</p> <table border="1"> <tr> <td>MR GIUSEPPE ROCCA</td> <td>OWNER</td> </tr> <tr> <td>MRS PAMELA ROCCA</td> <td>OWNER</td> </tr> </table> <p>Position (Director, Secretary, Consultant etc)</p> <p>Postal / Business address*</p> <p>Postal P.O BOX 298 WANNEROO 6946</p> <p>Business</p> <p>Fixed Telephone number 08 9 306-8133</p> <p>Mobile telephone number 0411185019</p> <p>Fax number 08 9 405-1799</p> <p>Email pam@rockandsoil.com</p>	MR GIUSEPPE ROCCA	OWNER	MRS PAMELA ROCCA	OWNER						
MR GIUSEPPE ROCCA	OWNER										
MRS PAMELA ROCCA	OWNER										
<p>Part 4 Declaration & Signature</p>											
<p>For your application to be accepted, it must be signed either on behalf of the company or as an individual.</p> <p>By signing this form you are declaring that the statements on this form are true and correct. Providing false or misleading information is an offence under s112 of the Environmental Protection Act 1986.</p>	<p>Please indicate if you are signing as an individual or a company or incorporated body:</p> <p><input checked="" type="checkbox"/> An individual. If an individual landowner is applying, all landowners must sign this form. or</p> <p><input type="checkbox"/> A company. A person duly authorised to sign for an on behalf of the incorporated body or company must sign this form. If your company is required to use a common seal, you must affix this seal and have this application signed by an authorised director(s) in accordance with the Corporations Law.</p> <p>Signature(s)</p> <table border="1"> <tr> <td>(1) * </td> <td>Date</td> </tr> <tr> <td>(2) </td> <td>4 JAN 2011</td> </tr> </table> <p>Print name(s)</p> <table border="1"> <tr> <td>(1) GIUSEPPE ROCCA.</td> <td rowspan="2">Common Seal (if used)</td> </tr> <tr> <td>(2) PAMELA ROCCA</td> </tr> </table> <p>Position</p> <table border="1"> <tr> <td>(1)</td> </tr> <tr> <td>(2)</td> </tr> </table> <p>Company Name and Australian Company Number</p> <table border="1"> <tr> <td></td> </tr> </table>	(1) *	Date	(2)	4 JAN 2011	(1) GIUSEPPE ROCCA.	Common Seal (if used)	(2) PAMELA ROCCA	(1)	(2)	
(1) *	Date										
(2)	4 JAN 2011										
(1) GIUSEPPE ROCCA.	Common Seal (if used)										
(2) PAMELA ROCCA											
(1)											
(2)											

A. T. M. 101

Part 5 Prescribed Fee

Make cheques or money payable to:

Department of Environment and Conservation for clearing purposes other than mining and petroleum activities

or
Department of Mines and Petroleum for mineral or petroleum clearing activities under the Mining Act, Petroleum Acts or Petroleum Agreement Acts.

Do not send cash in the mail



Part 6 Application checklist

Additional information to assist in the assessment of your proposal may be attached to this application – e.g. reports on salinity, fauna or flora studies or other environmental reports conducted for the site could be included in electronic format and submitted on CDROM.

Please ensure you have included the following as part of your application:

REQUIRED

- A completed application form that is signed and dated by all landowners, or the applicant acting on behalf of or likely to become the landowner.
- Payment.
- An aerial photograph or map with a north arrow clearly identifying the areas of vegetation proposed to be cleared.

IF APPLICABLE

- Copy of written authority to act on behalf of the landowner.
- Evidence of the pending transfer of landownership, such as the offer and acceptance, or written notice from the current landowner

Part 7 Lodgement

Send original applications for all clearing purposes (other than mining and petroleum activities) to:

Department of Environment and Conservation
Native Vegetation Conservation Branch
Locked Bag 104, Bentley Delivery Centre, BENTLEY WA 6983

Telephone: 9219 8744
For further information: www.dec.wa.gov.au/nvc, or Email: nvp@dec.wa.gov.au

Send original applications related to mining and petroleum clearing activities (under delegation) to:

Department of Mines and Petroleum
Native Vegetation Assessment Branch
Mineral House
100 Plain St EAST PERTH WA 6004

Telephone: 9222 3333
For further information: <http://www.dmp.wa.gov.au/nvabinfo>

Electronic versions or facsimiles of this application form are not acceptable. Please retain a copy of this form for your records. Incomplete applications will be returned.

IMPORTANT

Information submitted as part of this application may be made publicly available. If you wish to submit information that you believe to be commercially sensitive or otherwise confidential, then you should submit that information in an appendix to this application, with a written statement of reasons why you request that each item of information be kept confidential. The Department will take reasonable steps to protect confidential or commercially sensitive information. Please note in particular that all submitted information may be the subject of an application for release under the *Freedom of Information Act 1992*. If you have any enquiries regarding the provision of relevant information as part of this application contact either the Department of Environment and Conservation or the Department of Mines and Petroleum.

If there is insufficient room on any part of this form, please continue on a separate sheet of paper and attach to this form.



To see all the details that are visible on the screen, use the "Print" option in the "Share" menu.

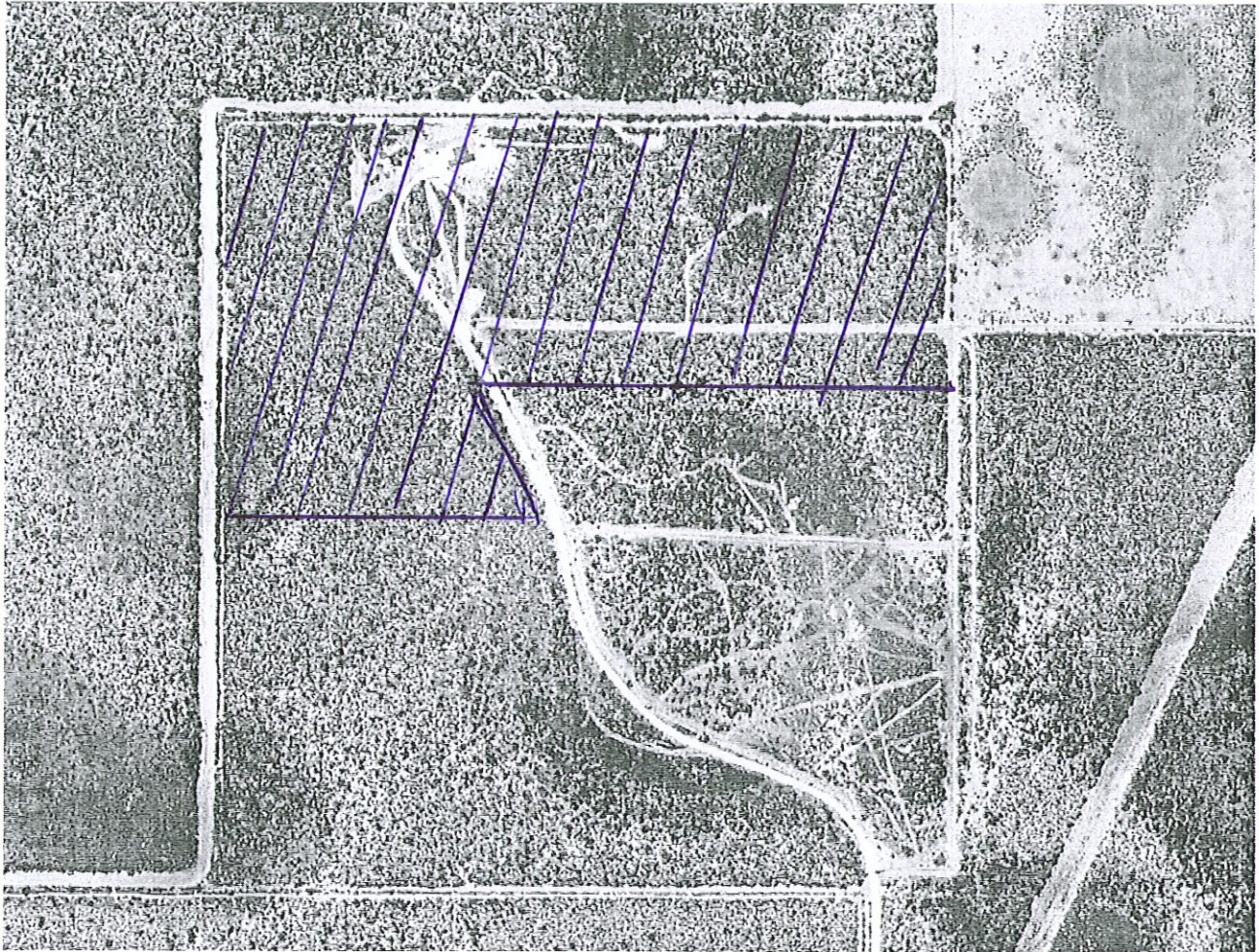

 HATCHED AREA TO BE CLEARED.