



CLEARING PERMIT

Granted under section 51E of the Environmental Protection Act 1986

Purpose Permit number:	CPS 4274/2
Permit Holder:	Regional Power Corporation TA Horizon Power
Duration of Permit:	2 May 2011 to 2 May 2013

The Permit Holder is authorised to clear native vegetation subject to the following conditions of this Permit.

1. Purpose for which clearing may be done

Clearing for the purpose of installing underground electricity cables.

2. Land on which clearing is to be done

Lot 85 on Deposited Plan 213679 (Derby 6728)
Derby Gibb River Road reserve, PIN 11434262 (Derby 6728)

3. Area of Clearing

The Permit Holder must not clear more than 0.867 hectares of native vegetation within the area hatched yellow on attached Plan 4274/2.

4. Application

This Permit allows the Permit Holder to authorise persons, including employees, contractors and agents of the Permit Holder, to clear native vegetation for the purposes of this Permit subject to compliance with the conditions of this Permit and approval from the Permit Holder.

5. Type of clearing authorised

This Permit authorises the Permit Holder to clear native vegetation for the *project activities* described in condition 1 of this Permit to the extent that the Permit Holder has the power to carry out works involving clearing for those *project activities* under *Energy Operators (Powers) Act 1970* or any other written law.

A handwritten signature in black ink, appearing to be "K. Faulkner", written over a horizontal line.

Kelly Faulkner

*Officer delegated under Section 20
of the Environmental Protection Act 1986*

26 April 2012

Plan 4274/2

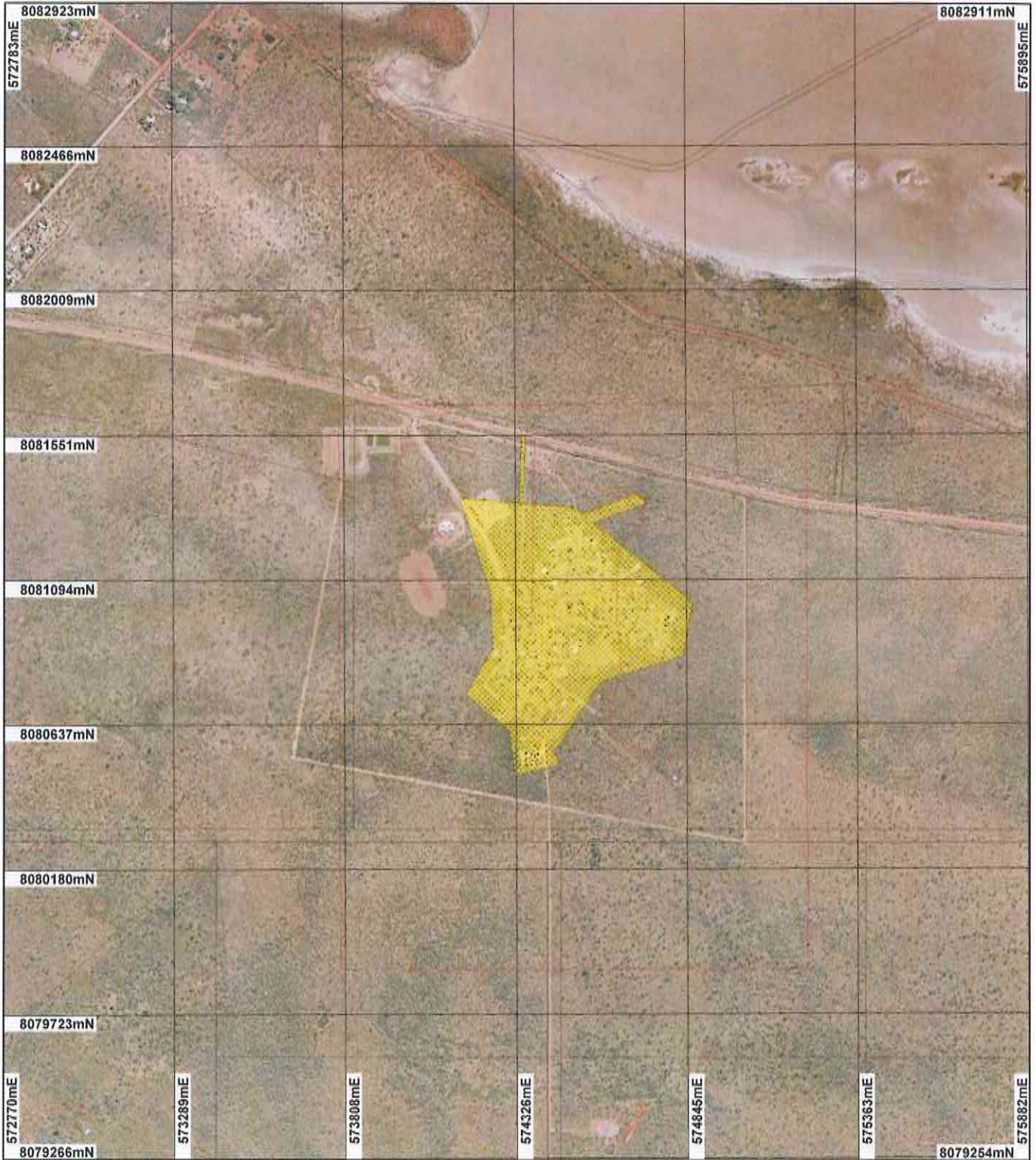

LEGEND

- | | |
|--|---|
| Clearing instruments | <input type="checkbox"/> Recently added |
| <input type="checkbox"/> Areas Approved to Clear | <input type="checkbox"/> Coverage |
| <input type="checkbox"/> Road Centrelines | Derby Townsite 20cm |
| <input type="checkbox"/> Cadastre | Orthomosaic - Landgate |
| <input type="checkbox"/> Image Index | 2007 |
| (cont) | |

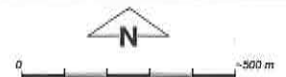

Scale 1:17003
(Approximate when reproduced at A4)

Geocentric Datum Australia 1994

Note: the data in this map have not been projected. This may result in geometric distortion or measurement inaccuracies.

[Signature] Date 26/4/12
K. Paulkner

Officer with delegated authority under Section 20 of the Environmental Protection Act 1986

Information derived from this map should be confirmed with the data custodian acknowledged by the agency acronym in the legend.



* Project Data. This data has not been quality assured. Please contact map author for details.



1. Application details

1.1. Permit application details

Permit application No.: 4274/2
Permit type: Purpose Permit

1.2. Proponent details

Proponent's name: Regional Power Corporation TA Horizon Power

1.3. Property details

Property: LOT 85 ON PLAN 213679 (DERBY 6728)
ROAD RESERVE (DERBY 6728)
Local Government Area: Shire of Derby West Kimberley
Colloquial name: Derby Gibb River Road

1.4. Application

Clearing Area (ha)	No. Trees	Method of Clearing	For the purpose of:
0.867		Mechanical Removal	Water/gas/cable/pipeline/power installation

1.5. Decision on application

Decision on Permit Application: Grant
Decision Date: 26 April 2012

2. Site Information

2.1. Existing environment and information

2.1.1. Description of the native vegetation under application

Vegetation Description	Clearing Description	Vegetation Condition	Comment
Beard Vegetation Association - 764: Shrublands, pindan; Acacia eriopoda & A. tumida shrubland with scattered low bloodwood & Eucalyptus setosa over ribbon & curly spinifex (Shepherd, 2009).	This application proposes to clear 0.867ha of native vegetation for the purpose of installing an underground electricity distribution network, using a small excavator and trenching techniques.	Good: Structure significantly altered by multiple disturbance; retains basic structure/ability to regenerate (Keighery 1994)	The condition of the vegetation was determined via digital imager (Derby Townsite 20cm Orthomosaic - Landgate 2007)
		To	
		Degraded: Structure severely disturbed; regeneration to good condition requires intensive management (Keighery 1994)	

3. Assessment of application against clearing principles

Comments

This amendment has been made to increase the proposed clearing area by 0.5ha and to include Derby Gibb River Road reserve to the permit.

The assessment against the clearing principles has not changed and can be found in Decision Report CPS 4274/1.

Methodology

Planning instrument, Native Title, Previous EPA decision or other matter.

Comments

Main Roads Western Australia has advised that they are aware of the nature and extent of the clearing within Derby Gibb River Road reserve and have no objections to the proposed clearing (MRWA, 2012).

Methodology

Reference:
MRWA (2012)

4. References

- Keighery, B.J. (1994) Bushland Plant Survey: A Guide to Plant Community Survey for the Community. Wildflower Society of WA (Inc). Nedlands, Western Australia.
- MRWA (2012) Letter providing authority for Horizon Power to apply for a clearing permit within Derby Gibb River Road reserve. Main Roads Western Australia (DEC Ref: A495460).
- Shepherd, D.P. (2009) Adapted from: Shepherd, D.P., Beeston, G.R., and Hopkins, A.J.M. (2001), Native Vegetation in Western Australia. Technical Report 249. Department of Agriculture Western Australia, South Perth.

5. Glossary

Term	Meaning
BCS	Biodiversity Coordination Section of DEC
CALM	Department of Conservation and Land Management (now BCS)
DAFWA	Department of Agriculture and Food
DEC	Department of Environment and Conservation
DEP	Department of Environmental Protection (now DEC)
DoE	Department of Environment
DoIR	Department of Industry and Resources
DRF	Declared Rare Flora
EPP	Environmental Protection Policy
GIS	Geographical Information System
ha	Hectare (10,000 square metres)
TEC	Threatened Ecological Community
WRC	Water and Rivers Commission (now DEC)