



## CLEARING PERMIT

*Granted under section 51E of the Environmental Protection Act 1986*

<b>Purpose Permit number:</b>	CPS 4565/1
<b>Permit Holder:</b>	Shire of Murray
<b>Duration of Permit:</b>	14 November 2011– 14 November 2016

The Permit Holder is authorised to clear native vegetation subject to the following conditions of this Permit.

### PART I – CLEARING AUTHORISED

**1. Purpose for which clearing may be done**

Clearing for the purpose of road construction.

**2. Land on which clearing is to be done**

Lot 2297 on Deposited Plan 210749 (WHITTAKER 6207)  
State Forest 14 (BANKSIADALE 6213)

**3. Area of Clearing**

The Permit Holder must not clear more than 0.1 hectares of native vegetation within the area hatched yellow on attached Plan 4565/1.

**4. Application**

This Permit allows the Permit Holder to authorise persons, including employees, contractors and agents of the Permit Holder, to clear native vegetation for the purposes of this Permit subject to compliance with the conditions of this Permit and approval from the Permit Holder.

**5. Type of clearing authorised**

This Permit authorises the Permit Holder to clear native vegetation for activities to the extent that the Permit Holder has the power to clear native vegetation for those activities under the *Local Government Act 1995* or any other written law.

**6. Compliance with Assessment Sequence and Management Procedures**

Prior to clearing any native vegetation under conditions 1, 2 and 3 of this Permit, the Permit Holder must comply with the Assessment Sequence and the Management Procedures set out in Part II of this Permit.

### PART II – ASSESSMENT SEQUENCE AND MANAGEMENT PROCEDURES

**7. Avoid, minimise etc clearing**

In determining the amount of native vegetation to be cleared authorised under this Permit, the Permit Holder must have regard to the following principles, set out in order of preference:

- avoid the clearing of native vegetation;
- minimise the amount of native vegetation to be cleared; and
- reduce the impact of clearing on any environmental value.

## 8. Dieback and weed control

- (a) When undertaking any clearing or other activity authorised under this Permit, the Permit Holder must take the following steps to minimise the risk of the introduction and spread of *weeds* and *dieback*:
- (i) clean earth-moving machinery of soil and vegetation prior to entering and leaving the area to be cleared;
  - (ii) shall only move soils in *dry conditions*;
  - (iii) ensure that no *dieback* or *weed*-affected soil, *mulch*, *fill* or other material is brought into the area to be cleared; and
  - (iv) restrict the movement of machines and other vehicles to the limits of the areas to be cleared.
- (b) At least once in each 12 month period for the term of this Permit, the Permit Holder must remove or kill any *weeds* growing within areas cleared under this Permit.

## Definitions

The following meanings are given to terms used in this Permit:

*dieback* means the effect of *Phytophthora* species on native vegetation;

*dry conditions* means when soils (not dust) do not freely adhere to rubber tyres, tracks, vehicle chassis or wheel arches;

*fill* means material used to increase the ground level, or fill a hollow;

*mulch* means the use of organic matter, wood chips or rocks to slow the movement of water across the soil surface and to reduce evaporation; and

*weed/s* means a species listed in Appendix 3 of the "Environmental Weed Strategy" published by the Department of Conservation and Land Management (1999), and plants declared under section 37 of the *Agriculture and Related Resources Protection Act 1976*.



Kelly Faulkner  
MANAGER  
NATIVE VEGETATION CONSERVATION BRANCH

*Officer delegated under Section 20  
of the Environmental Protection Act 1986*

20 October 2011

# Plan 4565/1

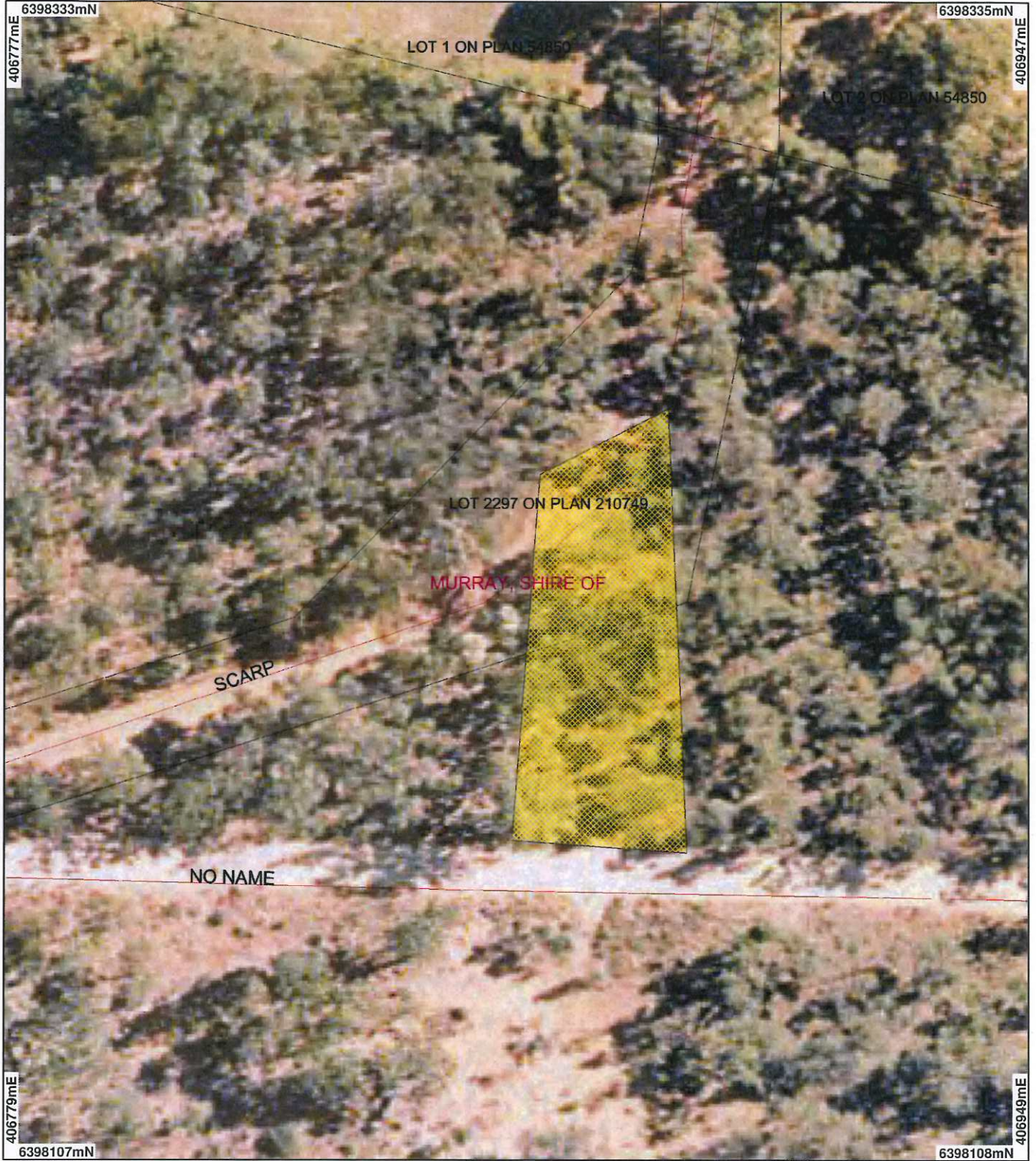

## LEGEND

- Dwellingup 50cm Orthomosaic - Landgate 2006
- Local Government Authorities
- Road Centrelines
- Cadastre Clearing Instruments
- Areas Approved to Clear

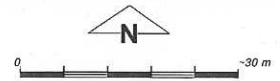

Scale 1:1000  
 (Approximate when reproduced at A4)  
 Geocentric Datum Australia 1994

Note: the data in this map have not been projected. This may result in geometric distortion or measurement inaccuracies.

*[Signature]* Date 26/10/11  
 K. Faulkner

Officer with delegated authority under Section 20 of the Environmental Protection Act 1986

Information derived from this map should be confirmed with the data custodian acknowledged by the agency acronym in the legend.



Department of Environment and Conservation

Our environment, our future  
 WA Crown Copyright 2002



## 1. Application details

### 1.1. Permit application details

Permit application No.: 4565/1  
Permit type: Purpose Permit

### 1.2. Proponent details

Proponent's name: Shire of Murray

### 1.3. Property details

Property: LOT 2297 ON PLAN 210749 (WHITTAKER 6207)  
STATE FOREST 14 (BANKSIADALE 6213)

Local Government Area: Shire of Murray

Colloquial name: Scarp Road

### 1.4. Application

Clearing Area (ha)	No. Trees	Method of Clearing	For the purpose of:
0.1		Mechanical Removal	Road construction or maintenance

### 1.5. Decision on application

Decision on Permit Application: GRANT  
Decision Date: 20 October 2011

## 2. Site Information

### 2.1. Existing environment and information

#### 2.1.1. Description of the native vegetation under application

Vegetation Description	Clearing Description	Vegetation Condition	Comment
Beard Vegetation Association: 3 - Medium forest; jarrah-marri (Shepherd, 2009)	The Shire of Murray has applied to clear 0.1 hectares of native vegetation within State Forest 14 and Lot 2297 on Deposited Plan 210749 for the purpose of road realignment to improve safety.	Good: Structure significantly altered by multiple disturbance; retains basic structure/ability to regenerate (Keighery, 1994)	Vegetation condition was determined by aerial imagery (Pinjarra 50cm Orthomosaic - Landgate 2006).
Mattiske Vegetation Complex: My1 (Murray 1) - Open forest of Eucalyptus marginata subsp. marginata-Corymbia calophylla-Eucalyptus patens on valley slopes to woodland of fs24 Eucalyptus rudis-Melaleuca raphiophylla on the valley floors in humid and subhumid zones. (Mattiske and Havel, 1998)	The vegetation proposed to be cleared is located between two existing roads and is likely to be exposed to increased levels of disturbance, such as edge effects associated with these cleared, trafficable areas.	To  Very Good: Vegetation structure altered; obvious signs of disturbance (Keighery, 1994)	

## 3. Assessment of application against clearing principles

### Comments

The application is to clear up to 0.1 hectare of native vegetation within State Forest 14, Banksiadale, and Lot 2297 on Deposited Plan 210749, Whittaker (also reserved as State Forest 14), for the purpose of road realignment to improve safety at the intersection of Scarp and Whittakers Roads. The road design will be changed from the current Y-intersection to that of a T-intersection and will involve the construction of an approximately 50-60 metre length of road.

The proposed clearing is small in scale, linear in shape and is located within a highly vegetated area. The vegetation under application is located between two existing roads and is likely to be exposed to increased levels of disturbance, such as edge effects associated with these cleared, trafficable areas.

The proposed clearing is unlikely to impact flora or fauna of conservation significance, result in appreciable land degradation or degrade surface or groundwater quality.

There are no known records of threatened ecological communities within the local area (10 kilometre radius).

Soil disturbance and removal of native vegetation increases the risk of weeds and pathogens, such as dieback (*Phytophthora cinnamomi*), being introduced or spread. The management of weeds and dieback is of particular importance, as the proposed clearing is within a high rainfall (1100 millimetres) and conservation significant area (State Forest). Weed and dieback management conditions will minimise the risk of introduction or spread of pathogens and invasive species into the surrounding state forest.

Considering the above, the proposed clearing may be at variance to principle (h) and is not likely to be at variance to the remaining clearing principles.

**Methodology** GIS Databases:  
- DEC Managed Lands & Waters - DEC 28/10/09  
- Pinjarra 50cm Orthomosaic - Landgate 2006  
- Rainfall, Mean Annual - BOM 30/09/01  
- SAC Biodatasets - 05/10/11

#### **Planning instrument, Native Title, Previous EPA decision or other matter.**

##### **Comments**

The vegetation under application is within State Forest 14. Written authorisation to access the land and conduct the proposed clearing was received from the Department of Environment and Conservation's (DEC) Perth Hills District Manager on 30 August 2011 (DEC, 2011).

The Shire of Murray advised that approximately 140 metres of the existing road will be closed and rehabilitated. DEC supports this action, as it will prevent vegetation in the area becoming fragmented.

There are no known Aboriginal Sites of Significance within the application area.

**Methodology** References:  
DEC, 2011  
GIS Databases:  
- Aboriginal Sites of Significance - DIA 02/10  
- DEC Managed Lands & Waters - DEC 28/10/09

#### **4. References**

- DEC (2011) Perth Hills District Approval to the Shire of Murray for the Clearing of Vegetation, 30 August 2011. Department of Environment and Conservation, Western Australia. DEC Ref: A426594
- Keighery, B.J. (1994) Bushland Plant Survey: A Guide to Plant Community Survey for the Community. Wildflower Society of WA (Inc). Nedlands, Western Australia.
- Mattiske, E.M. and Havel, J.J. (1998) Vegetation Complexes of the South-west Forest Region of Western Australia. Maps and report prepared as part of the Regional Forest Agreement, Western Australia for the Department of Conservation and Land Management and Environment Australia.
- Shepherd, D.P. (2009) Adapted from: Shepherd, D.P., Beeston, G.R., and Hopkins, A.J.M. (2001), Native Vegetation in Western Australia. Technical Report 249. Department of Agriculture Western Australia, South Perth.

#### **5. Glossary**

Term	Meaning
BCS	Biodiversity Coordination Section of DEC
CALM	Department of Conservation and Land Management (now BCS)
DAFWA	Department of Agriculture and Food
DEC	Department of Environment and Conservation
DEP	Department of Environmental Protection (now DEC)
DoE	Department of Environment
DoIR	Department of Industry and Resources
DRF	Declared Rare Flora
EPP	Environmental Protection Policy
GIS	Geographical Information System
ha	Hectare (10,000 square metres)
TEC	Threatened Ecological Community
WRC	Water and Rivers Commission (now DEC)