



## CLEARING PERMIT

*Granted under section 51E of the Environmental Protection Act 1986*

<b>Purpose Permit number:</b>	CPS 4910/1
<b>Permit Holder:</b>	Annabelle Coppin
<b>Duration of Permit:</b>	25 May 2012- 25 May 2017

The Permit Holder is authorised to clear native vegetation subject to the following conditions of this Permit.

**1. Purpose for which clearing may be done**

Clearing for the purpose of a Carbon Storage Project and fencelines.

**2. Land on which clearing is to be done**

Lot 50 on Deposited Plan 238018, Marble Bar (Pardu Location 50)

**3. Area of Clearing**

The Permit Holder must not clear more than 5 hectares of native vegetation within the area shaded yellow on attached Plan 4910/1.

**4. Application**

This Permit allows the Permit Holder to authorise persons, including employees, contractors and agents of the Permit Holder, to clear native vegetation for the purposes of this Permit subject to compliance with the conditions of this Permit and approval from the Permit Holder.

**5. Type of clearing authorised**

This Permit authorises the Permit Holder to clear native vegetation for activities to the extent that the Permit Holder has the right to access land under the *Land Administration Act 1997* or any other written law.

Kelly Faulkner  
MANAGER  
NATIVE VEGETATION CONSERVATION BRANCH

*Officer delegated under Section 20  
of the Environmental Protection Act 1986*

3 May 2012

# Plan 4910/1

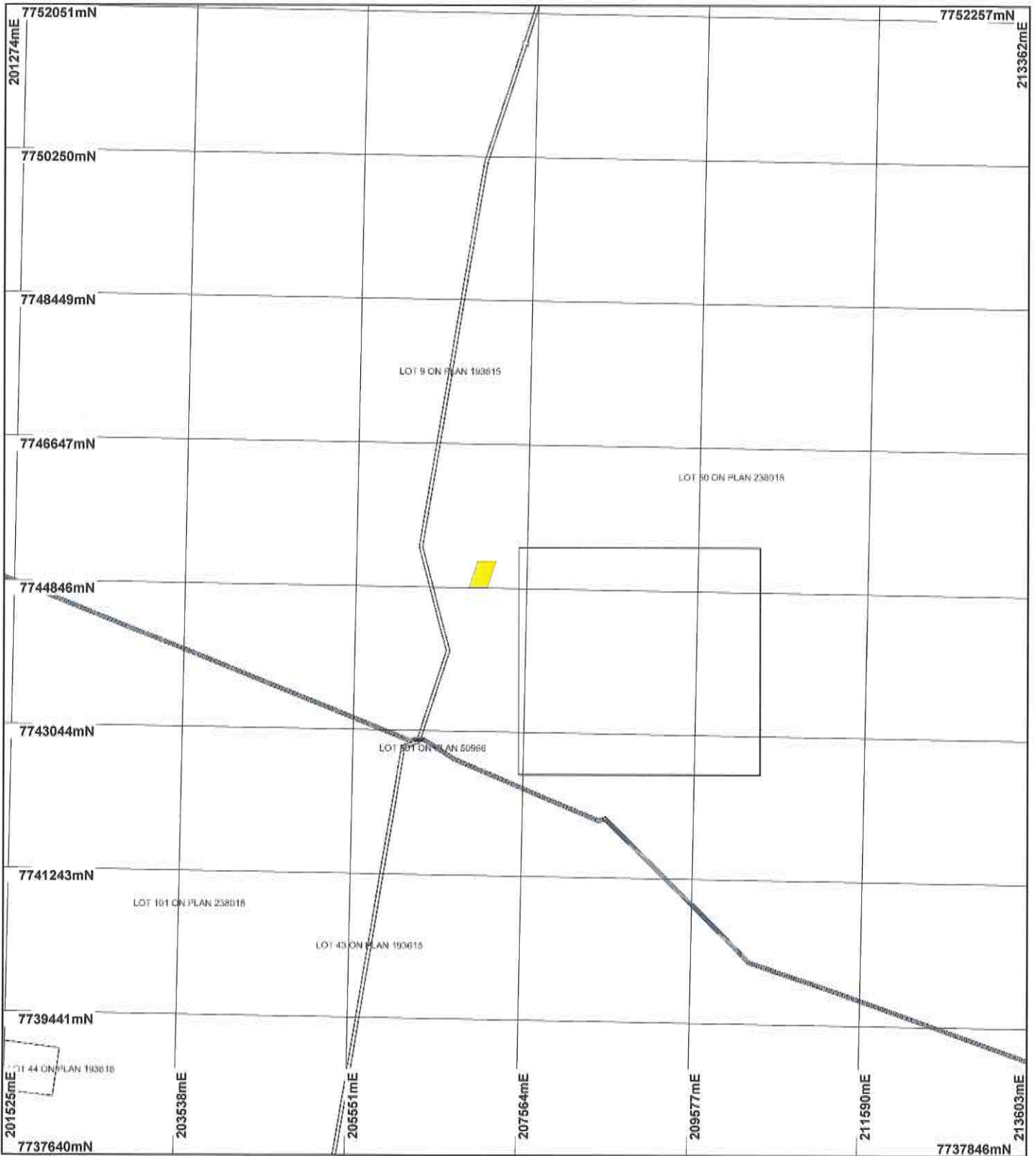

## LEGEND

### Clearing Instruments

- Areas Approved to Clear
- Cadastre for labelling



Geocentric Datum Australia 1994

Note: the data in this map have not been projected. This may result in geometric distortion or measurement inaccuracies.

*[Signature]* Date 3/5/12  
K Faulkner

Officer with delegated authority under Section 20 of the Environmental Protection Act 1986

Information derived from this map should be confirmed with the data custodian acknowledged by the agency acronym in the legend.



Department of Environment and Conservation

Our environment, our future  
WA Crown Copyright 2002

\* Project Data is denoted by astersk. This data has not been quality assured. Please contact map author for details.



## 1. Application details

### 1.1. Permit application details

Permit application No.: 4910/1  
Permit type: Purpose Permit

### 1.2. Proponent details

Proponent's name: Annabelle Coppin

### 1.3. Property details

Property: LOT 50 ON PLAN 238018 (MARBLE BAR 6760)  
Local Government Area: Shire of East Pilbara  
Colloquial name: Yarrie Pastoral Lease Station

### 1.4. Application

Clearing Area (ha)	No. Trees	Method of Clearing	For the purpose of:
5		Mechanical Removal	Pastoral Diversification

### 1.5. Decision on application

Decision on Permit Application: Grant  
Decision Date: 3 May 2012

## 2. Site Information

### 2.1. Existing environment and information

#### 2.1.1. Description of the native vegetation under application

Vegetation Description	Clearing Description	Vegetation Condition	Comment
The mapped Beard vegetation association 117 is described as Hummock grasslands, grass steppe; soft spinifex (Shepherd, 2009).	The application is for the proposed clearing of 5ha within Yarrie Pastoral Station for the purpose of a carbon storage project and fencelines.	Very Good: Vegetation structure altered; obvious signs of disturbance (Keighery 1994) to Excellent: Vegetation structure intact; disturbance affecting individual species, weeds non-aggressive (Keighery 1994).	The vegetation condition and description was determined from aerial imagery.

## 3. Assessment of application against clearing principles

### Comments

The application to clear 5ha of native vegetation for the purpose of a carbon storage project and installing fencelines is unlikely to have any significant environmental impacts.

There are two known occurrences of priority flora within the local area (20 km radius); *Fimbristylis sp. Shay Gap* (K.R. Newbey 10293) (priority 1) and *Phyllanthus aridus* (priority 3). However these species occur on different soil types and are unlikely to occur within the application area.

Two fauna species that are listed as 'Rare or Likely to Become Extinct' under the *Wildlife Conservation Act 1950* have been recorded within the local area (20 km radius); *Dasyurus hallucatus* (Northern Quoll) and *Macrotis lagotis* (Greater Bilby). The vegetation under application is within a highly vegetated local area that also contains suitable habitat for these species, therefore the vegetation under application is not considered significant habitat.

There are no declared rare flora species or threatened ecological communities in the vicinity of the project. The vegetation to be cleared is well represented in the local area, and would not have a detrimental impact on fauna.

The assessment of the application identified that the clearing is not likely to be at variance to any of the clearing principles.

**Methodology** References:  
DEC (2007- )  
Keighery (1994)

GIS databases:

- Pre-European vegetation
- SAC Biodatasets (Accessed 19 March 2012)

## Planning instrument, Native Title, Previous EPA decision or other matter.

### Comments

The leaseholders of Crown Lease 3114-1215 (Yarrie Pastoral Station) have given consent for the applicant to apply for a clearing permit.

The applicant has advised that they are concurrently applying for a Pastoral Diversification License from the Pastoral Lands Board.

The Njamal and Warrarn Native Title Claimants have been notified of the proposed clearing via a letter on 9 March 2012. No submissions have been received.

No Aboriginal Sites of Significance are mapped within a 20km radius.

No submissions from the public have been received.

### Methodology

GIS databases:

- Aboriginal Sites of Significance
- Cadastre
- Native Title Claims- Registered with the NNTT

## 4. References

- DEC (2007 - ) NatureMap: Mapping Western Australia's Biodiversity. Department of Environment and Conservation. URL: <http://naturemap.dec.wa.gov.au/>. Accessed 19 March 2012.
- Keighery, B.J. (1994) Bushland Plant Survey: A Guide to Plant Community Survey for the Community. Wildflower Society of WA (Inc). Nedlands, Western Australia.
- Shepherd, D.P. (2009) Adapted from: Shepherd, D.P., Beeston, G.R., and Hopkins, A.J.M. (2001), Native Vegetation in Western Australia. Technical Report 249. Department of Agriculture Western Australia, South Perth.

## 5. Glossary

Term	Meaning
BCS	Biodiversity Coordination Section of DEC
CALM	Department of Conservation and Land Management (now BCS)
DAFWA	Department of Agriculture and Food
DEC	Department of Environment and Conservation
DEP	Department of Environmental Protection (now DEC)
DoE	Department of Environment
DoIR	Department of Industry and Resources
DRF	Declared Rare Flora
EPP	Environmental Protection Policy
GIS	Geographical Information System
ha	Hectare (10,000 square metres)
TEC	Threatened Ecological Community
WRC	Water and Rivers Commission (now DEC)