



CLEARING PERMIT

Granted under section 51E of the Environmental Protection Act 1986

PERMIT DETAILS

Area Permit Number: 5244/1

File Number: 2011/006842-1

Duration of Permit: From 9 November 2012 to 9 November 2014

PERMIT HOLDER

The Shire of Dundas

LAND ON WHICH CLEARING IS TO BE DONE

Lot 350 on Deposited Plan 255179, Noresman

Lot 503 on Deposited Plan 59268, Norseman

AUTHORISED ACTIVITY

The Permit Holder shall not clear more than 5.97 hectares of native vegetation within the area hatched yellow on attached Plan 5244/1.

CONDITIONS

1. Period in which clearing is authorised

The Permit Holder shall not clear native vegetation unless actively using the cleared area for waste disposal within 2 months of the authorised clearing being undertaken.

Roxane Shadbolt

Roxane Shadbolt
A/Principal Environmental Officer, Assessment Coordination
NATIVE VEGETATION CONSERVATION BRANCH

*Officer delegated under Section 20
of the Environmental Protection Act 1986*

18 October 2012

Plan 5244/1

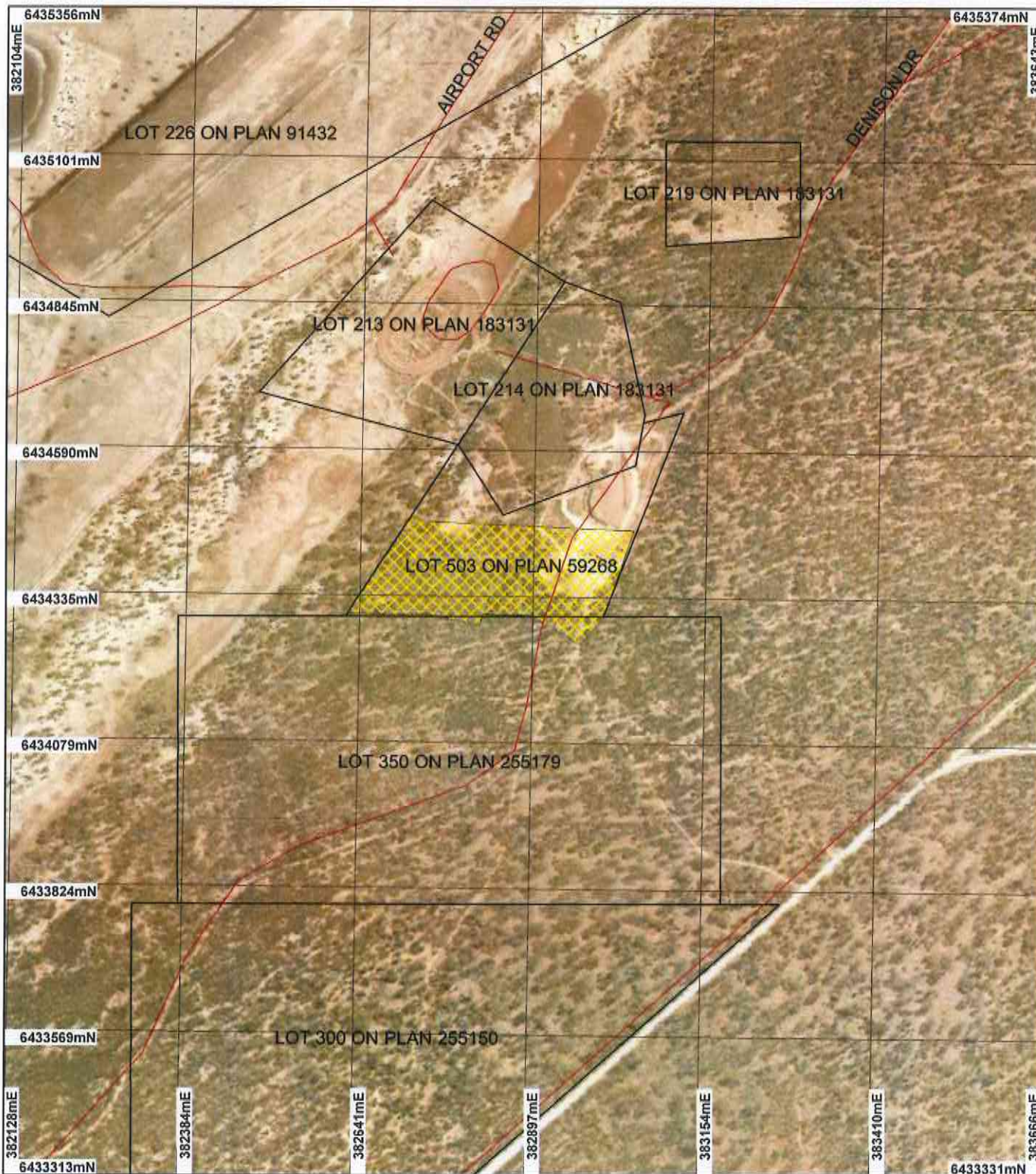

LEGEND

Clearing Instruments

-  Areas Approved to Clear
-  Road Centrelines
-  Cadastre_1

Norseman 1.4m Orthomosaic - Landgate 2003



Scale 1:9028

(Approximate when reproduced at A4)

Geocentric Datum Australia 1994

Note: the data in this map have not been projected. This may result in geometric distortion or measurement inaccuracies.

R Shadbolt Date 18/10/12

Roxane Shadbolt

Officer with delegated authority under Section 20 of the Environmental Protection Act 1986

Information derived from this map should be confirmed with the data custodian acknowledged by the agency acronym in the legend.



Department of Environment and Conservation

Our environment, our future
WA Crown Copyright 2002

* Project Data. This data has not been quality assured. Please contact map author for details.



1. Application details

1.1. Permit application details

Permit application No.: 5244/1
Permit type: Area Permit

1.2. Proponent details

Proponent's name: Shire of Dundas

1.3. Property details

Property: LOT 350 ON PLAN 255179 (NORSEMAN 6443)
LOT 503 ON PLAN 59268 (NORSEMAN 6443)
Local Government Area: Shire of Dundas
Colloquial name:

1.4. Application

Clearing Area (ha)	No. Trees	Method of Clearing	For the purpose of:
5.97		Burning	Industrial
		Mechanical Removal	Industrial

1.5. Decision on application

Decision on Permit Application: Grant
Decision Date: 18 October 2012

2. Site Information

2.1. Existing environment and information

2.1.1. Description of the native vegetation under application

Vegetation Description	Clearing Description	Vegetation Condition	Comment
The application area has been mapped as Beard vegetation association 9: Medium woodland; coral gum (<i>E. torquata</i>) & goldfields blackbutt (<i>E. le souffii</i>) (Shepherd et. al. 2001).	The application is to clear 5.97 hectares of native vegetation for expansion of a waste facility. A large proportion of the application area was illegally cleared with cleared vegetation remaining stockpiled on the site. The application area shows a high level of disturbance due to excessive off-road vehicle use (DEC 2012).	Good: Structure significantly altered by multiple disturbance; retains basic structure/ability to regenerate (Keighery 1994)	The clearing description and vegetation condition were determined through aerial imagery (Norseman 1.4m Orthomosaic Landgate 2003).

3. Assessment of application against clearing principles

Comments

The application is to clear 5.97 hectares of native vegetation in order to expand a waste disposal site, the vegetation is in a good (Keighery 1994) condition due to excessive off road motor vehicle usage (DEC 2012). A portion of the application area was previously cleared and is included in this application in order for the remaining stockpiled vegetation to be removed.

The area under application is surrounded by similar vegetation in better condition with 95% of native vegetation remaining in the local area (10 km radius). Given this and that the area has been previously disturbed, it is not considered likely for the area under application to comprise of a high level of biological diversity, contain significant fauna habitat, contain habitat suitable for rare or priority flora species or consist of a threatened ecological community.

Given that no conservation reserves occur within close proximity to the application and that no wetlands or watercourses occur within the application area; it is not likely the proposed clearing will impact water quality, cause or exacerbate the intensity of flooding or impact on a conservation area.

The proposed clearing of 5.97 hectares occurs on brown and grey loamy soils (Northcote et al. 1960-68) and may be susceptible to soil erosion. The clearing of 5.97 hectares may cause appreciable land degradation in the form of wind erosion given the relatively large size of the proposed clearing. Therefore, the clearing may be at variance to principle (g). A staged clearing condition would mitigate this impact.

Given the above, the proposed clearing may be at variance with clearing principles (g) and is not likely to be at variance with the remaining principles.

Methodology

References

- DEC (2012)
- Shepherd et al. (2001)
- Keighery (1994)
- Northcote et al. (1960-68)

GIS Data Sets

- Noresman 1.4m Orthomosaic Landgate (2003)
- SAC Biodatasets (accessed September 2012)
- Hydrography, Linear (2004)
- Existing DEC Managed Lands and Waters (2011)

Planning instrument, Native Title, Previous EPA decision or other matter.

Comments

The application is to clear 5.97 hectares of native vegetation in order to expand a waste disposal site.

Part of the area described in this application was subject to an investigation by the Department of environment and Conservation (DEC) in 2012. The investigation found that 1.28 hectares of native vegetation was cleared without authority. In response to this incident DEC provided a written warning to the Shire of Dundas on the 22 June 2012. The area unlawfully cleared is included in this application in order for the stockpiled vegetation to be removed and the area used for waste management.

The applicant will require a works approval in order to use the cleared area for waste management. A draft application has been submitted for comment and the applicant has advised that the final approval will still be at least two weeks away (Shire of Dundas 2012).

The application area has been zoned for waste management and the Shire of Dundas holds a management order over it for this purpose.

The application falls within a RIWI act groundwater area, as the proposed waste facility will not involve the extraction of groundwater, no licence is required from the Department of Water.

Methodology

References

Shire of Dundas (2012)

GIS Data Sets

Town planning scheme zones (February 2012)

4. References

DEC (2012) Regional Advice Report for Clearing Permit Application CPS 5244/1, lot 350 on plan 255179, Norseman. Received 28/09/2004. Department of Environment and Conservation, Western Australia (TRIM Ref. DOCA551734).

Keighery, B.J. (1994) Bushland Plant Survey: A Guide to Plant Community Survey for the Community. Wildflower Society of WA (Inc). Nedlands, Western Australia.

Northcote, K. H. with Beckmann G G, Bettenay E., Churchward H. M., van Dijk D. C., Dimmock G. M., Hubble G. D., Isbell R. F., McArthur W. M., Murtha G. G., Nicolls K. D., Paton T. R., Thompson C. H., Webb A. A. and Wright M. J. (1960-68): 'Atlas of Australian Soils, Sheets 1 to 10, with explanatory data'. CSIRO and Melbourne University Press: Melbourne.

Shepherd, D.P., Beeston, G.R., and Hopkins, A.J.M. (2001), Native Vegetation in Western Australia. Technical Report 249. Department of Agriculture Western Australia, South Perth.

Shire of Dundas (2012) Correspondence regarding the progress of a works approval. 4 October 2012

5. Glossary

Term	Meaning
BCS	Biodiversity Coordination Section of DEC
CALM	Department of Conservation and Land Management (now BCS)
DAFWA	Department of Agriculture and Food
DEC	Department of Environment and Conservation
DEP	Department of Environmental Protection (now DEC)
DoE	Department of Environment
DoIR	Department of Industry and Resources
DRF	Declared Rare Flora
EPP	Environmental Protection Policy
GIS	Geographical Information System
ha	Hectare (10,000 square metres)
TEC	Threatened Ecological Community
WRC	Water and Rivers Commission (now DEC)