

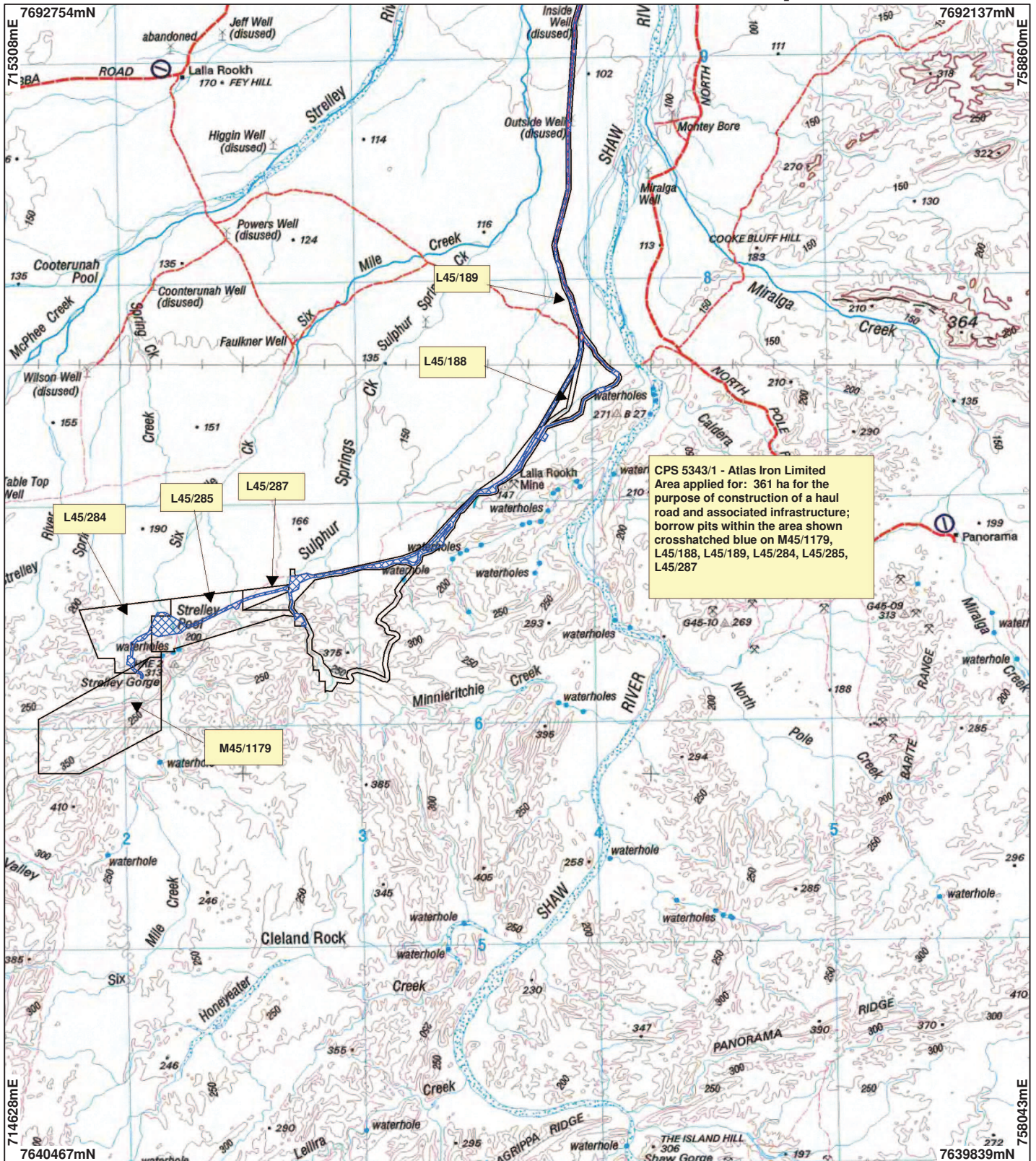

CPS 5343/1 - Atlas Iron Limited - Map 4

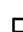

CPS 5343/1 - Atlas Iron Limited
 Area applied for: 361 ha for the
 purpose of construction of a haul
 road and associated infrastructure;
 borrow pits within the area shown
 crosshatched blue on M45/1179,
 L45/188, L45/189, L45/284, L45/285,
 L45/287

LEGEND

-  Mining Tenements
-  Clearing Instruments
-  NATMAP 250K Series Mapping - GA 08/03



0  6.25 km

Scale 1:240000

(Approximate when reproduced at A4)

Geocentric Datum Australia 1994

Note: the data in this map have not been projected. This may result in geometric distortion or measurement inaccuracies.

..... Date

Officer with delegated authority under Section 20 of the Environmental Protection Act 1986

Information derived from this map should be confirmed with the data custodian acknowledged by the agency acronym in the legend.



WA Crown Copyright 2002

* Project Data. This data has not been quality assured. Please contact map author for details.