



CLEARING PERMIT

Granted under section 51E of the Environmental Protection Act 1986

Purpose Permit number:	CPS 5816/1
Permit Holder:	Hamersley Iron Pty Ltd
Duration of Permit:	14 November 2013 – 14 November 2018

ADVICE NOTE:

This Permit does not confer upon the Permit Holder authorisation to access the land to which the Permit relates.

The Permit Holder is authorised to clear native vegetation subject to the following conditions of this Permit.

PART I – CLEARING AUTHORISED

- 1. Purpose for which clearing may be done**
Clearing for the purpose of water recovery at Minthi Spring.
- 2. Land on which clearing is to be done**
Lot 121 on Deposited Plan 219121, Karijini (Reserve 41696)
Lot 126 on Deposited Plan 240332, Karijini (Reserve 30082)
- 3. Area of Clearing**
The Permit Holder must not clear more than 0.5 hectares of native vegetation within the area hatched yellow on attached Plan 5816/1.
- 4. Application**
This Permit allows the Permit Holder to authorise persons, including employees, contractors and agents of the Permit Holder, to clear native vegetation for the purposes of this Permit subject to compliance with the conditions of this Permit and approval from the Permit Holder.

PART II – MANAGEMENT CONDITIONS

- 5. Weed control**
When undertaking any clearing or other activity authorised under this Permit, the Permit Holder must take the following steps to minimise the risk of the introduction and spread of *weeds*:
 - (a) clean earth-moving machinery of soil and vegetation prior to entering and leaving the area to be cleared;
 - (b) ensure that no *weed*-affected soil, *mulch*, *fill* or other material is brought into the area to be cleared; and
 - (c) restrict the movement of machines and other vehicles to the limits of the areas to be cleared.

DEFINITIONS

The following meanings are given to terms used in this Permit:

fill means material used to increase the ground level, or fill a hollow;

mulch means the use of organic matter, wood chips or rocks to slow the movement of water across the soil surface and to reduce evaporation;

weed/s means any plant -

- (a) that is a declared pest under section 22 of the *Biosecurity and Agriculture Management Act 2007*; or
- (b) published in the former Department of Environment and Conservation Regional Weed Assessments, regardless of ranking; or
- (c) not indigenous to the area concerned.



M Warnock
MANAGER
NATIVE VEGETATION CONSERVATION BRANCH

*Officer delegated under Section 20
of the Environmental Protection Act 1986*

14 November 2013

Plan 5816/1

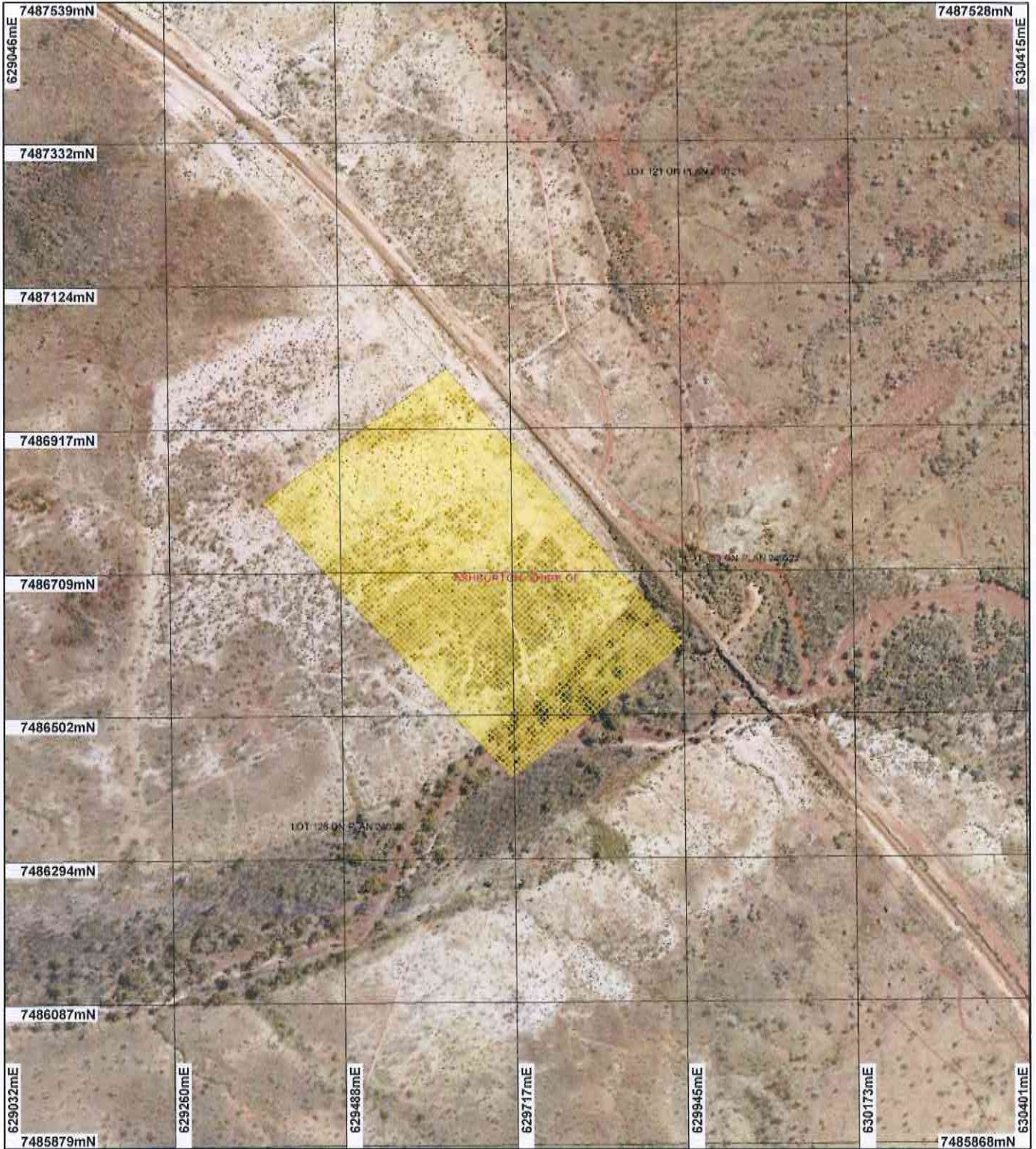

LEGEND

<ul style="list-style-type: none"> ⬜ Road Centrelines ⬜ Cadastral ⬜ Local Government Authorities ⬜ Clearing Instruments ⬜ Areas Approved to Clear 	<p>Mount Bruce 50cm Orthomosaic - Landgate 2004</p>	
--	---	--

Scale 1:7607
 (Approximate when reproduced at A4)

Geocentric Datum Australia 1994
 Note: the data in this map have not been projected. This may result in geometric distortion or measurement inaccuracies.

M. Warnock Date 14/11/13
 M. Warnock
 Officer with delegated authority under Section 20 of the Environmental Protection Act 1986

Information derived from this map should be confirmed with the data custodian acknowledged by the agency acronym in the legend.

Government of Western Australia
 Department of Environment Regulation
 WA Crown Copyright 2002

* Project Data is denoted by asterisk. This data has not been quality assured. Please contact map author for details.



Clearing Permit Decision Report

Government of Western Australia
Department of Environment Regulation

1. Application details

1.1. Permit application details

Permit application No.: 5816/1
Permit type: Purpose Permit

1.2. Proponent details

Proponent's name: Hamersley Iron Pty Ltd

1.3. Property details

Local Government Area: Shire of Ashburton
Colloquial name:
LOT 126 ON PLAN 240332 (KARIJINI 6751)
LOT 121 ON PLAN 219121 (KARIJINI 6751)

1.4. Application

Clearing Area (ha)	No. Trees	Method of Clearing	For the purpose of:
0.5		Mechanical Removal	Water/gas/cable/pipeline/power installation

1.5. Decision on application

Decision on Permit Application: Grant
Decision Date: 14 November 2013

2. Site Information

2.1. Existing environment and information

2.1.1. Description of the native vegetation under application

Vegetation Description	Clearing Description	Vegetation Condition	Comment
Mapped Beard Vegetation Association 567 is described as hummock grasslands, shrub steppe; mulga and kanji over soft spinifex and <i>Triodia basedowii</i> (Shepherd et al 2001).	The clearing of 0.5 hectares of native vegetation within Lot 121 on Deposited Plan 219121 and Lot 126 on Deposited Plan 240332, Karijini, Shire of Ashburton, is for the purpose of water recovery at Minthi Spring.	Completely Degraded: No longer intact; completely/almost completely without native species (Keighery 1994) To Excellent: Vegetation structure intact; disturbance affecting individual species, weeds non-aggressive (Keighery 1994)	The application is to clear 0.5 hectares of native vegetation for the purpose of water recovery at Minthi Spring. A 17.26 hectare study area surrounding the proposed 0.5 hectare clearing area was surveyed by a Rio Tinto botanist on 20 and 21 August 2013 (Rio Tinto 2013). The vegetation in the 17.26 hectare study area is predominantly in very good to excellent (Keighery 1994) condition, with some areas in completely degraded (Keighery 1994) condition where disturbance from vehicle tracks has occurred. The water pipe installation will follow existing tracks where possible, so the vegetation proposed to be cleared is likely to be predominantly in degraded to completely degraded (Keighery 1994) condition. The vegetation within the 17.26 hectare study area consists predominantly of <i>Eucalyptus</i> sp. and <i>Acacia</i> sp. low mallee woodland over tussock and hummock grassland (Rio Tinto 2013). The condition and description of the vegetation was determined by supporting information from the applicant (Rio Tinto 2013).

3. Assessment of application against clearing principles

Comments

The application is to clear 0.5 hectares of native vegetation for the purpose of water recovery at Minthi Spring. The proposal is to extract water from an existing bore and gravity feed water through a pipe into Minthi Spring, to manage potential impacts to the spring in accordance with conditions contained in Ministerial Statement 833. The clearing of native vegetation is required in order to install the water pipe.

The 0.5 hectare application area is linear and passes through a 17.26 hectare study area containing vegetation ranging in condition from completely degraded to excellent (Keighery 1994). The installation of the pipe is intended to follow existing tracks and disturbed areas so the vegetation under application is likely to be in

predominantly degraded to completely degraded (Keighery 1994) condition (Rio Tinto 2013).

Considering the small size and the predominately degraded to completely degraded (Keighery 1994) condition of the application area, the proposed clearing is unlikely to constitute significant habitat for fauna, flora or ecological communities of conservation significance, or contain high biodiversity values.

The application does not occur within an area that has been extensively cleared and is not significant as a remnant. The local area (10 kilometre radius) and the Shire of Ashburton retain at least 99 per cent of original vegetation extent. The mapped Beard Vegetation Association 567 also retains at least 99 per cent of its original extent within the Pilbara IBRA Bioregion (Government of Western Australia 2011).

The application area is within and adjacent to Karijini National Park. The application area was formerly listed on the Register of National Estate (Hamersley Range National Park). Considering the small size and degraded to completely degraded (Keighery 1994) condition of the application area, the proposed clearing is unlikely to impact upon the environmental values of Karijini National Park, provided appropriate weed management measures are implemented.

The proposed clearing is unlikely to cause or exacerbate land degradation or flooding or impact on water quality. There are minor non-perennial watercourses intersecting the 17.26 hectare study area surrounding the proposed clearing. Riparian vegetation may be impacted by the proposed clearing.

Considering the above, the application may be at variance to clearing principle (f), and is not likely to be at variance to the remaining clearing principles.

Methodology

References

- Government of Western Australia (2011)
- Keighery (1994)
- Rio Tinto (2013)

GIS Databases

- DEC tenure
- Hydrography, linear DOW
- NWLRA, Extent of Native Vegetation
- Pre-European vegetation
- SAC Biodatasets - accessed October 2013

Planning instrument, Native Title, Previous EPA decision or other matter.

Comments

The application is to clear 0.5 hectares of native vegetation for the purpose of water recovery at Minthi Spring.

No public submissions have been received.

There are four Aboriginal Sites of Significance within the area under application, including;

- Minday1
- PL isolated artefacts
- MRC99-03
- West Angelas 30

It is the applicant's responsibility to ensure compliance with any obligations under the Aboriginal Heritage Act 1972.

The section of the application area within Karijini National Park is zoned as 'conservation, recreation and nature landscape' under the Town Planning Scheme Zones. The remainder of the application area is zoned as 'other purposes - infrastructure'.

A licence to take water was granted by the Department of Water on 9 August 2013.

The Conservation Commission issued Licence 2423/101 to Hamersley Iron Pty Ltd – pipeline for water supplementation to Minthincoondunna Spring, Karijini National Park.

Methodology

GIS Databases

- Aboriginal Sites of Significance
- Town Planning Scheme Zones

4. References

Government of Western Australia. (2013). 2012 Statewide Vegetation Statistics incorporating the CAR Reserve Analysis (Full Report). Current as of October 2012. WA Department of Environment and Conservation, Perth.

Keighery, B.J. (1994) Bushland Plant Survey: A Guide to Plant Community Survey for the Community. Wildflower Society of WA (Inc). Nedlands, Western Australia.

Rio Tinto (2013) Statement Addressing the 10 Clearing Principles - Minthi Spring, September 2013 (DER Ref: A680287).

Shepherd, D.P., Beeston, G.R., and Hopkins, A.J.M. (2001), Native Vegetation in Western Australia. Technical Report 249. Department of Agriculture Western Australia, South Perth.