

DER 2014/00045

CPS 5993/1

 <p>Department of Environment and Conservation – Department of Mines and Petroleum</p> <p>Application for a clearing permit (area permit) Environmental Protection Act 1986 s 51E</p> <p>FORM C1</p> <p>Clearing of native vegetation is prohibited in Western Australia except where a clearing permit has been granted or an exemption applies. A person who causes or allows unauthorised clearing commits an offence.</p>	<p>Department of Environment Regulation</p> <p>7 JAN 2014</p> <p>Native Vegetation Conservation Branch</p> <p>Date stamp</p>

Part 1 Land details

<p>DEPARTMENT OF ENVIRONMENT</p> <p>The location of the land where clearing is proposed must be accurately described.</p> <p>8 FEB 2014</p> <p>Corporate Information Section</p>	<p>Land description: Volume and Folio number, Lot or location number(s), Crown Lease or Reserve number, Pastoral Lease number or Mining Tenement number of all properties where clearing is proposed.</p> <p><i>Bush Forever residential to building envelope.</i> <i>Volume 2139 Folio 20</i></p> <p>Street address</p> <p><i>133 PINE CREST WAY GNANGARA 6077</i></p> <p>Local government area</p> <p><i>Wanneroo</i></p> <p>Land zoning, e.g. rural, residential, industrial</p> <p><i>Bush Forever Residential</i></p>
FILE REFERENCE	

Part 2 Proposal

<p>An aerial photograph or map with a north arrow must be attached, clearly showing the area proposed to be cleared, or</p> <p>If you have the facilities, a digital map on CDROM of the area to clear in one of the following formats:</p> <p>1. ESRI Shapefile with the following properties:</p> <ul style="list-style-type: none"> • Geometry type: Polygon shape. • Coordinate system: GDA 1994 (Geographic latitude/longitude). • Datum: GDA 1994 (Geocentric Datum of Australia 1994). <p>2. Autocad 2000 or earlier; or</p> <p>3. Microstation 8 or earlier.</p>	<p>Total area of clearing proposed (Hectares) and/or number of individual trees to be removed</p> <p><i>2.1 Hectare</i> <i>5-6</i></p> <p>Proposed method of clearing</p> <p><i>Bull dozer</i></p> <p>Period within which clearing is proposed to be undertaken, e.g. May 2010–June 2010</p> <p><i>May – June 2014</i></p> <p>Purpose of clearing</p> <p><i>To utilize building envelope for recreational use, grow vine trees, grass and pathways to allow family to experience bush. Good view from rear deck.</i></p>
---	---

Part 3 Applicant

<p>To apply for a permit you must either be:</p> <ul style="list-style-type: none"> • the landowner; ✓ • acting on the landowner's behalf; or • likely to become the landowner. <p>Note: If you are acting on behalf of the landowner, you must attach a letter of authority from the landowner explicitly stating that you, the applicant, has authority to clear on the said land.</p>	<p>Are you applying as an individual, a company or an incorporated body? – enter details for one only (please print).</p> <p>An individual – applicant's given names, family name and title (Mr, Mrs, Ms, etc)</p> <p><i>Mr & Mrs M MacAdams</i></p> <p>A company or incorporated body name (Note: companies must supply an Australian Company Number - ACN)</p> <p><i>/</i></p>
<p>Ownership of land</p> <p>If granted, the permit will be issued in the name of the landowner (or applicant if acting on behalf of the landowner).</p> <p>A landowner can be:</p> <ul style="list-style-type: none"> • a person who holds the Certificate of Title • a person who is the lessee of Crown land, or • a public authority that is responsible for care of the land. 	<p>Full name of all landowners as they appear on the Certificate of Title (please print)</p> <p>(1) <i>ISABELLE MARY THERESA MACADAMS</i></p> <p>(2) <i>MICHAEL JOSEPH MACADAMS</i></p> <p>If more than one Certificate of Title, please include details on a separate sheet.</p>

260.68M

68.5M

15M

JOYLE ROAD

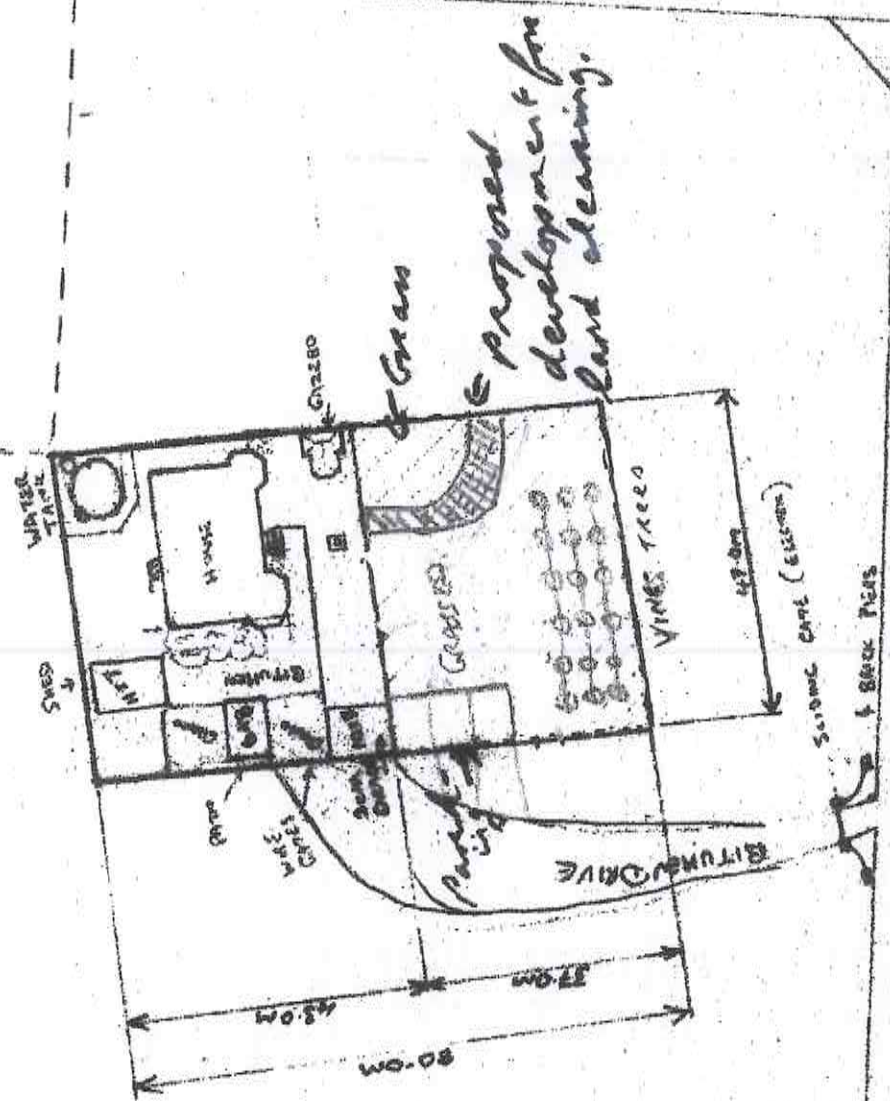

LOT No. 4

← NORTH

SCALE: 1 = 1000