



CLEARING PERMIT

Granted under section 51E of the Environmental Protection Act 1986

| | |
|-------------------------------|-----------------------------------|
| Purpose Permit number: | CPS 6199/2 |
| Permit Holder: | DDG Ashburton Pty Ltd |
| Duration of Permit: | 1 November 2014 – 1 November 2024 |

The Permit Holder is authorised to clear native vegetation subject to the following conditions of this Permit.

PART I – CLEARING AUTHORISED

1. Purpose for which clearing may be done

Clearing for the purpose of facilitating the construction and operation of a gas pipeline.

2. Land on which clearing is to be done

Lot 561 on Deposited Plan 71346, Talandji

Lot 519 on Deposited Plan 69198, Talandji

Lot 555 on Deposited Plan 74894, Talandji

Lot 556 on Deposited Plan 74894, Talandji

Lot 557 on Deposited Plan 74894, Talandji

3. Area of Clearing

The Permit Holder must not clear more than 31.8 hectares of native vegetation within the area cross hatched yellow on attached Plan 6199/2.

4. Application

This Permit allows the Permit Holder to authorise persons, including employees, contractors and agents of the Permit Holder, to clear native vegetation for the purposes of this Permit subject to compliance with the conditions of this Permit and approval from the Permit Holder.

5. Period in which clearing is authorised

The Permit Holder shall not clear any native vegetation after 1 November 2019.

PART II – MANAGEMENT CONDITIONS

6. Weed control

When undertaking any clearing or other activity authorised under this Permit, the Permit Holder must take the following steps to minimise the risk of the introduction and spread of *weeds*:

- clean earth-moving machinery of soil and vegetation prior to entering and leaving the area to be cleared;
- ensure that no *weed*-affected soil, *mulch*, *fill* or other material is brought into the area to be cleared; and
- restrict the movement of machines and other vehicles to the limits of the areas to be cleared.

7. Retain vegetative material and topsoil, revegetation and rehabilitation

The Permit Holder shall:

- (a) Retain the vegetative material and topsoil removed by clearing authorised under this Permit and stockpile the vegetative material and topsoil in an area that has already been cleared.
- (b) At an optimal time within 12 months following clearing authorised under this Permit, *revegetate* and *rehabilitate* areas no longer required for the purpose for which they were cleared under this Permit, by:
 - (i) ripping the ground on the contour to remove soil compaction; and
 - (ii) laying the vegetative material and topsoil retained under condition 7(a) on the cleared area(s).
- (c) Within 24 months of laying the vegetative material and topsoil on the cleared area in accordance with condition 7(b) of this Permit:
 - (i) engage an *environmental specialist* to determine the species composition, structure and density of the area *revegetated* and *rehabilitated*; and
 - (ii) where, in the opinion of an *environmental specialist*, the composition structure and density determined under condition 7(c)(i) of this Permit will not result in a similar species composition, structure and density to that of pre-clearing vegetation types in that area, *revegetate* the area by deliberately *planting* and/or *direct seeding* native vegetation that will result in a similar species composition, structure and density of native vegetation to pre-clearing vegetation types in that area and ensuring only *local provenance* seeds and propagating material are used.
- (d) Where additional *planting* or *direct seeding* of native vegetation is undertaken in accordance with condition 7(c)(ii) of this permit, the Permit Holder shall repeat condition 7(c)(i) and 7(c)(ii) within 24 months of undertaking the additional *planting* or *direct seeding* of native vegetation
- (e) Where a determination by an *environmental specialist* that the composition, structure and density within areas *revegetated* and *rehabilitated* will result in a similar species composition, structure and density to that of pre-clearing vegetation types in that area, as determined in condition 7(c)(i) and (ii) of this permit, that determination shall be submitted for the CEO's consideration. If the CEO does not agree with the determination made under condition 7(c)(ii), the CEO may require the Permit Holder to undertake additional *planting* and *direct seeding* in accordance with the requirements under condition 7(c)(ii).

8. Construction Environmental Plan

- (a) The Permit Holder must prepare a Construction Environmental Plan;
- (b) The final Construction Environmental Plan must be approved by the CEO prior to commencing works; and
- (c) Prior to clearing the Permit Holder must implement the Construction Environmental Plan as approved by the CEO in correspondence dated 14 November 2014.

PART III - RECORD KEEPING AND REPORTING

9. Records must be kept

The Permit Holder must maintain the following records for activities done pursuant to this Permit:

- (a) In relation to the clearing of native vegetation authorised under this Permit:
 - (i) the species composition, structure and density of the cleared area;
 - (ii) the location where the clearing occurred, recorded using a Global Positioning System (GPS) unit set to Geocentric Datum Australia 1994 (GDA94), expressing the geographical coordinates in Eastings and Northings or decimal degrees;
 - (iii) the date that the area was cleared; and
 - (iv) the size of the area cleared (in hectares).

- (b) In relation to the *revegetation* and *rehabilitation* of areas pursuant to condition 7 of this Permit:
- (i) the location of any areas *revegetated* and *rehabilitated*, recorded using a Global Positioning System (GPS) unit set to Geocentric Datum Australia 1994 (GDA94), expressing the geographical coordinates in Eastings and Northings or decimal degrees;
 - (ii) a description of the *revegetation* and *rehabilitation* activities undertaken;
 - (iii) the size of the area *revegetated* and *rehabilitated* (in hectares);
 - (iv) the species composition, structure and density of *revegetation* and *rehabilitation*; and
 - (v) a copy of the environmental specialist's report.

10. Reporting

- (a) The Permit Holder must provide to the CEO on or before 31 December of each year, a written report:
- (i) of records required under condition 9 of this Permit; and
 - (ii) concerning activities done by the Permit Holder under this Permit between 1 January to 31 December of the preceding year.
- (b) If no clearing authorised under this Permit was undertaken between 1 January to 31 December of the preceding year, a written report confirming that no clearing under this permit has been carried out, must be provided to the CEO on or before 31 December of each year.
- (c) Prior to 1 August 2024, the Permit Holder must provide to the CEO a written report of records required under condition 9 of this Permit where these records have not already been provided under condition 10(a) of this Permit.

DEFINITIONS

The following meanings are given to terms used in this Permit:

direct seeding means a method of re-establishing vegetation through the establishment of a seed bed and the introduction of seeds of the desired plant species;

environmental specialist means a person who is engaged by the Permit Holder for the purpose of providing environmental advice, who holds a tertiary qualification in environmental science or equivalent, and has experience relevant to the type of environmental advice that an environmental specialist is required to provide under this Permit;

fill means material used to increase the ground level, or fill a hollow;

local provenance means native vegetation seeds and propagating material from natural sources within 50 kilometres of the area cleared;

mulch means the use of organic matter, wood chips or rocks to slow the movement of water across the soil surface and to reduce evaporation;

planting means the re-establishment of vegetation by creating favourable soil conditions and planting seedlings of the desired species;

rehabilitate/ed/ion means actively managing an area containing native vegetation in order to improve the ecological function of that area;

revegetate/ed/ion means the re-establishment of a cover of *local provenance* native vegetation in an area using methods such as *regeneration*, *direct seeding* and/or *planting*, so that the species composition, structure and density is similar to pre-clearing vegetation types in that area;

weed/s means any plant -

- (a) that is a declared pest under section 22 of the *Biosecurity and Agriculture Management Act 2007*; or
- (b) published in a Department of Parks and Wildlife Regional Weed Rankings Summary, regardless of ranking; or
- (c) not indigenous to the area concerned.



M Warnock
SENIOR MANAGER
CLEARING REGULATION

*Officer delegated under Section 20
of the Environmental Protection Act 1986*

2 July 2015

Plan 6199/2

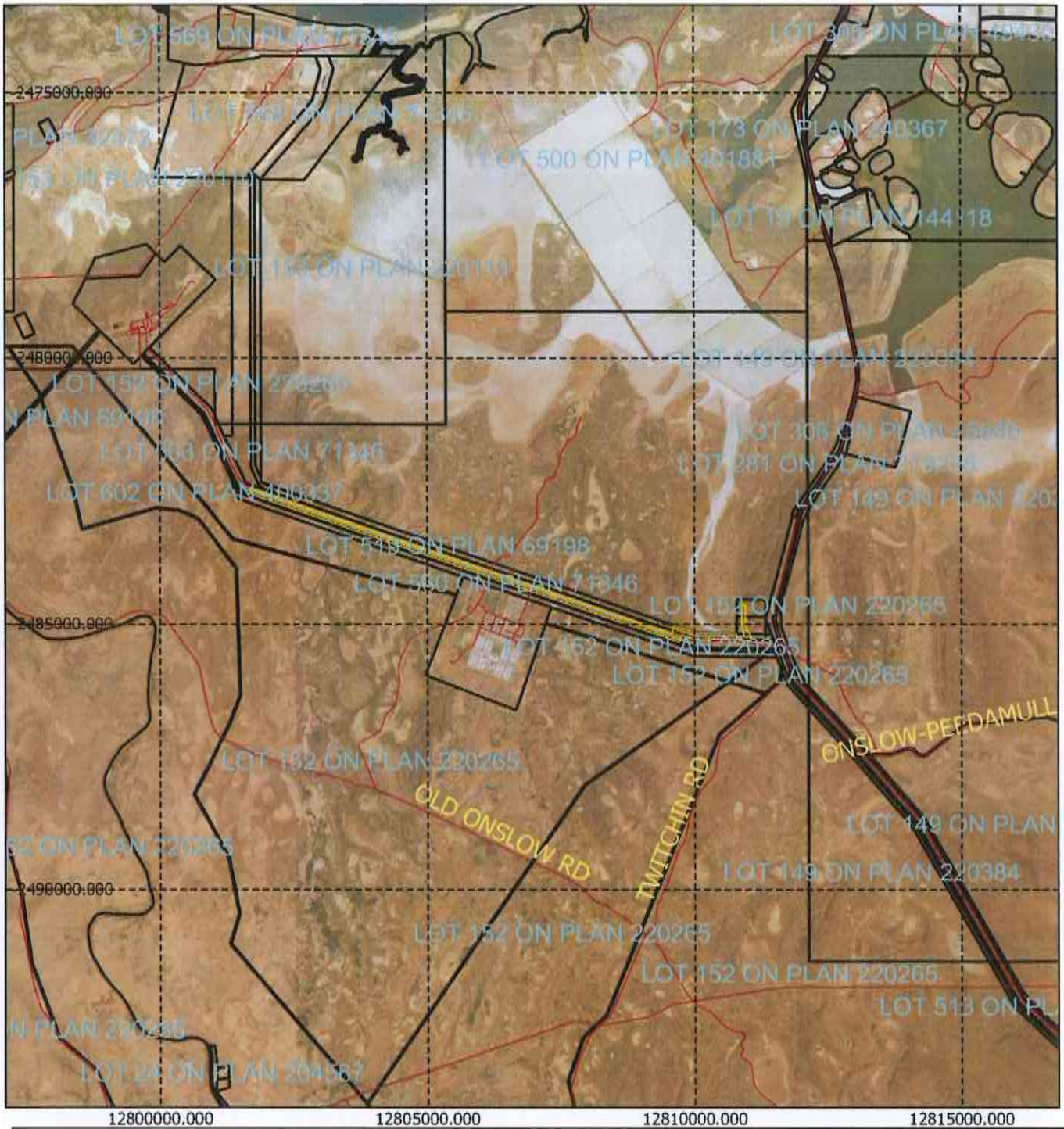

Legend

-  Areas approved to clear
-  Iga
-  Roads
-  Cadastre
-  Virtual Mosaic
- 



1:107,163

MGA 94
Geocentric Datum of Australia 1994

M Warnock Date *2/7/15*
M Warnock

Officer with delegated authority under Section 20
of the Environmental Protection Act 1986



GOVERNMENT OF
WESTERN AUSTRALIA



1. Application details

1.1. Permit application details

Permit application No.: 6199/2
Permit type: Purpose Permit

1.2. Proponent details

Proponent's name: DDG Ashburton Pty Ltd

1.3. Property details

Property: LOT 519 ON DEPOSITED PLAN 69198, TALANDJI
LOT 555 ON DEPOSITED PLAN 74894, TALANDJI
LOT 556 ON DEPOSITED PLAN 74894, TALANDJI
LOT 557 ON DEPOSITED PLAN 74894, TALANDJI
LOT 561 ON DEPOSITED PLAN 71346, TALANDJI
Shire of Ashburton

Local Government Authority:

DER Region: Pilbara
LCDC: Ashburton

1.4. Application

| | | | |
|--------------------|-----------|--------------------|---|
| Clearing Area (ha) | No. Trees | Method of Clearing | For the purpose of: |
| 31.8 | | Mechanical Removal | Water/gas/cable/pipeline/power installation |

1.5. Decision on application

Decision on Permit Application: Grant
Decision Date: 02 July 2015

2. Site Information

2.1. Existing environment and information

2.1.1. Description of the native vegetation under application

| Vegetation Description | Clearing Description | Vegetation Condition | Comment |
|---|--|---|--|
| Beard vegetation association 589: mosaic: short bunch grassland - savanna / grass plain (Pilbara) / Hummock grasslands, grass steppe; soft spinifex (Shepherd et al, 2001). | The application is to clear 31.8 hectares of native vegetation within Lot 561 on Deposited Plan 71346, Lot 519 on Deposited Plan 69198, Lots 555, 556 and 557 on Deposited Plan 74894, Talandji, Shire of Ashburton, for the purpose of facilitating the construction and operation of a gas pipeline. | Pristine; No obvious signs of disturbance (Keighery, 1994). To Degraded: Structure severely disturbed; regeneration to good condition requires intensive management (Keighery 1994) | The amended application is to change the clearing footprint location and include additional properties (Lot 519 on Deposited Plan 69198, Lots 555, 556 and 557 on Deposited Plan 74894, Talandji). A Flora and Vegetation Survey undertaken by Mattiske Consulting (2014) recorded 54 plant taxa within the Ashburton North Gas Pipeline Project Area. The vegetation under application is in a degraded to pristine (Keighery, 1994) condition (Mattiske Consulting, 2014) with the majority being in an excellent condition. The structure and condition of the vegetation under application was determined from a Level 1 Flora and Vegetation Survey undertaken by Mattiske Consulting in April 2014. |
| Beard vegetation association 670: hummock grasslands, shrub steppe; scattered shrubs over <i>Triodia basedowii</i> (Shepherd et al, 2001). | | | |

3. Assessment of application against clearing principles

Comments The application is to amend Clearing Permit CPS 6199/1 to change the clearing footprint location and include additional properties (Lot 519 on Deposited Plan 69198, Lots 555, 556 and 557 on Deposited Plan 74894, Talandji). Since the original project design, the applicant has identified that the proposal requires substantial earthworks to ensure the pipeline is buried at a depth that would not inhibit future works. Subsequently, the increased earthworks are likely to result in a larger vegetation disturbance footprint than originally proposed. Therefore the applicant has proposed to move the application area 100 metres south of the initial proposed clearing location whilst the size of the application area (31.8 hectares) will remain the same.

The assessment against the clearing principles has not changed. The findings from the previous assessment are still relevant and can be found in Clearing Permit Decision Report CPS 6199/1.

Planning instruments and other relevant matters.

Comments The application area falls within a Native Title Claimant area. The claimants, the Thalanyji people, and their representing body, the Buurabalayji Thalanyji and Yamatji Marlpa Aboriginal Corporation, have been notified of this application. A submission (2015) objecting the proposed clearing has been received from the Buurabalayji Thalanyji Aboriginal Corporation on behalf of the Thalanyji People native title claimants. The objection was made on the grounds that the future act in question will impact upon the claimant's native title rights and interests. The proponent has been advised to contact the claimants to address matters raised.

The application area falls within the Pilbara proclaimed surface water and groundwater area under the Rights in Water and Irrigation Act 1914. Any taking or diversion of surface water in this proclaimed area is subject to a licence from the Department of Water (DoW, 2015). The applicant was issued a permit to 'interfere with bed and banks' (PMB179805) from the Department of Water on the 30 October 2014 (DoW, 2015). Any groundwater abstraction in this proclaimed area is subject to licencing by the Department of Water (DoW, 2015).

Methodology References
- DoW (2015)
- Submission (2015)

4. References

- DDG Ashburton Pty Ltd (2014) Onslow Lateral Native Vegetation Clearing Permit Application for the Onslow Lateral Pipeline Project. Clearing Permit Application CPS 6199/1 (DER Ref:A785603).
- DEC (2007 -) NatureMap: Mapping Western Australia's Biodiversity. Department of Environment and Conservation. URL: <http://naturemap.dec.wa.gov.au/>. Accessed June 2015
- DoW (2015) Permit to 'interfere with bed and banks' for CPS 6199/2. Department of Water. Western Australia (DER Ref: A914508).
- Government of Western Australia (2013) 2012 Statewide Vegetation Statistics incorporating the CAR Reserve Analysis (Full Report). Current as of October 2012. WA Department of Environment and Conservation, Perth.
- Keighery, B.J. (1994) Bushland Plant Survey: A Guide to Plant Community Survey for the Community. Wildflower Society of WA (Inc). Nedlands, Western Australia.
- Mattiske Consulting Pty Ltd (2014) Level 1 Flora and Vegetation Survey of the Ashburton North Gas Pipeline Project Area. Clearing Permit Application CPS 6199/1 (DER Ref:A785603).
- Ninox Wildlife Consulting (2014) A Level 1 Vertebrate Fauna Assessment of the Proposed Ashburton North Gas Pipeline, Western Australia. Clearing Permit Application CPS 6199/1 (DER Ref:A785603).
- Northcote, K. H. with Beckmann G G, Bettenay E., Churchward H. M., van Dijk D. C., Dimmock G. M., Hubble G. D., Isbell R. F., McArthur W. M., Murtha G. G., Nicolls K. D., Paton T. R., Thompson C. H., Webb A. A. and Wright M. J. (1960-68): 'Atlas of Australian Soils, Sheets 1 to 10, with explanatory data'. CSIRO and Melbourne University Press: Melbourne.
- Shepherd, D.P., Beeston, G.R., and Hopkins, A.J.M. (2001), Native Vegetation in Western Australia. Technical Report 249. Department of Agriculture Western Australia, South Perth.
- Submission (2015) Submission received for Clearing Permit Application CPS 6199/2 (DER Ref: A926022).
- Western Australian Herbarium (1998-) FloraBase - The Western Australian Flora. Department of Parks and Wildlife. <http://florabase.dpaw.wa.gov.au/> (Accessed June 2015).