



## CLEARING PERMIT

*Granted under section 51E of the Environmental Protection Act 1986*

<b>Purpose Permit number:</b>	CPS 6298/1
<b>Permit Holder:</b>	Department of Water
<b>Duration of Permit:</b>	20 December 2014 – 20 December 2019

The Permit Holder is authorised to clear native vegetation subject to the following conditions of this Permit.

**1. Purpose for which clearing may be done**

Clearing for the purpose of replacing groundwater monitoring bores.

**2. Land on which clearing is to be done**

Unnamed road reserve (PIN 1338940), Bindoon  
Gulliente Road reserve (PIN 1343285), Muchea  
Lot 5607 on Deposited Plan 208673, Pinjar  
Unnamed road reserve (PIN 11419459), Bullsbrook

**3. Area of Clearing**

The Permit Holder must not clear more than 0.771 hectares of native vegetation within the combined areas hatched yellow on attached Plan 6298/1(AM11), Plan 6298/1(AM19), Plan 6298/1(AM25) and Plan 6298/1(AM26).

**4. Application**

This Permit allows the Permit Holder to authorise persons, including employees, contractors and agents of the Permit Holder, to clear native vegetation for the purposes of this Permit subject to compliance with the conditions of this Permit and approval from the Permit Holder.

**5. Type of clearing authorised**

This Permit authorises the Permit Holder to clear native vegetation for the activities described in condition 1 of this Permit to the extent that the Permit Holder has the power to carry out works involving clearing for those activities under the *Water Agencies (Powers) Act 1984* or any other written law.

M Warnock  
SENIOR MANAGER  
CLEARING REGULATION

*Officer delegated under Section 20  
of the Environmental Protection Act 1986*

20 November 2014

# Plan 6298/1(AM11)



## LEGEND

- |                                |                                    |
|--------------------------------|------------------------------------|
| <b>Clearing Instruments</b>    | <b>Road Centrelines</b>            |
| <b>Areas Approved to Clear</b> | <b>Chittering 50cm Orthomosaic</b> |
| <b>Cadastre</b>                | <b>- Landgate 2008</b>             |



Scale 1:1500  
(Approximate when reproduced at A4)

Geocentric Datum Australia 1994

Note: the data in this map have not been projected. This may result in geometric distortion or measurement inaccuracies.

*Matt Warnock* Date *20/11/14*  
Matt Warnock

Officer with delegated authority under Section 20 of the Environmental Protection Act 1986

Information derived from this map should be confirmed with the data custodian acknowledged by the agency acronym in the legend.



Government of Western Australia  
Department of Environment Regulation

WA Crown Copyright 2002



# Plan 6298/1(AM19)



## LEGEND

- |                             |                              |
|-----------------------------|------------------------------|
| <b>Clearing Instruments</b> | Local Government Authorities |
| Areas Approved to Clear     | Road Centrelines             |
| Cadastral                   |                              |



Scale 1:1500  
(Approximate when reproduced at A4)

Geocentric Datum Australia 1994

Note: the data in this map have not been projected. This may result in geometric distortion or measurement inaccuracies.

*amw* Date 20/11/14  
Matt Warnock

Officer with delegated authority under Section 20 of the Environmental Protection Act 1986

Information derived from this map should be confirmed with the data custodian acknowledged by the agency acronym in the legend.



Government of Western Australia  
Department of Environment Regulation

WA Crown Copyright 2002



# Plan 6298/1(AM25)

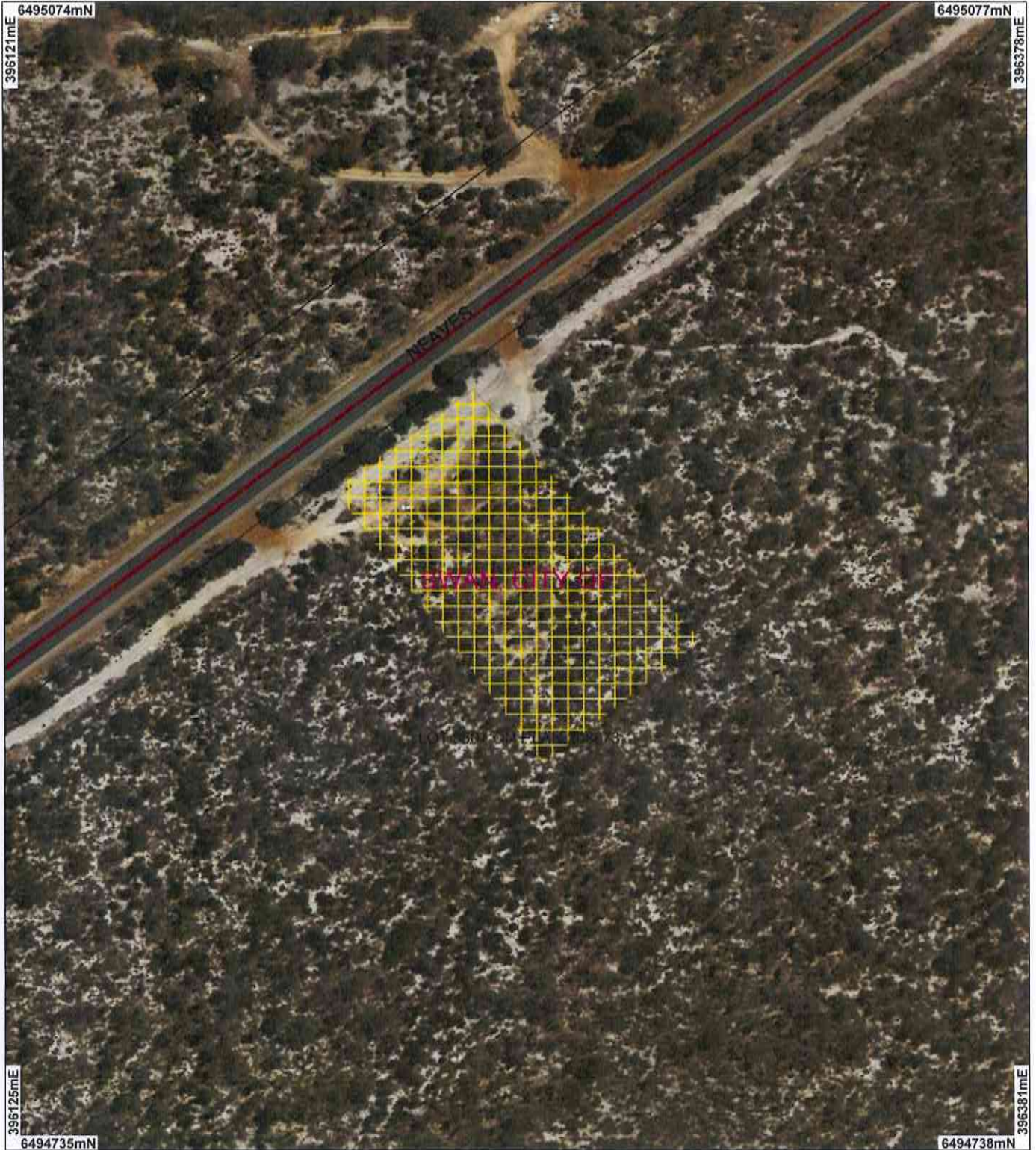

## LEGEND

- |   |   |
|---|---|
| <b>Clearing Instruments</b>                                 | <input type="checkbox"/> Local Government Authorities |
| <input checked="" type="checkbox"/> Areas Approved to Clear | <input type="checkbox"/> Cadastre                     |
| <input type="checkbox"/> Cadastre                           | <input checked="" type="checkbox"/> Road Centrelines  |



Scale 1:1500  
(Approximate when reproduced at A4)

Geocentric Datum Australia 1994

Note: the data in this map have not been projected. This may result in geometric distortion or measurement inaccuracies.

*Matt Warnock* Date 20/11/14  
Matt Warnock

Officer with delegated authority under Section 20 of the Environmental Protection Act 1986

Information derived from this map should be confirmed with the data custodian acknowledged by the agency acronym in the legend.



Government of Western Australia  
Department of Environment Regulation

WA Crown Copyright 2002



# Plan 6298/1(AM26)



## LEGEND

- |                         |                              |
|-------------------------|------------------------------|
| Clearing Instruments    | Local Government Authorities |
| Areas Approved to Clear | Road Centrelines             |
| Cadastre                |                              |



Scale 1:1500  
(Approximate when reproduced at A4)

Geocentric Datum Australia 1994

Note: the data in this map have not been projected. This may result in geometric distortion or measurement inaccuracies.

*Matt Warnock* Date 20/11/14  
Matt Warnock

Officer with delegated authority under Section 20 of the Environmental Protection Act 1986

Information derived from this map should be confirmed with the data custodian acknowledged by the agency acronym in the legend.



Government of Western Australia  
Department of Environment Regulation

WA Crown Copyright 2002



# Clearing Permit Decision Report

## 1. Application details

### 1.1. Permit application details

Permit application No.: 6298/1  
Permit type: Purpose Permit

### 1.2. Proponent details

Proponent's name: Department of Water

### 1.3. Property details

Property: Unnamed road reserve (PIN 1338940), Bindoon  
Gulliente Road reserve (PIN 1343285), Muchea  
Lot 5607 On Plan 208673 (Pinjar)  
Unnamed road reserve (PIN 11419459), Bullsbrook

Local Government Area: City of Swan  
Shire of Chittering

Colloquial name: Groundwater monitoring bores AM11, AM19, AM25 and AM26

### 1.4. Application

Clearing Area (ha)	No. Trees	Method of Clearing	For the purpose of:
0.771		Mechanical Removal	Bore construction

### 1.5. Decision on application

Decision on Permit Application: Grant  
Decision Date: 20 November 2014

## 2. Site Information

### 2.1. Existing environment and information

#### 2.1.1. Description of the native vegetation under application

##### Vegetation Description

Mapped Beard Vegetation Association 4 is described as medium woodland; jarrah, marri & wandoo (Shepherd et al 2001).

Mapped Beard Vegetation Association 949 is described as low woodland; banksia (Shepherd et al 2001).

Mapped Beard Vegetation Association 1027 is described as medium open woodland; jarrah & marri, with low woodland; banksia / Medium sparse woodland; jarrah & marri (Shepherd et al 2001).

##### Vegetation Condition

Good: Structure significantly altered by multiple disturbance; retains basic structure/ability to regenerate (Keighery 1994).

To

Completely Degraded: No longer intact; completely/almost completely without native species (Keighery 1994).

## 3. Assessment of application against clearing principles

**Comments** The proposed clearing consists of 0.771 hectares of native vegetation within unnamed road reserve (PIN1338940), Bindoon, Gulliente road reserve (PIN 1343285), Muchea, Lot 5607 on Deposited Plan 208673, Pinjar, and unnamed road reserve (PIN 11419459), Bullsbrook, for the purpose of replacing four groundwater monitoring bores.

Consideration has been given to impacts to biodiversity, significant fauna habitat, rare flora, threatened ecological communities, remnant vegetation values, wetlands, watercourses, land degradation, surface water quality, groundwater quality and flooding. The assessment has found that the clearing under application is not likely to be at variance to any of the clearing principles.

Three of the bores, Plan 6298/1(AM11), Plan 6298/1(AM19) and Plan 6298/1(AM26), are within registered Indigenous Heritage Sites. It is the responsibility of the proponent to ensure that no Aboriginal Sites of Significance are damaged through the clearing process.

The City of Swan (2014) has advised that it has no objection to the clearing permit application.

No submissions have been received for this application to clear.

**Methodology** Reference:  
City of Swan

GIS Databases:  
Aerial imagery  
Hydrography, Linear  
Pre-European Vegetation  
IBRA WA (Regions - Sub Regions)  
Soils, Statewide  
Aboriginal Sites of Significance  
SAC Biodatasets

#### **4. References**

- Keighery, B.J. (1994) Bushland Plant Survey: A Guide to Plant Community Survey for the Community. Wildflower Society of WA (Inc). Nedlands, Western Australia.
- Shepherd, D.P., Beeston, G.R., and Hopkins, A.J.M. (2001), Native Vegetation in Western Australia. Technical Report 249. Department of Agriculture Western Australia, South Perth.
- City of Swan (2014) Planning advice (DER ref: A830207)