



CLEARING PERMIT

Granted under section 51E of the Environmental Protection Act 1986

Purpose Permit number:	CPS 6407/2
Permit Holder:	Western Australian Land Authority TA LandCorp
Duration of Permit:	14 March 2015 – 14 March 2020

The Permit Holder is authorised to clear native vegetation subject to the following conditions of this Permit.

PART I – CLEARING AUTHORISED

1. Purpose for which clearing may be done

Clearing for the purpose of constructing groundwater bores and storage of surplus landfill.

2. Land on which clearing is to be done

Lot 501 on Deposited Plan 403769 (Reserve 25716), Roebuck

3. Area of Clearing

The Permit Holder must not clear more than 2.72 hectares of native vegetation within the area shaded yellow on attached Plan 6407/2.

4. Application

This Permit allows the Permit Holder to authorise persons, including employees, contractors and agents of the Permit Holder, to clear native vegetation for the purposes of this Permit subject to compliance with the conditions of this Permit and approval from the Permit Holder.

5. Type of clearing authorised

This Permit authorises the Permit Holder to clear native vegetation for activities to the extent that the Permit Holder has the right to access land under the *Land Administration Act 1997* or any other written law.

PART II – MANAGEMENT CONDITIONS

6. Avoid, minimise etc clearing

In determining the amount of native vegetation to be cleared authorised under this Permit, the Permit Holder must have regard to the following principles, set out in order of preference:

- avoid the clearing of native vegetation;
- minimise the amount of native vegetation to be cleared; and
- reduce the impact of clearing on any environmental value.

7. Weed control

When undertaking any clearing or other activity pursuant to this Permit, the Permit Holder must take the following steps to minimise the risk of the introduction and spread of *weeds*:

- Clean earth-moving machinery of soil and vegetation prior to entering and leaving the area to be cleared;
- Ensure that no *weed*-affected soil, *mulch*, *fill* or other material is brought into the area to be cleared; and
- Restrict the movement of machines and other vehicles to the limits of the areas to be cleared.

DEFINITIONS

The following meanings are given to terms used in this Permit:

fill means material used to increase the ground level, or fill a hollow;

mulch means the use of organic matter, wood chips or rocks to slow the movement of water across the soil surface and to reduce evaporation;

weed/s means any plant -

- (a) that is a declared pest under section 22 of the *Biosecurity and Agriculture Management Act 2007*; or
- (b) published in a Department of Parks and Wildlife Regional Weed Rankings Summary, regardless of ranking; or
- (c) not indigenous to the area concerned.



M Warnock
SENIOR MANAGER
CLEARING REGULATION

*Officer delegated under Section 20
of the Environmental Protection Act 1986*

27 August 2015

Plan 6407/2

1061500

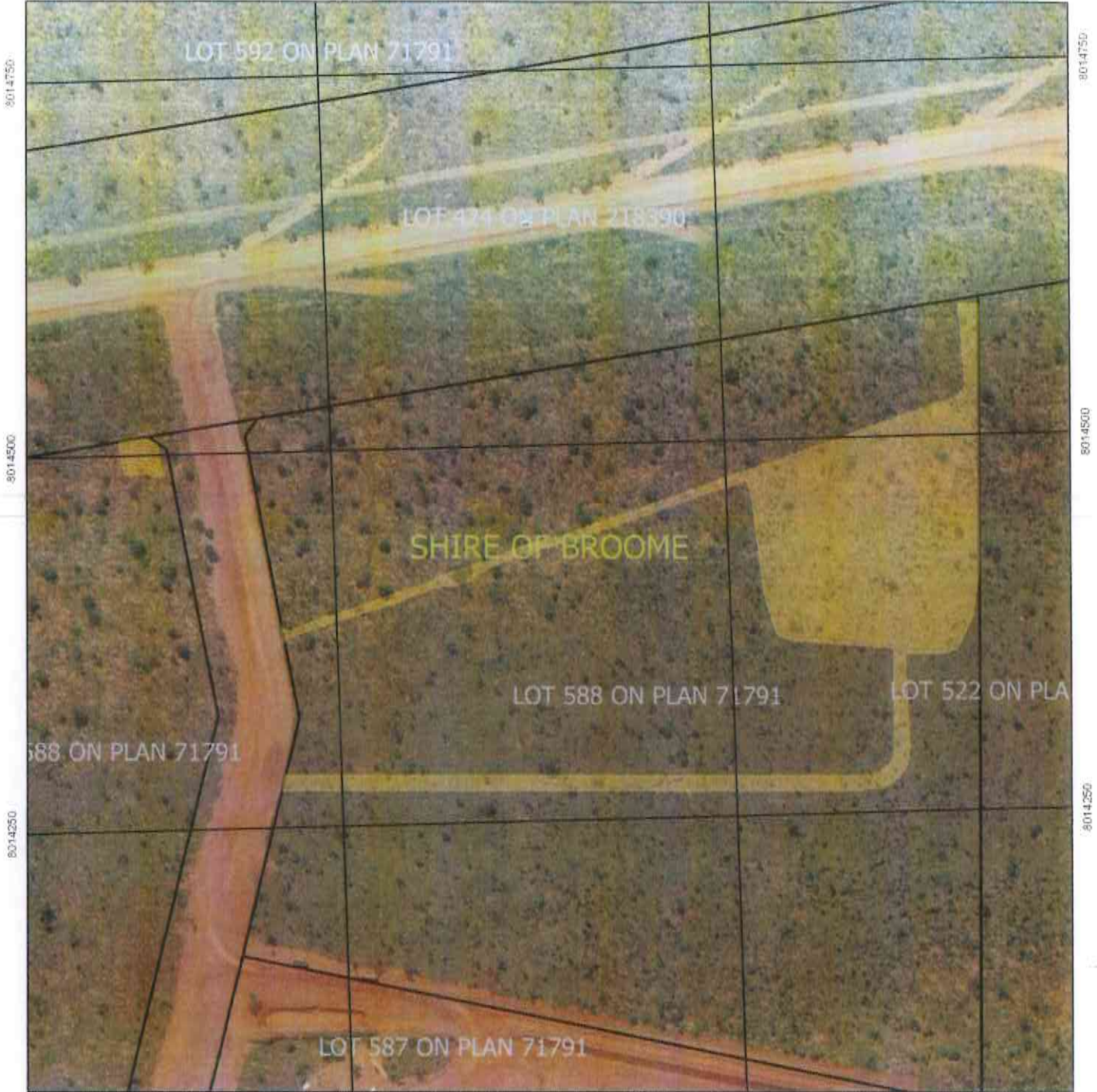

1061750



1061500

1061750

Legend

-  Areas approved to clear
-  LGA
- Roads
-  cadastre_land_tenure_flattened
- Virtual Mosaic



1:3,000

MGA 94

Geocentric Datum of Australia 1994

M Warnock Date 27/8/15
M Warnock

Officer with delegated authority under Section 20
of the Environmental Protection Act 1986



GOVERNMENT OF
WESTERN AUSTRALIA



1. Application details

1.1. Permit application details

Permit application No.: 6407/2
Permit type: Purpose Permit

1.2. Proponent details

Proponent's name: Western Australian Land Authority TA Landcorp

1.3. Property details

Property: LOT 501 ON DEPOSITED PLAN 403769, ROEBUCK
Colloquial name:
Local Government Authority: BROOME, SHIRE OF
DER Region: North West
DPaW District: WEST KIMBERLEY
LCDC: BROOME
Localities: ROEBUCK

1.4. Application

Clearing Area (ha)	No. Trees	Method of Clearing	For the purpose of:
2.72		Mechanical Removal	Bore construction/storage of landfill

1.5. Decision on application

Decision on Permit: Granted
Application:
Decision Date: 27 August 2015

2. Site Information

2.1. Existing environment and information

2.1.1. Description of the native vegetation under application

Vegetation Description	Clearing Description	Vegetation Condition	Comment
Mapped Beard vegetation association 750 is described as: Shrublands, pindan; <i>Acacia tumida</i> shrubland with grey box and cabbage gum medium woodland over ribbon grass and curly spinifex (Shepherd et al. 2001).	To clear 2.72 hectares of native vegetation within Lot 501 on Deposited Plan 403769 (Reserve 25716), Roebuck, for the purposes of creating groundwater bores and storage of landfill,	Very Good; Vegetation structure altered; obvious signs of disturbance (Keighery 1994).	The condition and description of the vegetation was determined via a Preliminary Environmental Impact Assessment and Biological Survey (GHD 2010).
Pindan Woodland comprises low open forest of <i>Acacia plectocarpa</i> subsp. <i>plectocarpa</i> , <i>Bauhinia cunninghamii</i> and <i>Eucalypt</i> spp. over open shrubland of <i>Waltheria indica</i> , <i>Melhaniania oblongifolia</i> and <i>Corchorus sidioides</i> subsp. <i>sidioides</i> and open tussock grassland of <i>Triodia schinzii</i> , <i>Sorghum plumosum</i> and <i>Yakirra australiensis</i> over scattered sedges of <i>Scleria brownii</i> (complex) and <i>Fimbristylis oxystachya</i> (GHD 2010).			

3. Assessment of application against clearing principles

Comments: This amendment has been made to increase the clearing footprint and clearing size by 0.79 hectares. The assessment against the clearing principles has not changed and can be found in Decision Report CPS 6407/1.

Planning instruments and other relevant matters.

Comments The assessment against Planning and Other Matters has not changed and can be found in Decision Report CPS 6407/1.

4. References

- GHD (2010) Preliminary Environmental Impact Assessment and Biological Survey. Additional Information for Clearing Permit Application CPS 6340/1 (DER Ref: A831094).
- Keighery, B.J. (1994) Bushland Plant Survey: A Guide to Plant Community Survey for the Community. Wildflower Society of WA (Inc). Nedlands, Western Australia.
- Shepherd, D.P., Beeston, G.R., and Hopkins, A.J.M. (2001), Native Vegetation in Western Australia. Technical Report 249. Department of Agriculture Western Australia, South Perth.