

CPS 6486/1 - Tronox Management Pty Ltd

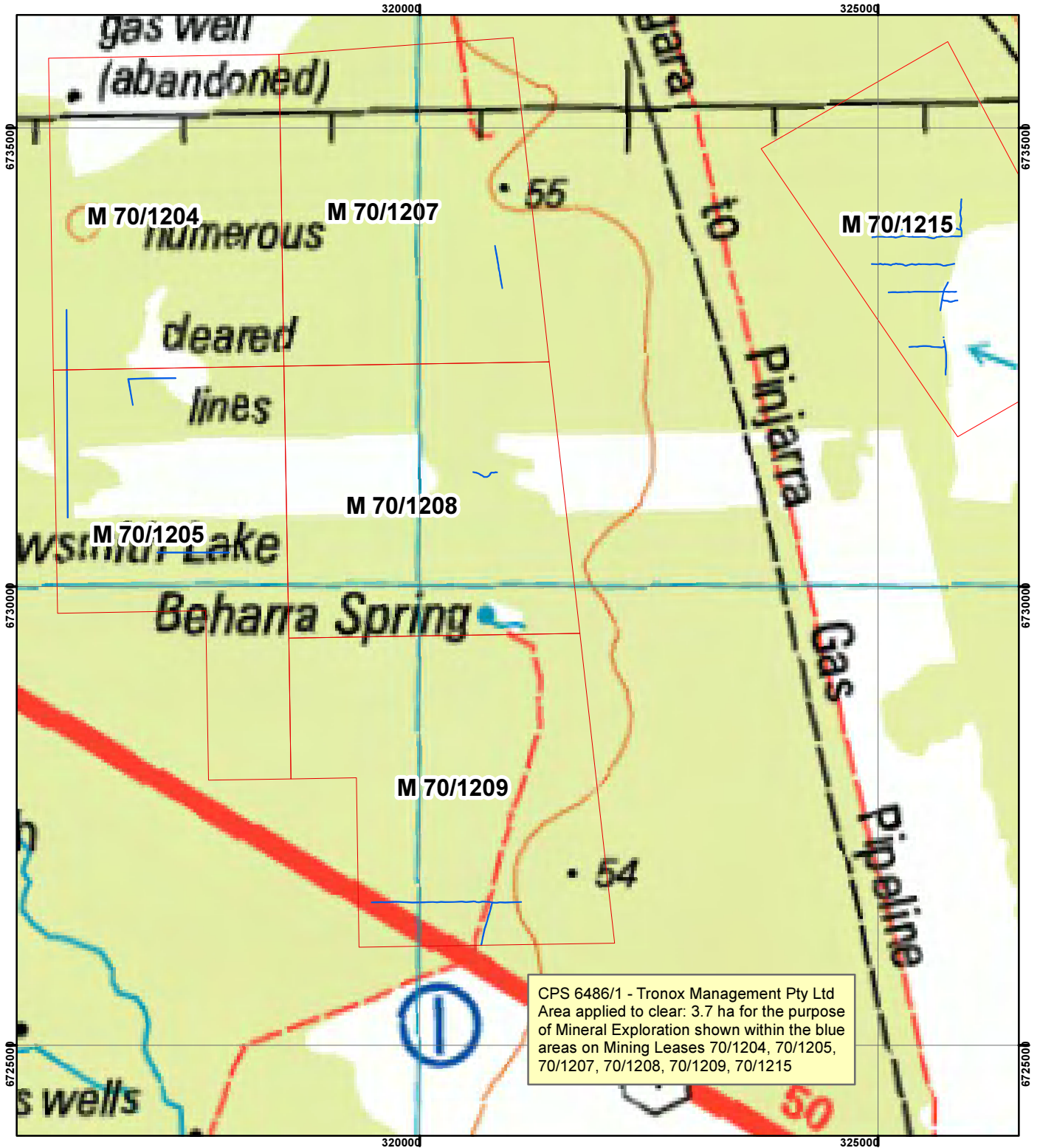

CPS 6486/1 - Tronox Management Pty Ltd
 Area applied to clear: 3.7 ha for the purpose
 of Mineral Exploration shown within the blue
 areas on Mining Leases 70/1204, 70/1205,
 70/1207, 70/1208, 70/1209, 70/1215

Legend

Mining Tenements

- M 70/1215
- M 70/1209
- M 70/1208
- M 70/1207
- M 70/1205
- M 70/1204
- CPS_6486

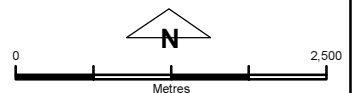

Geocentric Datum Australia 1994

Note: the data in this map have not been projected. This may result in geometric distortion or measurement inaccuracies.

..... Date.....
 Officer with delegated authority under Section 20 of
 the Environmental Protection Act 1986
 Information derived from this map should be
 confirmed with the data custodian acknowledged
 by the agency acronym in the legend.

