



CLEARING PERMIT

Granted under section 51E of the Environmental Protection Act 1986

PERMIT DETAILS

Area Permit Number: CPS 6612/1

File Number: DER2015/001400-1

Duration of Permit: 15 August 2015 to 15 August 2017

PERMIT HOLDER

Shire of Boyup Brook

LAND ON WHICH CLEARING IS TO BE DONE

Dinninup Road East road reserve (PIN 1392159, PIN 1392163 and PIN 1392165), Dinninup
Upper Blackwood Road reserve (PIN 1392162), Dinninup

AUTHORISED ACTIVITY

The Permit Holder shall not clear more than 0.118 hectares of native vegetation within the areas cross-hatched yellow on attached Plan 6612/1.

CONDITIONS

Nil.

A handwritten signature in black ink, appearing to read "M Warnock", written over a horizontal line.

M Warnock
SENIOR MANAGER
CLEARING REGULATION

*Officer delegated under Section 20
of the Environmental Protection Act 1986*

16 July 2015

PLAN 6612/1

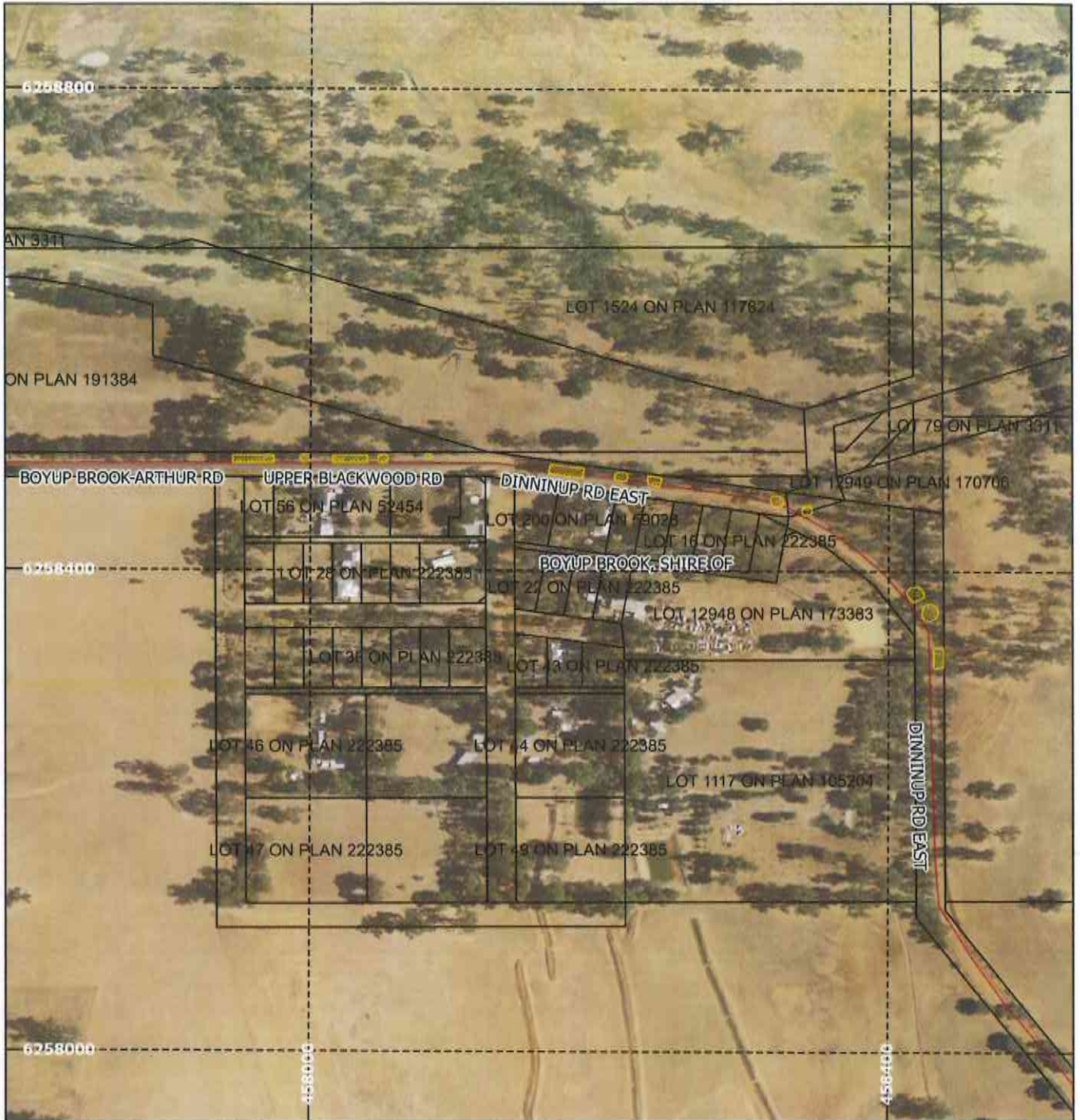

Legend

-  Areas approved to clear
-  Roads
-  Cadastre
-  local_gov_authority
-  Virtual Mosaic



1:3,000

MGA 94

Geocentric Datum of Australia 1994

M Warnock Date *16/7/15*
M Warnock

Officer with delegated authority under Section 20
of the Environmental Protection Act 1986



GOVERNMENT OF
WESTERN AUSTRALIA



1. Application details

1.1. Permit application details

Permit application No.: 6612/1
Permit type: Area Permit

1.2. Proponent details

Proponent's name: Shire of Boyup Brook

1.3. Property details

Property: Dinninup Road East road reserve – PIN 1392159, Dinninup
Dinninup Road East road reserve – PIN 1392165, Dinninup
Dinninup Road East road reserve – PIN 1392163, Dinninup
Upper Blackwood Road reserve – PIN 1392162, Dinninup

Local Government Authority: Shire of Boyup Brook
DER Region: Greater Swan
DPaW District: Blackwood
LCDC: Boyup Brook
Localities: Dinninup

1.4. Application

Clearing Area (ha)	No. Trees	Method of Clearing	For the purpose of:
0.118	0	Mechanical Removal	Road widening and realignment

1.5. Decision on application

Decision on Permit Application: Grant
Decision Date: 16 July 2015

2. Site Information

2.1. Existing environment and information

2.1.1. Description of the native vegetation under application

Vegetation Description

One Beard vegetation association and one Mattiske vegetation complex has been mapped within the application area.

Beard Vegetation Association 4 is described as Medium woodland; marri & wandoo (Shepherd et al, 2001).

Mattiske vegetation complex NWf2 is described as a woodland of *Eucalyptus rudis*-*Eucalyptus patens* with occasional *Eucalyptus wandoo* on footslopes on valley slopes in the semiarid zone (Mattiske and Havel, 1998).

The Shire of Boyup Brook (2015) advises that vegetation within and surrounding the application area consists of sparse *Eucalyptus wandoo* and *Eucalyptus rudis* trees, with occasional introduced *Pinus* species. Where understorey is present, it comprises *Gastrolobium praemorsum*, *Xanthorrhoea preissii* and *Dianella revoluta* with a 30-70 per cent weed cover of veldt grass, wild oats and bridal creeper in parts.

Vegetation Condition

Degraded: Structure severely disturbed; regeneration to good condition requires intensive management (Keighery, 1994).

3. Assessment of application against clearing principles

Comments The Shire of Boyup Brook has applied to clear up to 0.118 hectares of native vegetation within Upper Blackwood Road and Dinninup Road East road reserves for the purpose of road widening and realignment.

Consideration has been given to impacts to biodiversity, significant fauna habitat, rare flora, threatened

ecological communities, remnant vegetation values, watercourses, land degradation, surface water quality, groundwater quality, and flooding. The assessment has found that the clearing under application is not likely to be at variance to any of the clearing principles.

No submissions relating to this application have been received.

Methodology GIS Databases:
- DPaW Tenure
- Hydrology, linear
- Groundwater salinity, statewide
- Pre-European Vegetation
- SAC Biodatasets Accessed March 2015
- Soils, statewide

4. References

- Shire of Boyup Brook (2015) Preliminary assessment of roadside vegetation along Blackwood Upper and Dinninup East Rd. Report prepared by Jodi Wildy for the Shire of Boyup Brook.
- Keighery, B.J. (1994) Bushland Plant Survey: A Guide to Plant Community Survey for the Community. Wildflower Society of WA (Inc). Nedlands, Western Australia.
- Mattiske, E.M. and Havel, J.J. (1998) Vegetation Complexes of the South-west Forest Region of Western Australia. Maps and report prepared as part of the Regional Forest Agreement, Western Australia for the Department of Conservation and Land Management and Environment Australia.
- Shepherd, D.P., Beeston, G.R., and Hopkins, A.J.M. (2001), Native Vegetation in Western Australia. Technical Report 249. Department of Agriculture Western Australia, South Perth.