

SITE LOCATION

WALLAL DOWNS STATION



Grenleigh Pty Ltd
GROUNDWATER MONITORING SUMMARY 2013
WALLAL DOWNS

Figure 1

LOCATION AND STAGING BOUNDARY

Drawn: S. Burton
 Date: 6 May 2014

Project No. GREN002

PINPOINT CARTOGRAPHICS (08) 9562 7136

GREN002-01.dgn

- Legend**
- Current Clearing Envelope
 - Cadastral Boundary
 - Topographic Contour
 - Rocky Areas (Not Mapped - Indicative Only)
 - Existing Centre-Pivot Irrigator
 - Proposed Centre-Pivot Irrigator
 - + Existing Bore Location
 - + Proposed Bore Location
 - Cleared Area (156.2ha Approx.)
 - Proposed Clearing Area (148.0ha approx.)

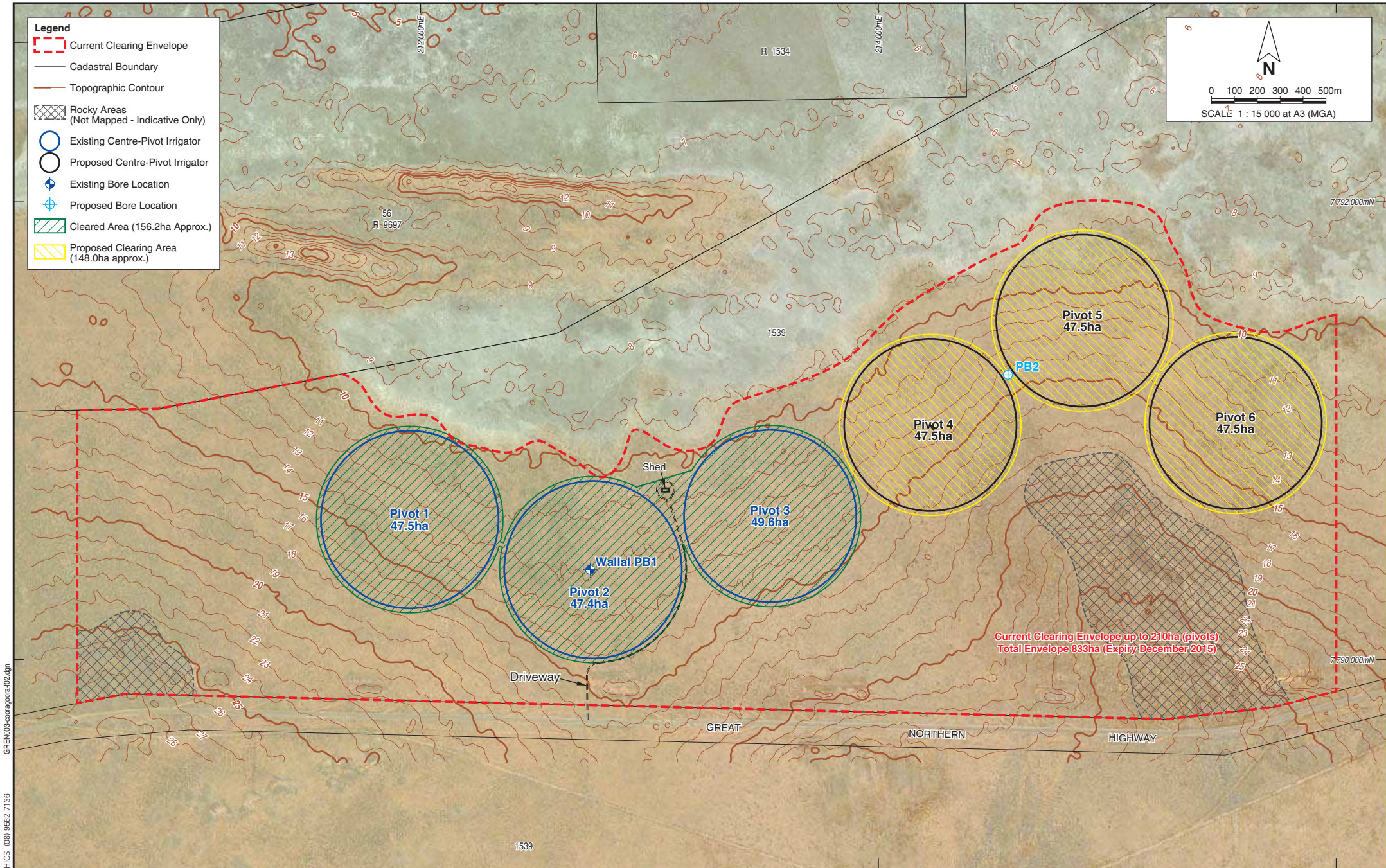
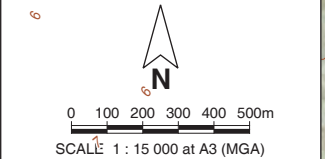

PINPOINT CARTOGRAPHICS (08) 9562 7136

CADASTRAL SOURCE: Landgate, May 2014.
 AERIAL PHOTOGRAPH SOURCE: Google Earth, flown December 2011.
 CONTOUR SOURCE: Interpreted from Landgate 10m DEM data, May 2014.

 <p>Project No. GRENO03</p>	<p>Grenleigh Pty Ltd COORAGOORA DEVELOPMENT PLANNING WALLAL DOWNS STATION</p> <p>COORAGOORA DEVELOPMENT PLAN 2015/2016</p>	<p>Figure 2</p> <p>Drawn: S. Burton Date: 28 Jul 2015</p>
--	---	---



Pivot 4 looking north



Pivot 4 looking east



Pivot 4 looking south



Pivot 4 looking west



Pivot 5 looking north



Pivot 5 looking east



Pivot 5 looking south



Pivot 5 looking west