

# CPS 6699/1 - Map a

506000

507000

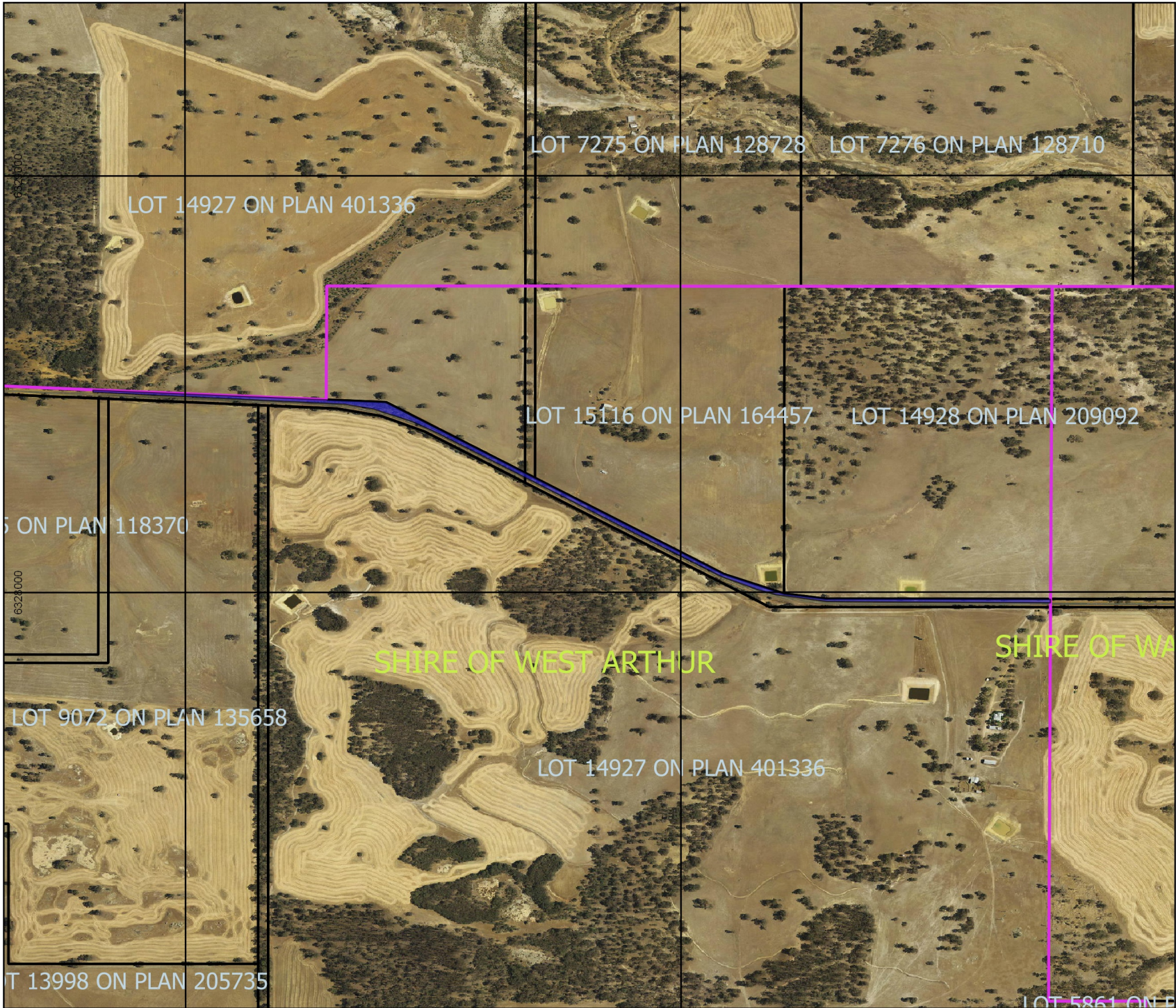

506000

507000

**Legend**

- Clearing Instruments Proposal
- LGA
- cadastre\_land\_tenure\_flattened
- Roads
- Virtual Mosaic

6329000

6328000

6324000

6320000

N

1:8,000

MGA 94  
Geocentric Datum of Australia 1994

.....Date.....

Officer with delegated authority under Section 20  
of the Environmental Protection Act 1986

GOVERNMENT OF  
WESTERN AUSTRALIA