

CPS 6794/1 - Barradale Sands Pty Ltd

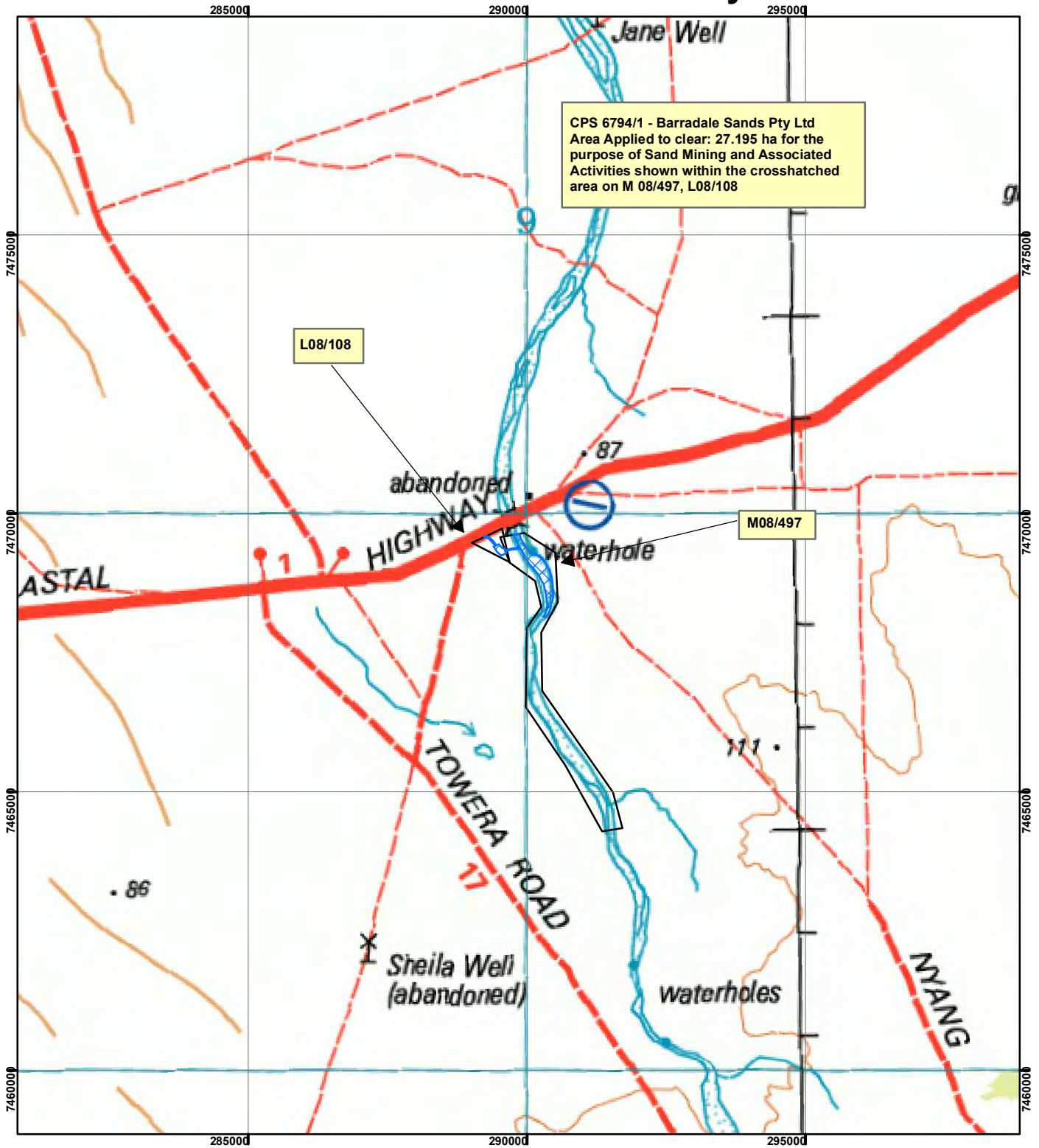

CPS 6794/1 - Barradale Sands Pty Ltd
 Area Applied to clear: 27.195 ha for the
 purpose of Sand Mining and Associated
 Activities shown within the crosshatched
 area on M 08/497, L08/108

L08/108

M08/497

Legend

Clearing Instrument

Mining Tenements

FMT_TENID

M 08/497

L 08/108

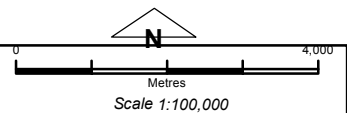

Geocentric Datum Australia 1994

Note: the data in this map have not been projected. This may result in geometric distortion or measurement inaccuracies.

..... Date

Officer with delegated authority under Section 20 of the Environmental Protection Act 1986

Information derived from this map should be confirmed with the data custodian acknowledged by the agency acronym in the legend.

