

PLAN 797/1 A

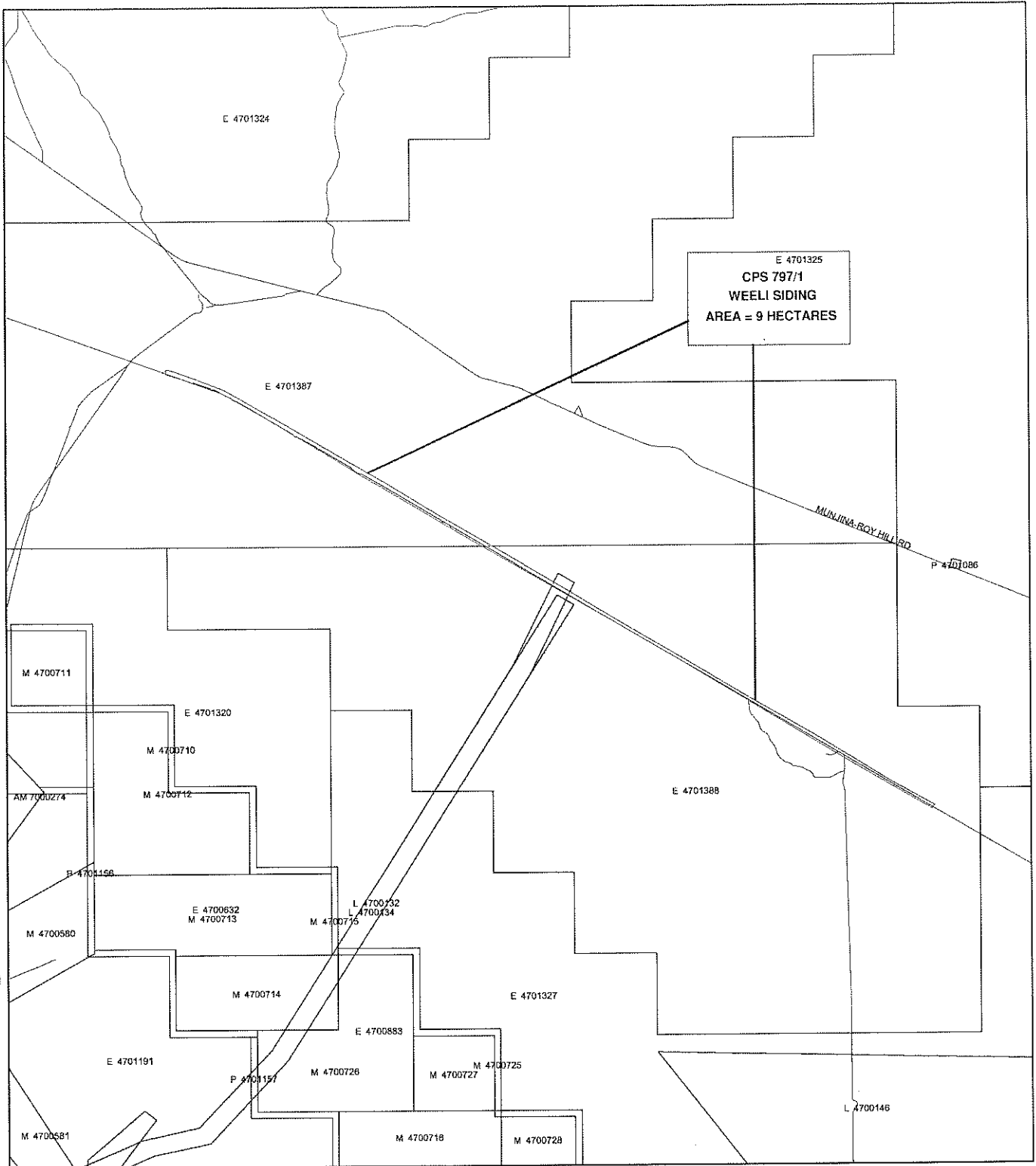

LEGEND

- Mining Tenements - DOIR 4/11/05
- Road Centrelines - DLI 1/5/04
- Cadastre - DLI 1/09/05
- Clearing Instruments
- Towns - DLI 8/04
- Areas Approved to Clear

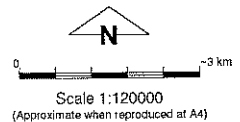

Geocentric Datum Australia 1994

Note: the data in this map have not been projected. This may result in geometric distortion or measurement inaccuracies.

[Signature] Date 17/11/05
GRAHAM COBBY
 Officer with delegated authority under Section 20 of the Environmental Protection Act 1986

Information derived from this map should be confirmed with the data custodian acknowledged by the agency acronym in the legend.



PLAN 797/1 B

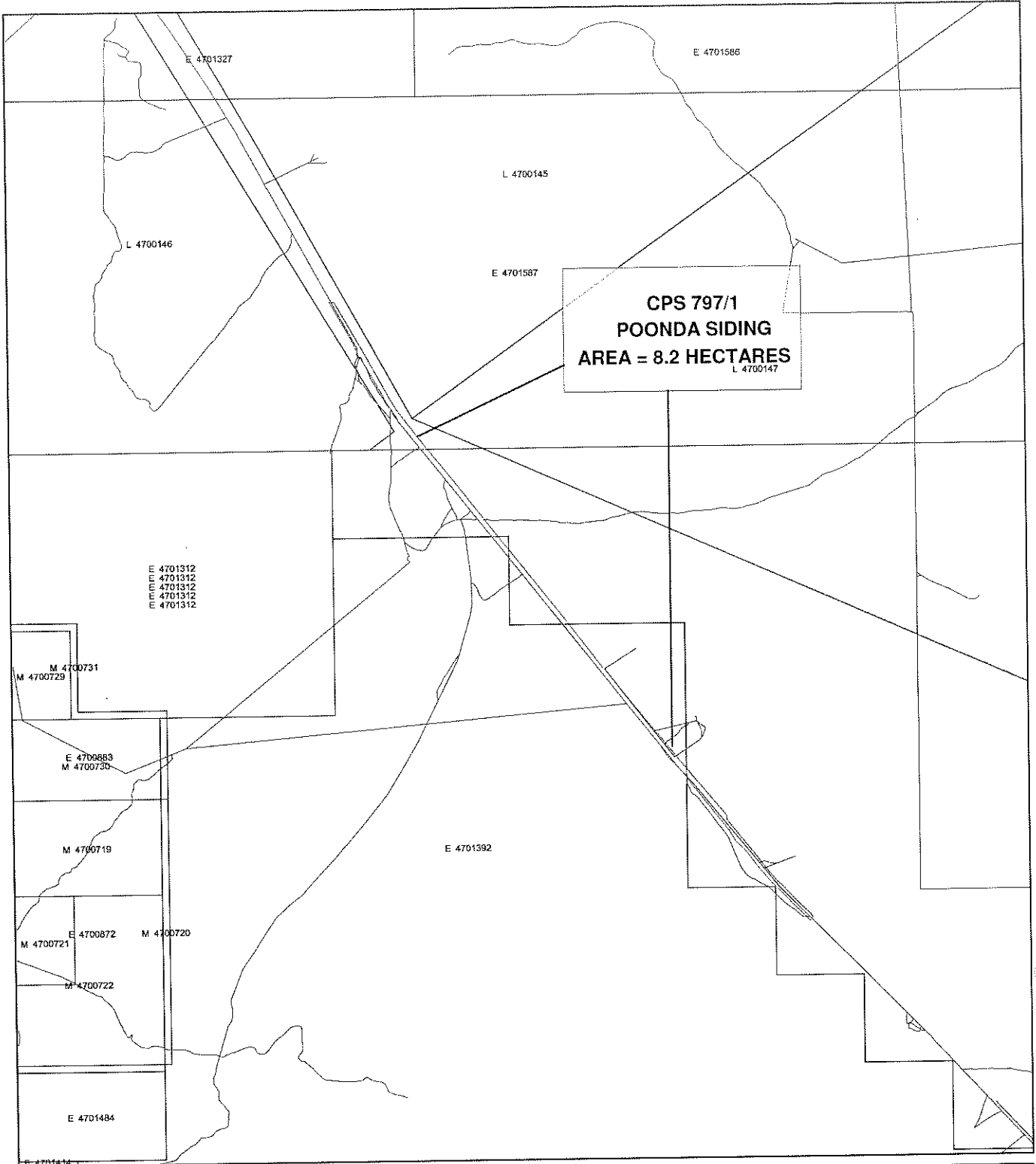

LEGEND

- Mining Tenements - DOIR 4/11/05
- Road Centrelines - DL1 1/5/04
- Cadastre - DL1 1/09/05
- Clearing Instruments
- Towns - DL1 8/04
- Areas Approved to Clear

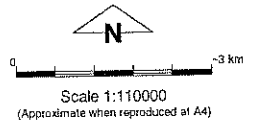

Geocentric Datum Australia 1994

Note: the data in this map have not been projected. This may result in geometric distortion or measurement inaccuracies.

..... Date 17/11/05
BRADY COBBY
 Officer with delegated authority under Section 20 of the Environmental Protection Act 1986

Information derived from this map should be confirmed with the data custodian acknowledged by the agency acronym in the legend.



PLAN 797/1 C

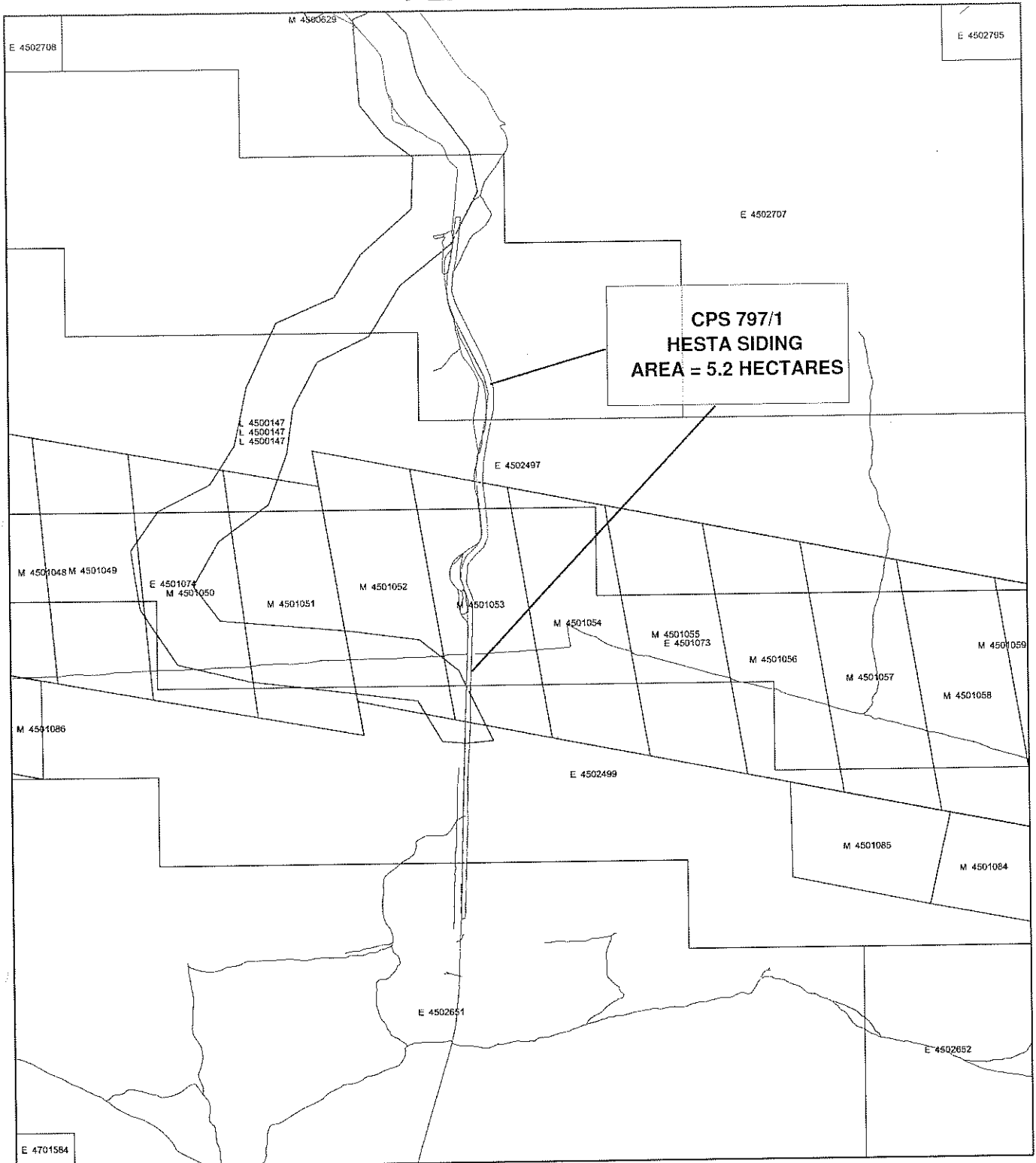

LEGEND

- Mining Tenements - DOIR 4/11/05
- Road Centrelines - DLI 1/5/04
- Cadastre - DLI 1/09/05
- Towns - DLI 8/04
- Clearing Instruments**
- Areas Approved to Clear

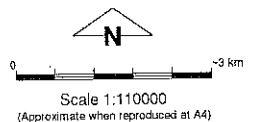

Geocentric Datum Australia 1994
 Note: the data in this plan have not been projected. This may result in geometric distortion or measurement inaccuracies.

..... Date 17/11/05
GRAHAM COBBY
 Officer with delegated authority under Section 20 of the Environmental Protection Act 1986

Information derived from this map should be confirmed with the data custodian acknowledged by the agency acronym in the legend.



