

DESIGN SAFE - WORK SAFE - HOME SAFE

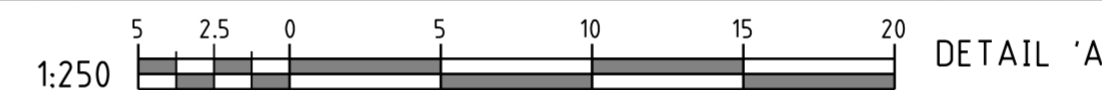

LEGEND	
HV CABLES	
CN53 - 400mm ² (3X1c)	
CN49 - 240mm ² (3X1c)	
CN48 - 185mm ² (3X1c)	
CN50 - 95mm ² (3X1c)	
CN51 - 50mm ² (3X1c)	
CN51 - 50mm ² (1c)	
CN46 - 35mm ² (3X1c)	
CN47 - 35mm ² (1c)	
EXISTING HV CABLES (SIZE AND TYPE INDICATED)	
LV-SL CABLES	
CN45 - 240mm ² (1x3c)	
CN44 - 185mm ² (1x3c)	
CN43 - 120mm ² (1x3c)	
CN42 - 25mm ² (1x3c)	
CN41 - 16mm ² SL (1c)	
40 C PILOT	
EXISTING LV CABLES (SIZE AND TYPE INDICATED)	
STREET LIGHTS	
	42W CFL
	80W MV
	125W MV
	70W HPS
	150W HPS
	250W HPS
	70W MH
	150W MH
	250W MH
	250W HPS AERODROME
EXISTING	
	42W CFL
	80W MV
	125W MV
	70W HPS
	150W HPS
	250W HPS
	70W MH
	150W MH
	250W MH
	250W HPS AERODROME
LEGEND DEFINES TYPE & WATTAGE - NOT COLOUR	
PILLARS / PITS / ETC	
	MINI (WORKING END)
	UNIVERSAL
	MINI
	LINK
	CABLE MARKER U/G
	UMS PIT
	UTILITIES PIT
	100/200AMP CUTOFF
	CONDUIT / POLY PIPE
	Serviced Un-energised Lot

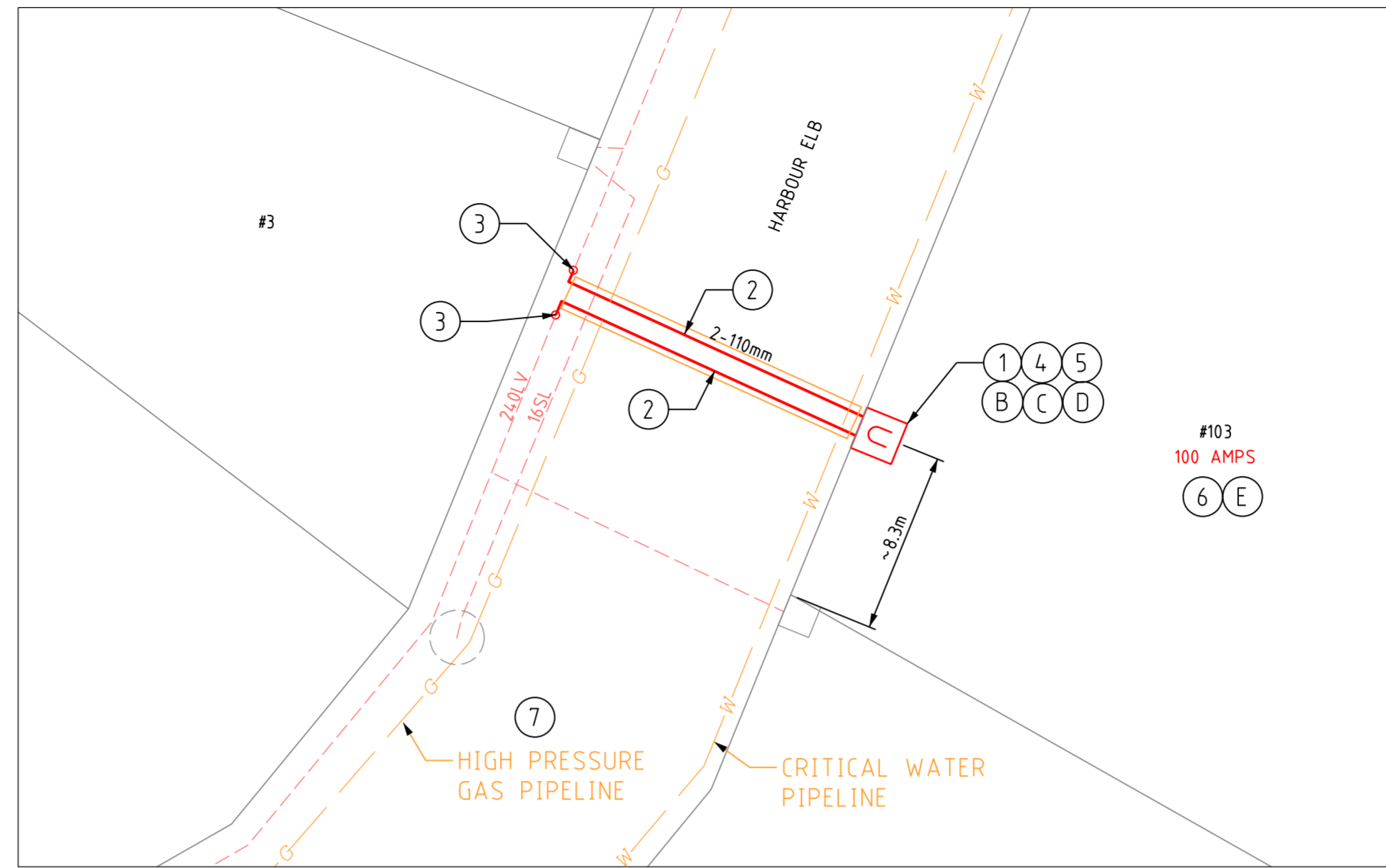
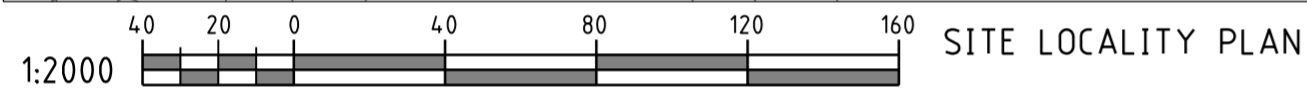
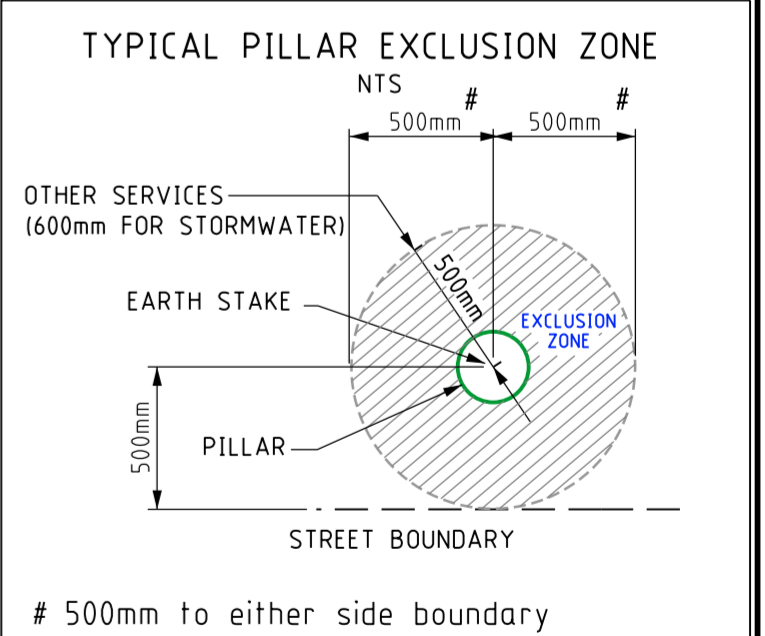
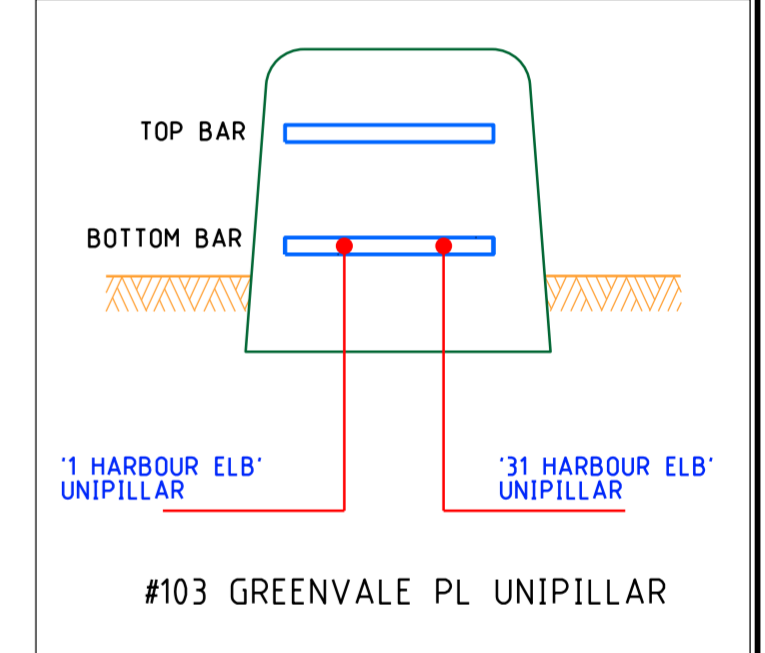

CUSTOMER CONTACT DETAILS
 COMPANY NAME: IQEC
 CONTACT: GRAHAM IRVINE TEL: 0427 463 456

**HIGH PRESSURE GAS
IN VICINITY OF WORKS**

**CRITICAL WATER PIPELINE
IN VICINITY OF WORKS**



WESTERN POWER SCOPE OF WORK (SHEET 1)

1. INSTALL NEW UNIPILLAR IN PROPERTY #103 GREENVALE PL AS PER EXCLUSION ZONE DETAIL (WADCM CL. 12.5.3).
CU: LU11 x 1
2. INSTALL NEW 2 x 240LV CABLE FROM EXISTING 240LV CABLE TO NEW #103 GREENVALE PL UNIPILLAR.
CU: CN45 x 50m, CN73 x 6, CN54 x 2
3. CUT EXISTING 240LV CABLE AND STRAIGHT JOINT BOTH ENDS TO NEW 2 x 240LV CABLES.
CU: LU2 x 2
4. TERMINATE NEW 2 x 240LV CABLE TO NEW UNIPILLAR.
CU: LU7 x 2
5. TERMINATE CUSTOMER'S CABLE TO UNIPILLAR BACK BLOCKS IN CONJUNCTION WITH CUSTOMER'S ELECTRICAL CONTRACTOR.
6. INSTALL DIRECT METER IN CUSTOMER'S NEW SWITCHBOARD.
7. WHEN EXCAVATING NEAR HIGH PRESSURE GAS PIPELINE, THE PIPELINE OWNER / OPERATOR MUST BE INFORMED BEFORE ANY EXCAVATION COMMENCES. ENSURE THAT AN OBSERVER FROM THE PIPELINE OPERATOR IS PRESENT WHEN EXCAVATION COMMENCES.
8. ENVIRONMENTAL FILTER CHECKED

THE FOLLOWING ENVIRONMENTAL ISSUES HAVE BEEN IDENTIFIED FOR THIS PROJECT:

1. THREATENED ECOLOGICAL COMMUNITIES. NO NATIVE VEGETATION MAY BE CLEARED OR DAMAGED WITHOUT A PERMIT. CUSTOMER IS TO OBTAIN A CLEARING PERMIT AND PROVIDE EVIDENCE TO WESTERN POWER FOR RECORDS.
2. ACID SULPHATE SOIL. THE GROUNDWATER AT THIS SITE IS GREATER THAN 4 METRES (16 METRES) BELOW THE SURFACE AND THEREFORE ASS IS LOW RISK. ALL EXCAVATIONS NEED TO BE BACKFILLED WITHIN 18 HOURS.

PLEASE REFER TO THE ENVIRONMENTAL DRAWING (SHEET 2) FOR MORE INFORMATION.

CUSTOMER SCOPE OF WORK (SHEET 1)

- A. THIS DRAWING IS TO BE READ IN CONJUNCTION WITH THE WESTERN AUSTRALIAN DISTRIBUTION CONNECTIONS MANUAL.
- B. PILLAR EXCLUSION ZONE TO BE PREPARED AS PER THE WESTERN AUSTRALIAN DISTRIBUTION CONNECTIONS MANUAL CLAUSE 12.5.3. THIS INCLUDES, BUT IS NOT LIMITED TO THE FOLLOWING:
 1. PEGGING THE PILLAR LOCATION AND ADJACENT BOUNDARY LOCATION PRIOR TO CONSTRUCTION.
 2. ONLY EASILY REMOVABLE SURFACE TREATMENT IS TO BE INSTALLED IN THIS AREA, SUCH AS BRICK PAVING.
 3. CLEAR OF ALL SERVICES.
 4. LOCATED 300mm ABOVE 100 YEAR FLOOD LEVEL AND NOT IN A PRECARIOUS POSITION.
- C. CUSTOMER MUST COMPLY WITH POWER QUALITY LIMITS AS PER SA/SNZ TS IEC 61000.3.5 AND WESTERN POWER TECHNICAL REQUIREMENTS.
- D. CUSTOMER IS RESPONSIBLE TO ARRANGE FOR AN APPROPRIATELY ACCREDITED ELECTRICAL CONTRACTOR, TO INSTALL CONSUMER MAINS FROM CUSTOMER METER BOX TO THE UNIPILLAR. MAX SIZE CONSUMER MAINS THAT CAN BE TERMINATED TO UNIPILLAR BACK BLOCKS IS 35mm²/PHASE.
- E. ENVIRONMENTAL ISSUES IDENTIFIED: WORK AREA IS IN THE VICINITY OF THREATENED ECOLOGICAL COMMUNITIES. NO NATIVE VEGETATION MAY BE CLEARED OR DAMAGED WITHOUT A PERMIT. CUSTOMER IS TO OBTAIN A CLEARING PERMIT AND PROVIDE EVIDENCE TO WESTERN POWER. REFER TO ENVIRONMENTAL DRAWING (SHEET 2) FOR MORE INFORMATION.

UPGRADE COMMERCIAL SUPPLY
 100 AMPS 22kV 415V
 #103 GREENVALE PL, BANKSIA GROVE
 DESIGN DRAWING

DESIGNER: NORTH COUNTRY DESIGN	DRAWING NUMBER
TEL: 13 10 87	MP186731
DATE: 10/19 SCALE: @ A2	
GEO REF: Lat. - 31°41'49" S Long. - 115°48'49" E	SHEET 01 OF 02
MAP REF:	REV: A ORIGINAL SIZE - A2

Rev.	REVISIONS	DRN	DATE	FILE REFERENCE DETAILS
A	APPROVED FOR CONSTRUCTION	A.B	10/19	DESIGN DRAWING EDM#: 50558225
1	ISSUED FOR ENGINEERING REVIEW	A.B	10/19	ENVIRONMENTAL ASSESSMENT EDM#: 50722479 HAZARD MANAGEMENT REGISTER DM#: 50545417

DESIGN SAFE - WORK SAFE - HOME SAFE

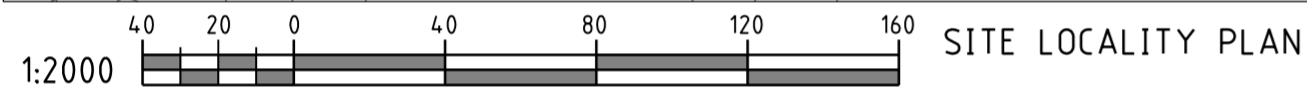
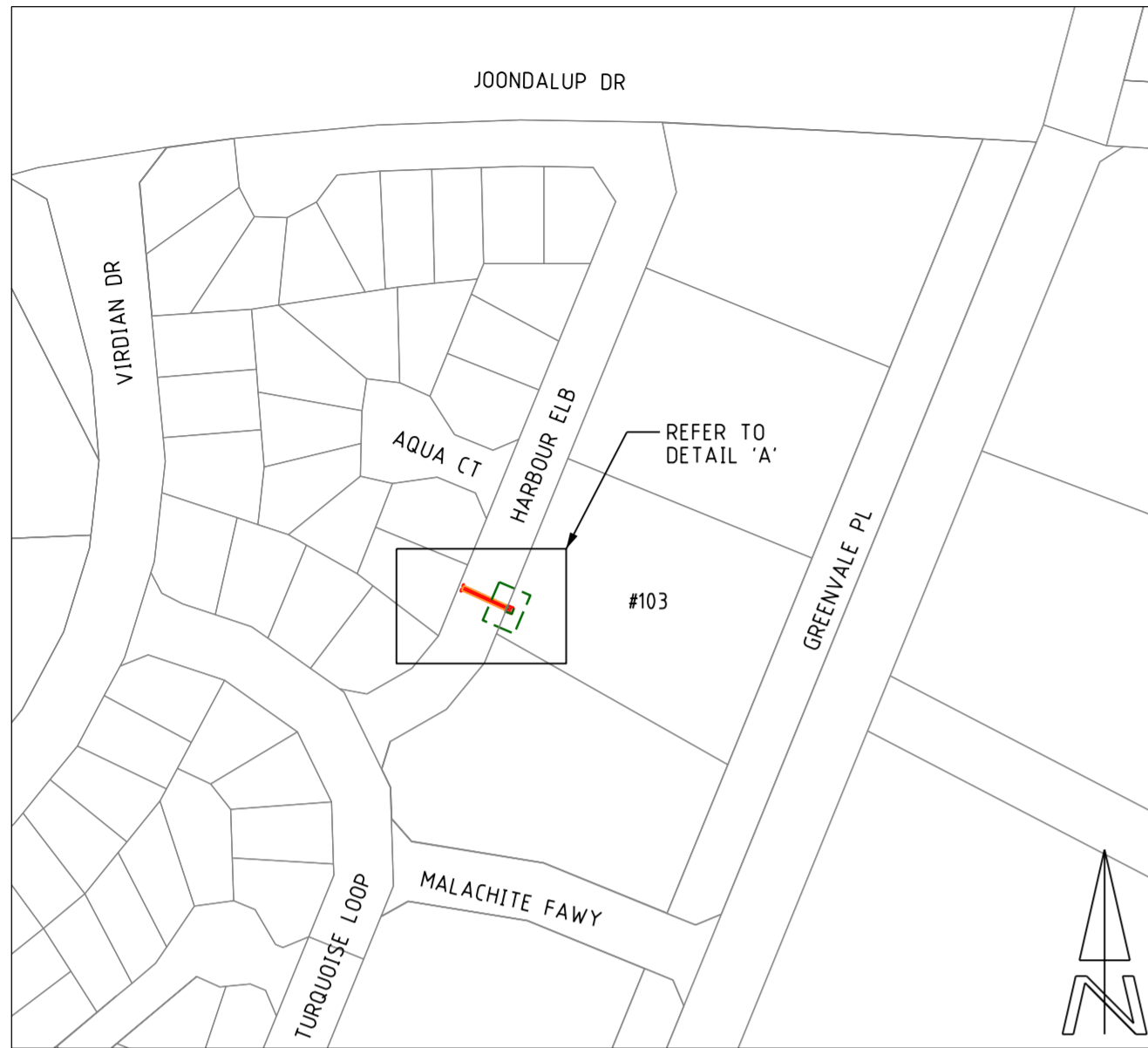

DETAIL 'A'
CLEARING PERMIT AND CLEARING REQUIRED DETAIL

LEGEND	
HV CABLES	
CN53 - 400mm2 (3X1c)	
CN49 - 240mm2 (3X1c)	
CN48 - 185mm2 (3X1c)	
CN50 - 95mm2 (3X1c)	
CN51 - 50mm2 (3X1c)	
CN51 - 50mm2 (1c)	
CN46 - 35mm2 (3X1c)	
CN47 - 35mm2 (1c)	
EXISTING HV CABLES (SIZE AND TYPE INDICATED)	
LV-SL CABLES	
CN45 - 240mm2 (1x3c)	
CN44 - 185mm2 (1x3c)	
CN43 - 120mm2 (1x3c)	
CN42 - 25mm2 (1x3c)	
CN41 - 16mm2 SL (1c)	
40 C PILOT	
EXISTING LV CABLES (SIZE AND TYPE INDICATED)	
STREET LIGHTS	
42W CFL	70W HPS
80W MV	150W HPS
125W MV	250W HPS
70W MH	150W MH
250W MH	250W HPS AERODROME
LEGEND DEFINES TYPE & WATTAGE - NOT COLOUR	
PILLARS / PITS / ETC	
MINI (WORKING END)	UMS PIT
UNIVERSAL	UTILITIES PIT
MINI	100/200AMP CUTOUT
LINK	CONDUIT / POLY PIPE
CABLE MARKER U/G	Serviced Un-energised Lot

VEGETATION INSTRUCTION

With regard to your requested works, it has been identified by Western Power that the clearing or potential clearing is required to facilitate the connection.

The Department of Water and Environmental Regulation (DWER) administers the clearing provisions of the Environmental Protection Act 1986 (EP Act). Under the EP Act, clearing of native vegetation is an offence unless it is done under the authority of a clearing permit or an exemption applies. Note there are some circumstances where exemptions are granted, Advice on relevant exemptions can be obtained via DWER's Guide 1 - Exemptions and regulations for clearing native vegetation and clarification can be sought via emailing DWER directly via info@dwer.wa.gov.au.

Detail A of 108m2 is the area in which a clearing permit is required, which will allow for the works to proceed. The area that is defined is the operational potential impact of performing the installation works. This permit allows for inadvertent destruction of vegetation and is not required by the landowner to clear prior to works proceeding.

Detail B is the area within Detail A in which you will have to arrange to clear/remove all vegetation and prepare the site as specified in the Design drawing MP186731 on Sheet 1.

To assist in the above task, Western Power recommends that a Form C1 (Area Permit) be submitted to the DWER. (Found via www.der.wa.gov.au under the Clearing Permit tab) Please attach this sheet which should contain the relevant information to fill out the form. The application cost is expected to be \$400 with an expected response time of typically 60 working days.

Please note that DWER may identify that the clearing has significant impacts and there may be additional requirements before or after DWER issue a clearing permit that may impact the delivery date. These may include flora or fauna survey requirements and hygiene management plans.

Please ensure you provide Western Power with a copy of the signed clearing permit to Western Power Construction manager as soon as practicable for review and suitability confirmation.



CUSTOMER CONTACT DETAILS	
COMPANY NAME: IQEC	TEL: 0427 463 456
CONTACT: GRAHAM IRVINE	

Rev.	REVISIONS	DRN	DATE	FILE REFERENCE DETAILS
A	APPROVED FOR CONSTRUCTION	A.B	10/19	ENVIRONMENTAL ASSESSMENT EDM#: 50722479
1	ISSUED FOR ENGINEERING REVIEW	A.B	10/19	HAZARD MANAGEMENT REGISTER DM#: 50545417
				DESIGN DRAWING EDM#: 50558225

UPGRADE COMMERCIAL SUPPLY
100 AMPS 22kV 415V
 #103 GREENVALE PL, BANKSIA GROVE
 ENVIRONMENTAL DRAWING

DESIGNER: NORTH COUNTRY DESIGN	DRAWING NUMBER
DATE: 10/19	SCALE: @ A2
MP186731	
SHEET 02 OF 02	
MAP REF:	REV: A ORIGINAL SIZE - A2