

LEGEND

- MAIN SWITCH BOARD.
- PROPOSED NEW LEVELS.
- EXISTING LEVELS.
- PROPOSED DEVELOPMENT.
- EXTENT OF EXPOSED AGGREGATE CONCRETE PAVING ON CLEAN COMPACTED FILL TO EVEN GRADE FALLS AS SHOWN.
- EXTENT OF RED/ BROWN BITUMEN PAVING ON CLEAN COMPACTED FILL TO EVEN GRADE FALLS AS SHOWN.
- EXTENT OF LANDSCAPING.
- BOLLARD - REFER TO SPECIFICATION.
- HOSE COCK - REFER TO HYDRAULIC DWGS.
- SOAKWELL WITH GRATE WITH FALLS.
- BARRIER CONCRETE KERB UNLESS NOTED OTHERWISE.
- MARKED CARBAYS.

- LEGEND
- ACSB AC SUMP BOX. REFER H.S. DRAWINGS
 - BOL-01 BOLLARD. REFER TO TYPICAL DETAIL. SELECTED PAINT FINISH.
 - DPSB DOWNPIPE SUMP BOX REFER H.S. DRAWINGS
 - HC HOSE COCK. REFER H.S. DRAWINGS
 - IWSP INDUSTRIAL WASTE SAMPLING POINT. REFER H.S. DRAWINGS
 - IWT INDUSTRIAL WASTE TRAP. REFER H.S. DRAWINGS
 - RP RELIEF POINT. REFER H.S. DRAWINGS
 - SMSB SITE MAIN SWITCHBOARD. REFER TO ELECTRICAL DRAWINGS.

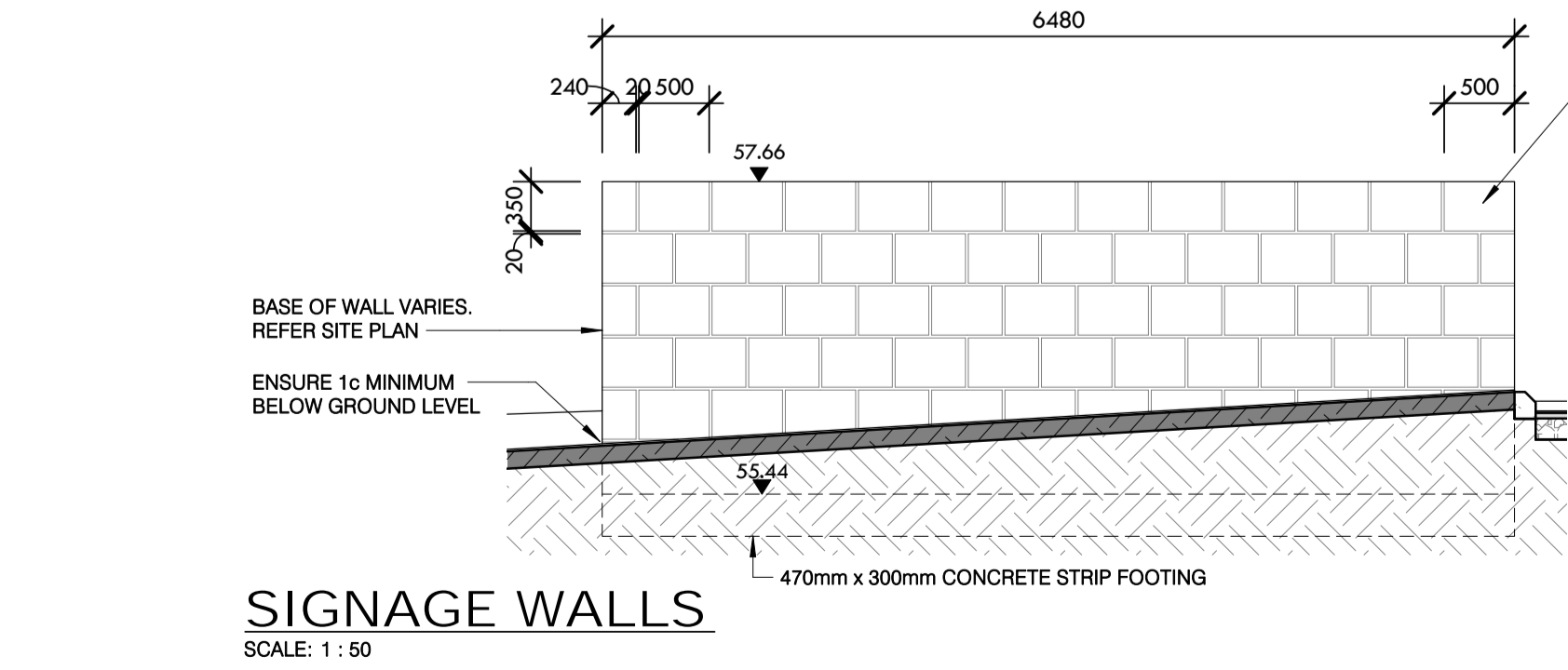
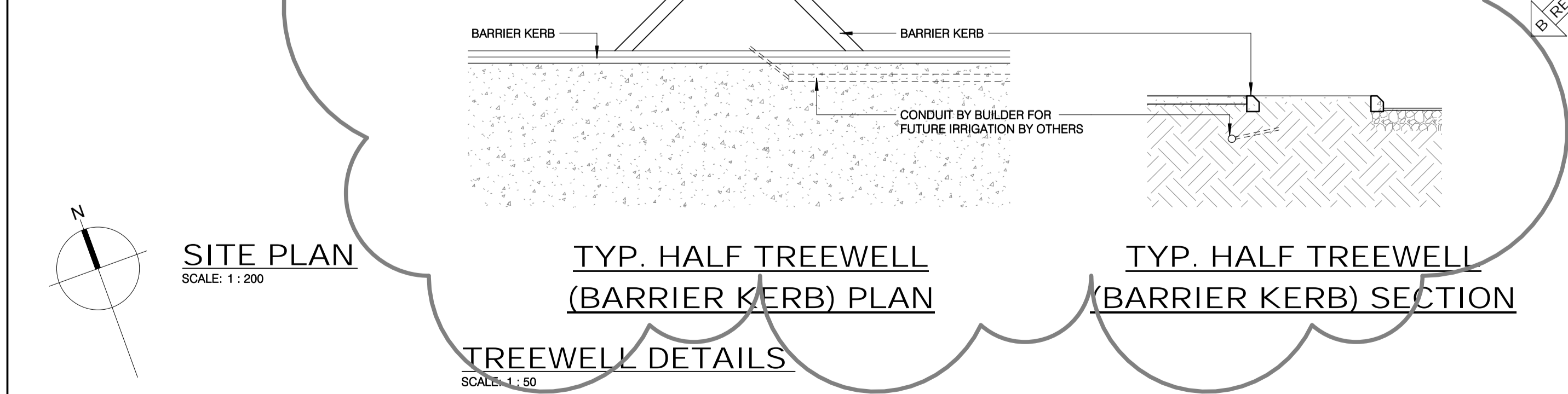
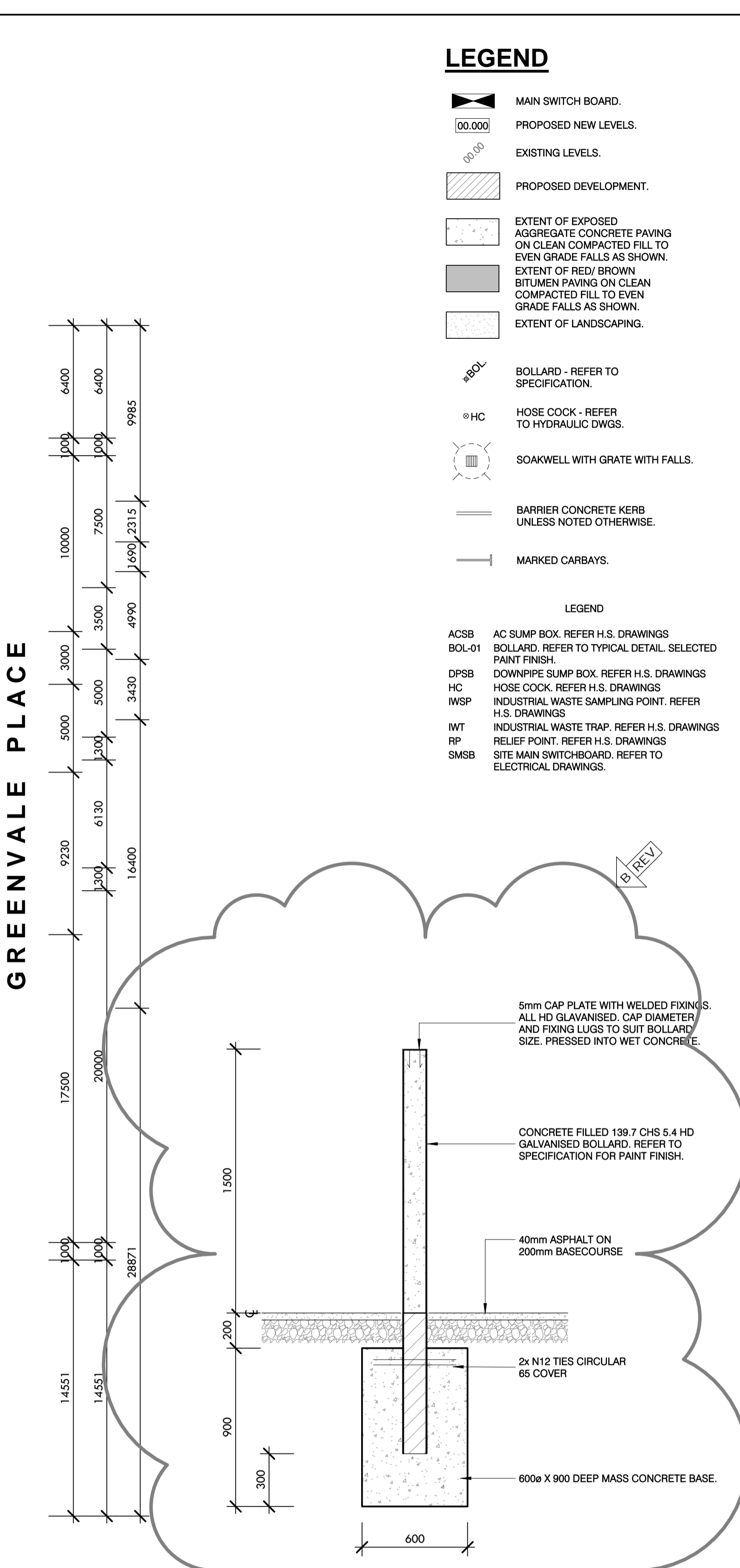
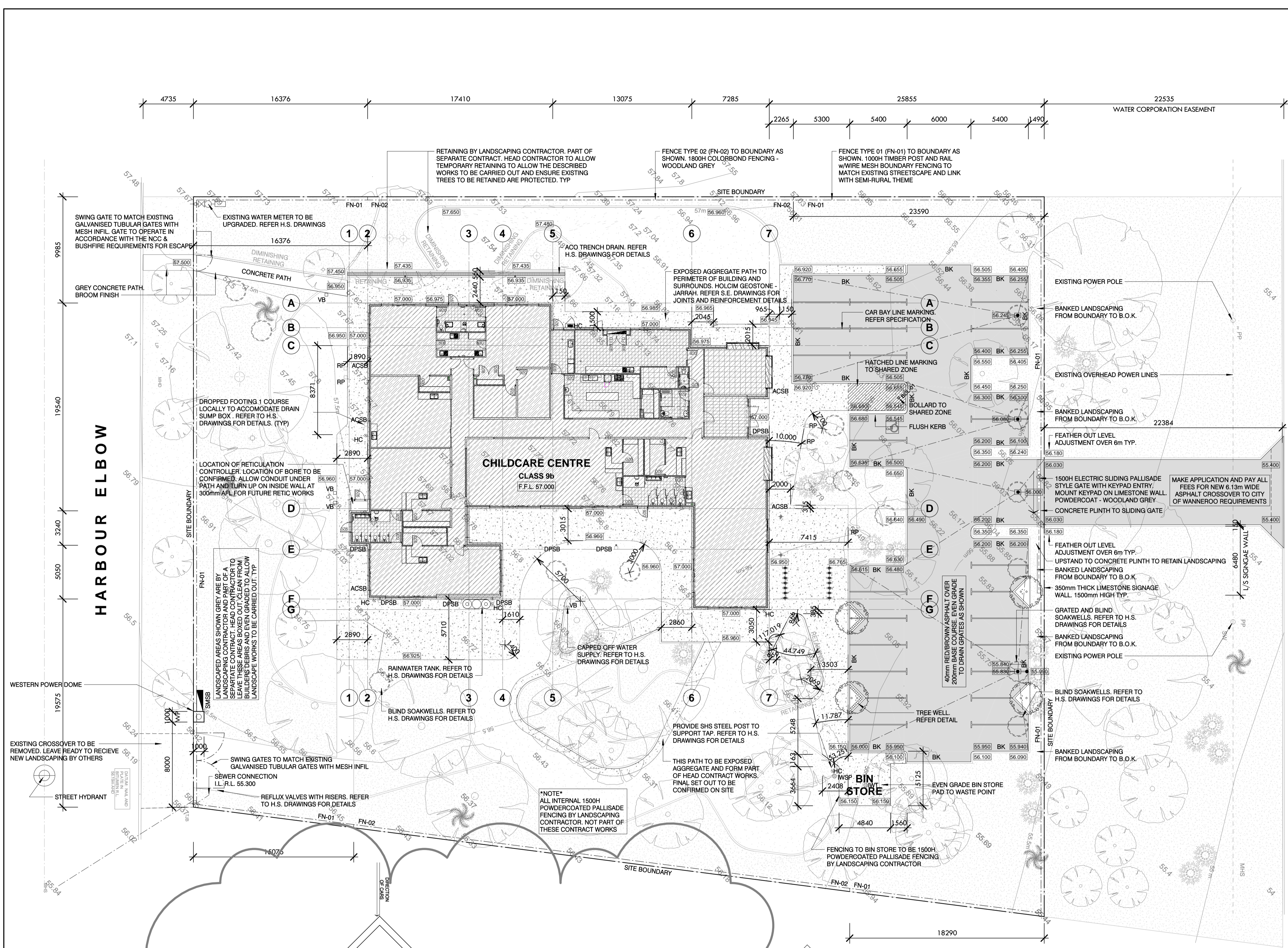

SITE PLAN
SCALE: 1:200

Member of the Association of Consulting Architects
NATIONAL ASSOCIATION OF BUILDING DESIGNERS
 nabd
 BDAWA

CHILDCARE CENTRE
 103 GREENVALE PLACE, BANKSIA GROVE
 HINDLE PROPERTIES PTY. LTD.

Suite 2, Ground Floor
 437 Roberts Road, Subiaco
 WA 6008
 08 9381 8511
 08 9388 1339
 ma@meyershircore.com.au
 www.meyershircore.com.au

meyer shircore architects

Date: JUNE 2019
 Scale: As indicated @ A1
 Drawn by: GD
 Checked: MJ

DWG No: A102 Rev NoB

8450

REV	DATE	DESCRIPTION
B	12.09.2019	DETAIL UPDATED
A	19.08.2019	ISSUED FOR TENDER
P2	19.07.2019	CO-ORDINATION
P1	24.06.2019	ISSUED FOR PRELIMINARY

ISSUED FOR TENDER

SITE PLAN

THIS DRAWING IS THE PROPERTY OF MEYER SHIRCORE AND ASSOCIATES AND MAY NOT BE COPIED OR USED WITHOUT WRITTEN CONSENT BY THE DESIGN CONSULTANTS. CHECK ALL DIMENSIONS BEFORE FABRICATION AND AGAINST ON-SITE DIMENSIONS.