

2020-2021 Darkan South (Hill)

SLK 3.70-4.75 (Trees removed between Lat -33.37461, Long 116.73302: E6,307,150. N 475,168) to (Lat -33.37555, Long 116.73439: E6,306,574. N 475,293)

Works: Widen shoulders 1.5metres on both west and east boundaries due to narrow road around slight bend, hill on western side and drop off on eastern side.

Clearing: 3 metres from edge of bitumen west and east sides but not continuously on both sides. Minimum vegetation removal if majority of width is taken from west side.

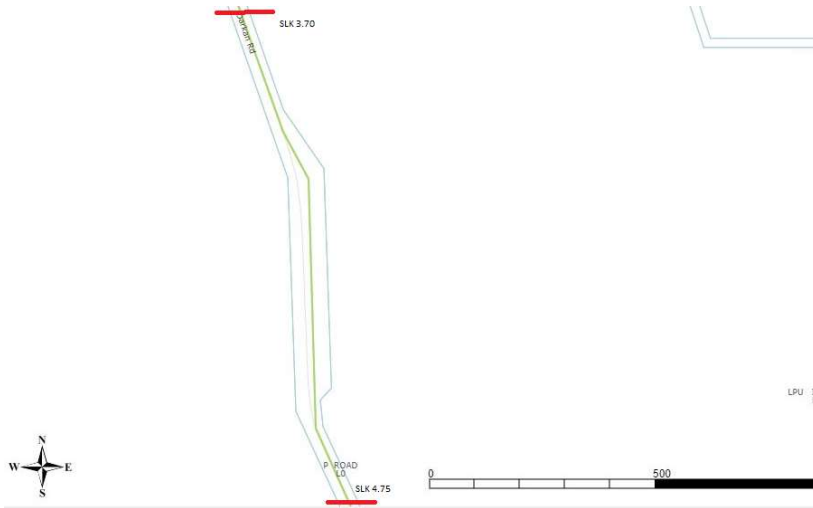

2020-2021 Darkan South (Sliplane)

SLK 7.10-7.30 (Trees removed between Lat -33.39966, Long 116.74601: E6,304,377. N 476,331) to (Lat -33.40450, Long 116.74789: E6,303,840. N 476,556)

Works: Widen road on west side 3.5 metres to create a single sliplane, from intersection with Capercup North Road, north for 200metres. Heavy vehicles enter from Capercup North merge with Darkan South then approach a gentle hill.

Clearing: 6.5 metres from edge of bitumen. Approximately 11 white gums and two jam trees require removing.

