



# Clearing Permit

## Community Precinct

### Lot 73 Fouracre St

### Waroona

# Index

## Contents

1. Background.....	3
2. Project Brief.....	3
3. Clearing Period.....	3
4. Calculations.....	3
5. Aerial Map.....	4
6. Photos and Additional Information .....	4

## 1. Background

The Shire of Waroona have begun preliminary works on a new major project and are requesting approval to remove 5 trees. The trees have been identified to be removed to mitigate risk to public safety and infrastructure damage. Three *Corymbia Calophylla* are very distressed and a possible threat to the public safety. See attached Report from Petes Tree Worx.

## 2. Project Brief

The Community Precinct R14841 Lot number 73 Fouracre Street will be located opposite the Memorial Hall on land between Southwest Highway and Fouracre Street, extending from the southern side of the Vibe Petrol Station down and across to where the former Scout Hall is located. The reserve along Fouracre Street from Palmerston Street to Coronation Road is also included in the planning for the Precinct.

Building and construction is planned to commence in the last quarter of 2022 and may take around 12 months to complete.

The Community Precinct will include:

- Playgrounds with seating and shade that will be a great spot for all the young families.
- Open grassed areas for community gatherings, events, movie nights and markets
- An all-ages skate park and pump track
- The Big Shed will be used for all sorts of community activities
- Accessible toilets, pathways, shelters, BBQs and seating
- Retention of all the big trees where possible and replanting.

## 3. Clearing Period

It is expected the clearing will commence October 2022 and be completed in November 2022 however to cover unforeseen circumstances the requested permit validity period is until April 2023

## 4. Calculations

A total of native vegetation trees has been identified. Based on the Department of Water and Environmental conversion rate of one tree = 0.01 hectares this equates to 0.05 hectares.

<b>Reserve Width:</b>	30m
<b>Total Number of Trees:</b>	5
<b>Number of Trees requiring Removal</b>	5
<b>Hectares</b>	0.05

## 5. Aerial Map with survey overlay

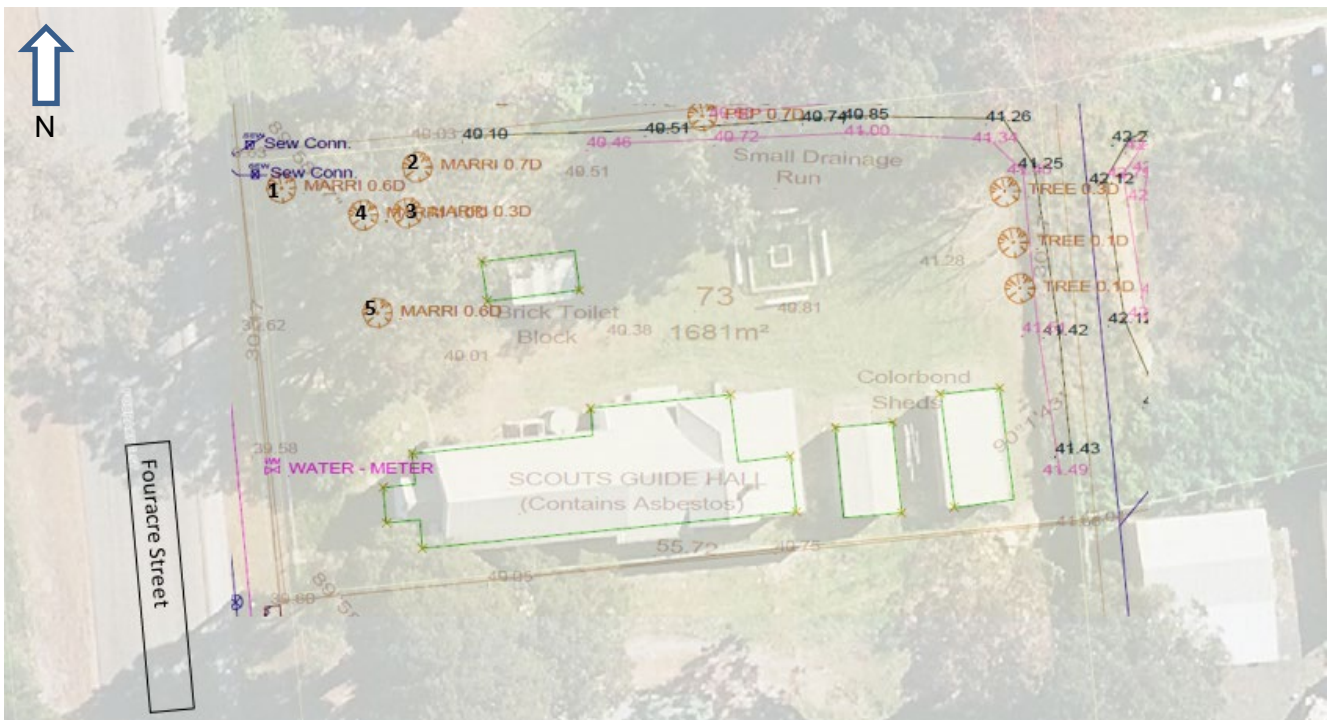

*In addition to the above aerial map the Shire have provided shape files however due to technical difficulties the Shire is unable to load the files into our software.*

## 6. Photos and Additional Information

Tree 1.



Tree 2.



Tree 3.



Tree 4.



Tree 5.





Canopy Dieback



Canker



Trunk Rot

Tree ID	Description	Trunk (m)	Canopy (m)	Pruning/ Removal	Observations
1	<i>Corymbia Calophylla</i>	1.6m	8m	Removal	Tree in average health has been pollarded which exposes huge risk to anyone around the park. Signs of severe canker in canopy and trunk. <i>Extract Arboriculture Report</i> No visible signs of nesting or hollows.
2	<i>Corymbia Calophylla</i>	2.5	8m	Removal	Tree in average health has been pollarded which exposes huge risk to anyone around the park. Signs of severe canker in canopy and trunk. <i>Extract Arboriculture Report</i> . No visible signs of nesting
3	<i>Corymbia Calophylla</i>	.70	3	Removal	Tree in average health has been pollarded which exposes huge risk to anyone around the park. Signs of severe canker in canopy and trunk. <i>Extract Arboriculture Report</i> <i>No visible signs of nesting or hollows</i>
4	<i>Corymbia Calophylla</i>	13	3	Removal	Tree in extreme poor health, has been pollarded which exposes huge risk to anyone around the park. Signs of severe canker in canopy and trunk. <i>Extract Arboriculture Report</i> No visible signs of nesting.
5	<i>Corymbia Calophylla</i>	9	1.65	Removal	Tree in average health has been pollarded which exposes huge risk to anyone around the park. Signs of severe canker in canopy and trunk. <i>Extract Arboriculture Report</i> No visible signs of nesting.