

SAFETY - MAKE IT YOUR PRIMARY VALUE

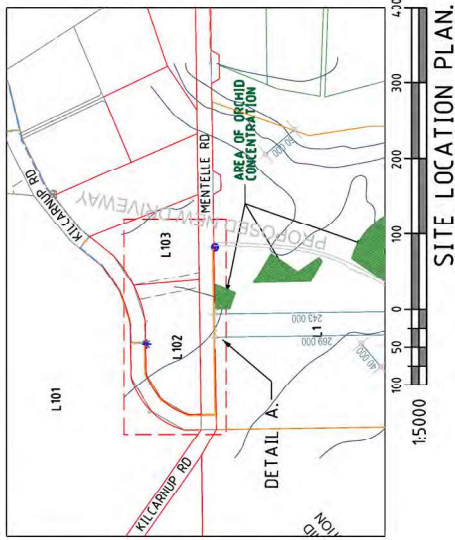

CUSTOMER SCOPE OF WORK

(A) THIS DRAWING IS TO BE READ IN CONJUNCTION WITH THE WESTERN AUSTRALIAN SERVICE AND INSTALLATION REQUIREMENTS.

(B) SUBSTATION SITE WILL BE PREPARED AS PER THE WESTERN AUSTRALIAN SERVICE AND INSTALLATION REQUIREMENTS CLAUSE 14.4.6. THIS INCLUDES, BUT IS NOT LIMITED TO THE FOLLOWING:
 1. PEGGING, COMPACTION AND LEVELLING. A COMPACTION CERTIFICATE IS REQUIRED.
 2. LOCATED 500mm ABOVE 100 YEAR FLOOD LEVEL AND NOT IN A PRECARIOUS POSITION.
 3. CLEAR OF ALL SERVICES INCLUDING ENCROACHMENT.
 4. CLEAN SAND FILL TO A DEPTH OF 150mm. EXCAVATIONS GREATER THAN 150mm TO BE IN ACCORDANCE WITH THE EXCAVATION CODE OF PRACTICE.
 5. ALL SERVICES TO BE IDENTIFIED AND MARKED PRIOR TO ANY WORK. THE SCREENING SHALL BE INSTALLED ONLY AFTER WESTERN POWER HAS COMPLETED ALL OF THE WORK ON THE SITE AND INSTALLATION REQUIREMENTS CLAUSES 14.4.3.1, 14.4.3.2 AND 14.5.4 FOR DETAILS.
 6. NO BUILDINGS ALLOWED WITHIN 4m OF THE SUBSTATION UNLESS AS CONVEYED BY WESTERN POWER PROPERLY SPECIALIST PREPARATION AND REGISTRATION OF THE REQUIRED 7298A RESTRICTIVE COVENANT.
 7. PILLAR EXCLUSION ZONE TO BE PREPARED AS PER THE WESTERN AUSTRALIAN SERVICE AND INSTALLATION REQUIREMENTS CLAUSE 14.5.3. THIS INCLUDES, BUT IS NOT LIMITED TO THE FOLLOWING:
 1. PEGGING THE PILLAR LOCATION AND ADJACENT BOUNDARY LOCATION PRIOR TO CONSTRUCTION.
 2. ONLY EASILY REMOVABLE SURFACE TREATMENT IS TO BE INSTALLED IN THIS AREA, SUCH AS BRICK PAVING.
 3. CLEAR OF ALL SERVICES INCLUDING CONTAMINATED SOIL, ASBESTOS ETC.
 4. LOCATED 300mm ABOVE 100 YEAR FLOOD LEVEL AND NOT IN A PRECARIOUS POSITION.
 5. CUSTOMER TO SUPPLY AND INSTALL 'S' TYPE METERING CT'S.
 6. CUSTOMER ELECTRICAL CONTRACTOR TO ENSURE CUSTOMER'S SPD GRADERS WITH WESTERN POWER'S UPSTREAM PROTECTION AS NOTED ON THE SIMPLIFIED LINE DIAGRAM.
 7. CUSTOMER MUST COMPLY WITH POWER QUALITY LIMITS AS PER AS/NZS TS IEC 61000-3-5 AND WESTERN POWER TECHNICAL REQUIREMENTS.
 8. CUSTOMER ELECTRICAL CONTRACTOR IS TO SUPPLY SUITABLE LVLS AND CAPPING TOOLS FOR TERMINATION OF CUSTOMER'S CABLE.

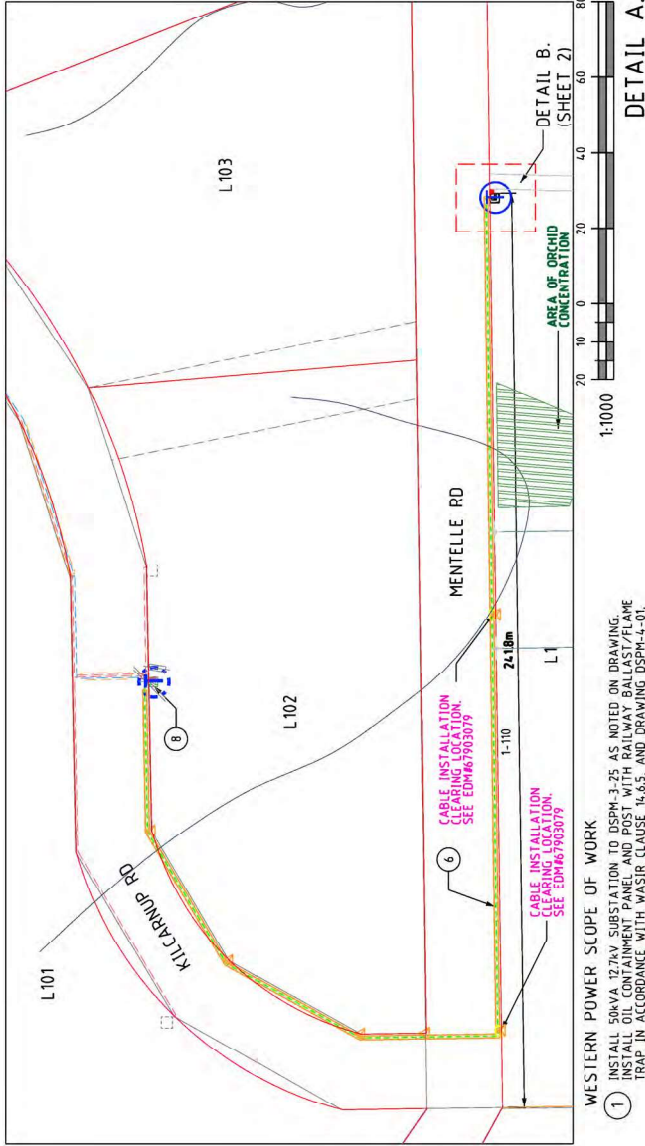

WESTERN POWER SCOPE OF WORK

(1) INSTALL 50kVA 12.7kV SUBSTATION TO DERM 3.25 AS NOTED ON DRAWING. INSTALL OIL CONTAINMENT PANEL AND POST WITH RAILWAY BALLAST/FLAME TRAP IN ACCORDANCE WITH WASIR CLAUSE 14.6.5, AND DRAWING DSPM-4-01. CU: H031, R50/22, H067, T25, H075, H077
 (2) INSTALL PILLAR AS PER ZONE EXCLUSION DETAIL (WASIR CL. 12.5.3). CU: L011 DCSH: U09
 (3) INSTALL 25mm LV CABLE FROM PILLAR TO TRANSFORMER. CU: L042 x 10m DCSH: U09
 (4) TERMINATE 25mm LV CABLE TO PILLAR. INSTALL 400AMP LINKS. CU: H066, T25 DCSH: U9_V11 MOD (EDM666175711) (W010 - F0009 FL1429141)
 (5) TERMINATE 25mm LV CABLE TO TRANSFORMER. (RED & WHITE CORES TO PHASE, BLACK & BLUE CORES TO NEUTRAL) SEE DRAWING DSPM-4-01.
 (6) INSTALL 35mm 1PH HV CABLE FROM NEW TRANSFORMER TO EXISTING TRANSFORMER. CU: L047 x 350m
 (7) TERMINATE 35mm 1PH HV CABLE TO NEW TRANSFORMER.
 (8) TERMINATE 35mm 1PH HV CABLE TO EXISTING TRANSFORMER. CU: H066, T25
 (9) INSTALL CT METER IN CUSTOMER'S SWITCHBOARD. CU: L041
 (10) TERMINATE CUSTOMER'S CABLE IN CONJUNCTION WITH THE CUSTOMER'S ELECTRICAL CONTRACTOR.
 (11) IDENTIFY POSITION WHERE CABLE MARKERS ARE TO BE INSTALLED. EACH MARKER IS TO BE VISIBLE FROM THE NEXT WITH A MAXIMUM SPACING BETWEEN MARKERS OF 50m. CU: L064
 (12) ENVIRONMENTAL FILTER CHECKED
 THE FOLLOWING ENVIRONMENTAL ISSUES HAVE BEEN IDENTIFIED FOR THIS PROJECT. ALL RELEVANT PERMITS / PROCEDURES MUST BE OBTAINED / ADHERED TO:
 1. NATIVE VEGETATION REMAINING (NO NATIVE VEGETATION MAY BE CLEARED OR DAMAGED WITHOUT A PERMIT).
 2. DECLARED RARE FLORA WITH 350m BUFFER.
 3. 350m BUFFER.
 4. UNEXPLODED ORDNANCE.
 PLEASE REFER TO THE CLEARING DRAWING FOR MORE INFORMATION.

NOT APPROVED FOR CONSTRUCTION

TELECOMS CABLES IN VICINITY OF WORKS

UNEXPLODED ORDNANCE WORKSITES THAT MAY BE FOUND ON SITE. ALL EXCAVATIONS TO BE DONE IN ACCORDANCE WITH THE EXCAVATION AND TRENCHING PROCEDURE EDM44-374/0956 CONTACT POLICE IF ANY SUSPICIOUS / UNEXPECTED ITEMS ARE FOUND DURING EXCAVATIONS.

NO NATIVE VEGETATION MAY BE DISTURBED WITHOUT A PERMIT OR OUTSIDE OF THE PERMIT AREA. IF IN DOUBT, PLEASE CONTACT THE RELEVANT MANAGER WHO WILL CONTACT WESTERN POWER ENVIRONMENTAL TEAM.
 PLEASE NOTE: HEAVY PENALTIES MAY APPLY TO INDIVIDUALS AND BUSINESSES FOR DAMAGE TO NATIVE VEGETATION WITHOUT A PERMIT.

DETAIL A.

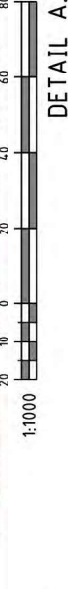

DETAIL B.

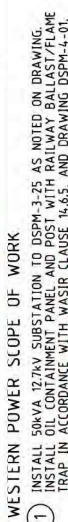

LEGEND

HV CABLES

- CNE3 - 60mm² (3X1)
- CN4 - 35mm² (3X1)
- CN4.8 - 185mm² (3X1)
- CN5 - 95mm² (3X1)
- CN5.1 - 50mm² (3X1)
- CN5.1 - 50mm² (1)
- CN6 - 35mm² (3X1)
- CN7 - 35mm² (1)

EXISTING HV CABLES

LV-SL CABLES

- CN5 - 240mm² (1x3)
- CN4 - 185mm² (1x3)
- CN3 - 120mm² (1x3)
- CN2 - 25mm² (1x3)
- CN1 - 16mm² SL (1)

EXISTING LV CABLES

SIZE AND TYPE INDICATED

PILLARS / PITS / ETC

- MIN (WORKING END)
- UNIVERSAL
- MINI
- LINK
- CABLE MARKER U/G
- Service In-cased De-energised LV

UTILITIES PIT

- RSP PIT
- NO/200AMP CUTOUT
- CONDUIT / POLY PIPE

CONDUIT / POLY PIPE

- Service In-cased De-energised LV

TRANSFORMER

- EXISTING
- SWITCHGEAR

AERIAL CONDUCTORS AND POLES

- NEW POLE (ANY TYPE AS INDICATED)
- EXISTING POLE (ANY TYPE AS INDICATED)
- EXISTING AERIAL CONDUCTORS (SIZE AND TYPE INDICATED)

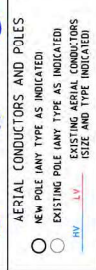

50KVA SPDS TRANSFORMER
 200A FUSE
 PILLAR WITH 400A LINKS
 25 kA SPD TRANSFORMER ISOLATING A SWITCH TO BE WITHDRAWABLE CB. FAULT CURRENT LIMITING TRIP SETTING 80A TO GRADE WITH 200A LV FUSES.
 'S' TYPE CTs
 CUSTOMER SWITCHBOARD

MAXIMUM SIZE CONSUMERS MAINS THAT CAN BE CONNECTED TO PILLAR ARE 1 x 185mm² CABLE / PHASE.

SIMPLIFIED SLD

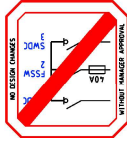

CUSTOMER CONTACT DETAILS

COMPANY NAME: VENETIAN NOMINEES PRT LTD
 CONTACT: AARON KARATTI
 TEL: 04-39 988 739

western power

DRAWING NUMBER: SP050435
 SHEET 01 OF 03
 REV: C ORIGINAL SIZE - A2

DESIGNER: TREVOR PEARCE
DESIGN TEAM: CCS DESIGN TEAM D
EMAIL: ccs.design@westernpower.com.au
TEL: 13 10 87
DATE: 09/23
GEO REF: Lot. - 32°54'33" S Long. - 115°00'32" E

NEW LV SUPPLY.
NEW 200A, 240V 1PH LV SUPPLY
 LOT 1, MENTELLE RD, BURNSIDE, WA 6285
 NETWORK VOLTAGE: 12.7kV / 240V

TO BE CONSTRUCTED DE-ENERGISED UNLESS RISK ASSESSED

Rev.	REVISIONS	DRN	DATE
C	ORCHID LOCATION & CONTRACTOR PROPOSED CLEARING ADDED.	T.P.	04/24
B	CABLE ROUTE CHANGED.	T.P.	07/24
A	ISSUED FOR CONSTRUCTION	T.P.	10/23

FILE REFERENCE DETAILS

Rev.	REVISIONS	DRN	DATE
C	ORCHID LOCATION & CONTRACTOR PROPOSED CLEARING ADDED.	T.P.	04/24
B	CABLE ROUTE CHANGED.	T.P.	07/24
A	ISSUED FOR CONSTRUCTION	T.P.	10/23

SAFETY - MAKE IT YOUR PRIMARY VALUE

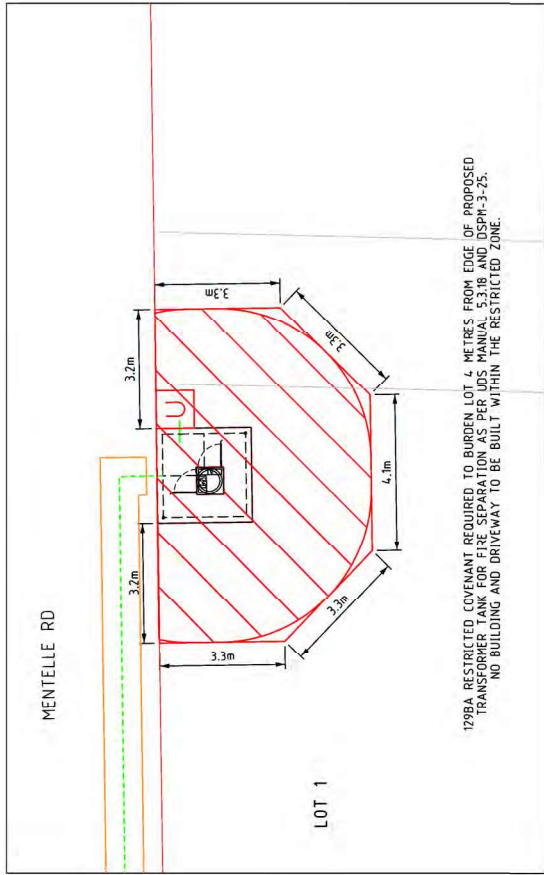

129BA RESTRICTED COVENANT REQUIRED TO BURDEN LOT 4 METRES FROM EDGE OF PROPOSED TRANSFORMER TANK FOR FIRE SEPARATION AS PER LDS MANUAL 5.3.18 AND DSPM-3-25. NO BUILDING AND DRIVEWAY TO BE BUILT WITHIN THE RESTRICTED ZONE.

1:100
FIRE RISK ZONE.

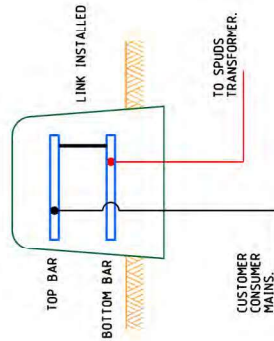

UNI-PILLAR SLD.

NOT APPROVED for CONSTRUCTION

TO BE CONSTRUCTED DE-ENERGISED UNLESS RISK ASSESSED

Rev.	REVISIONS	DRN	DATE	FILE REFERENCE DETAILS
C	ORCHID LOCATION & CONTRACTOR PROPOSED CLEARING ADDED.	T.P.	04/24	DBYD EDM# 66177573
B	CABLE ROUTE CHANGED.	T.P.	07/24	SHE ASSESSMENT REPORT EDM# 66175770
A	ISSUED FOR CONSTRUCTION	T.P.	10/23	HAZARD MANAGEMENT REGISTER DM# 64566580

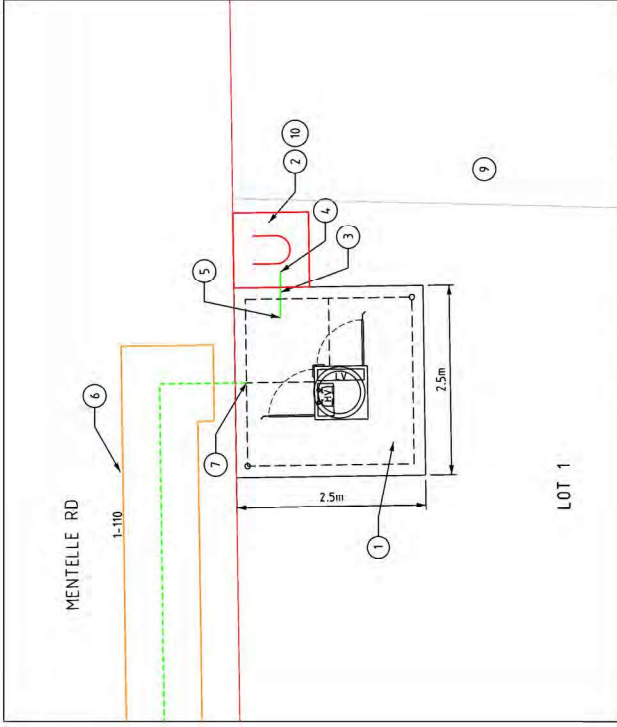

1:50
DETAIL B.

**TELECOMS CABLES
IN VICINITY OF WORKS**

UNEXPLODED ORDNANCE WORKSITE IS LOCATED WHERE THERE IS A HISTORY OF MILITARY WORKSITES. UNEXPLODED ORDNANCE MAY STILL BE FOUND ON SITE. ALL EXCAVATIONS TO BE DONE IN ACCORDANCE WITH THE EXCAVATION AND TRENCHING PROCEDURE EDM# 3740956. CONTACT POLICE IF ANY SUSPICIOUS / UNEXPECTED ITEMS ARE FOUND DURING EXCAVATIONS.

NO NATIVE VEGETATION MAY BE DISTURBED WITHOUT A PERMIT OR OUTSIDE OF THE PERMIT AREA. IF IN DOUBT, PLEASE CONTACT THE RELEVANT MANAGER WHO WILL CONTACT WESTERN POWER ENVIRONMENTAL TEAM. PLEASE NOTE: HEAVY PENALTIES MAY APPLY TO INDIVIDUALS AND BUSINESSES FOR DAMAGE TO NATIVE VEGETATION WITHOUT A PERMIT.

NEW LV SUPPLY.
NEW 200A, 240V 1PH LV SUPPLY
LOT 1, MENTELLE RD, BURNSIDE, WA 6285
NETWORK VOLTAGE: 12.7kV / 24.0V

LEGEND

HV CABLES

- CN3 - 60mm² (3X1)
- CN4 - 30mm² (3X1)
- CN4.8 - 18mm² (3X1)
- CN5 - 95mm² (3X1)
- CN5.1 - 50mm² (3X1)
- CN5.1 - 50mm² (1)
- CN5.1 - 35mm² (3X1)
- CN6 - 35mm² (1)
- CN7 - 35mm² (1)

EXISTING HV CABLES
EXISTING TYPE INDICATED

LV-SL CABLES

- CN1.5 - 24mm² (N3)
- CN4 - 18mm² (N3)
- CN4.3 - 12mm² (N3)
- CN2 - 25mm² (N3)
- CN1 - 18mm² (N3)
- CN1 - 18mm² (1)
- 4.0 C PILOT

EXISTING LV CABLES
EXISTING TYPE INDICATED

PILLARS / PITS / ETC

- MINI WORKING END
- UNIVERSAL
- MINI
- LINK
- CABLE MARKER U/G
- Service Incinerated De-energised Lt

UTILITIES PIT

- UTL PIT
- RSP PIT
- HO/200AMP CUTOUT
- CONDUIT / POLY PIPE

TRANSFORMER EXISTING SWITCHGEAR

AERIAL CONDUCTORS AND POLES

- NEW POLE (ANY TYPE AS INDICATED)
- EXISTING POLE (ANY TYPE AS INDICATED)
- EXISTING AERIAL CONDUCTORS (SIZE AND TYPE INDICATED)
- NEW LV (SIZE AND TYPE INDICATED)

CUSTOMER CONTACT DETAILS

COMPANY NAME: VENETIAN NOMINEES PRT LTD
CONTACT: AARON KARATTI
TEL: 04-39 988 739

westernpower

DESIGNER: TREVOR PEARCE
DESIGN TEAM: CCS DESIGN TEAM D
EMAIL: ccs.design@westernpower.com.au
TEL: 13 10 87
DATE: 09/23
SCALE: AS NOTED @ A2
GEO REF: Lat. - 32°54'33" S
Long. - 115°00'32" E

DRAWING NUMBER: **SP050435**

SHEET 02 OF 03

REV: C ORIGINAL SIZE - A2

SP050435 - L1 Mentelle Road, Burnside – Clearing Requirements – as at 14/3/24



Transformer Site

Western Clearing Section

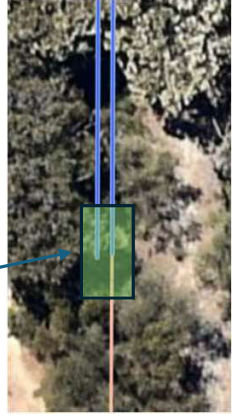

2.5m x 1.5m clearing

Eastern Clearing Section

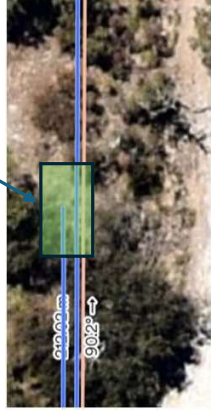

2.5m x 1.5m clearing

Western Power require a new HV cable to be installed in the 0-500mm alignment on the southern boundary of Mentelle Road. GUS propose 2 x 2.5m x 1.5m entry/exit holes to be excavated to allow the directional drilling works to occur. This will minimise disruption to existing vegetation while allowing the works to proceed. GUS has performed numerous projects of this nature in locations that are environmentally sensitive and understand the requirements to minimise vegetation disruption and damage. GUS are available to meet with the Shire +/- DBCA to discuss the works in further detail.



Western Clearing Section

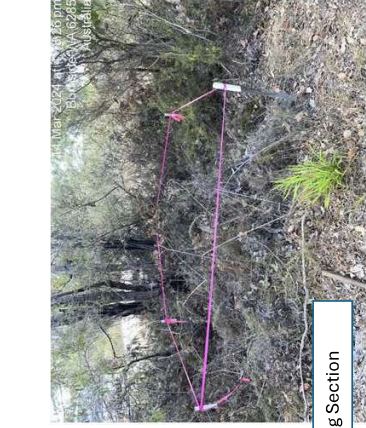

Eastern Clearing Section



2.5m x 1.5m clearing