

**Clearing referral application (EP18-128(17)—058 and 59 KK)**

**Lots 102 and 4623 Wallcliffe Road, and Wallcliffe Road Reserve, Margaret River**

# Attachment 3

Western Power Preliminary Works Area









With regard to your requested works, it has been identified by Western Power that clearing or potential clearing is required to facilitate the connection. Being a customer funded project, the customer is responsible for obtaining all necessary clearing approvals prior to the commencement of works, you can engage an environmental consultancy to assist with this matter.

Refer to <https://www.wa.gov.au/service/environment/environment-information-services/native-vegetation-clearing-permits> for further information on clearing approval requirements. Advice on relevant exemptions can be obtained via DWER's "Guide 1 Exemptions and regulations for clearing native vegetation" and clarification can be sought via emailing DWER directly via [info@dwere.wa.gov.au](mailto:info@dwere.wa.gov.au).

Please note that DWER may identify that the clearing has significant impacts and there may be additional requirements before or after DWER issue a clearing permit that may impact the delivery date. These may include flora or fauna survey requirements and hygiene management plans.

- A clearing permit; or
- A referral determination notice issued by DWER confirming a clearing permit is not required; or
- Written details of a relevant clearing permit exemption and supporting documents (including any Regulator correspondence).

CLEARING AREA - SURVEY PEG SCHEDULE			
POINT ID	CLEARING AREA	LOCATION (MGA94 - 50)	
		EASTING	NORTHING
A	A1	315016.7342	315016.7342
B	A1	315019.3731	6239066.5982
C	A1	315231.8062	6239262.4838
D	A1	315227.0546	6239265.4628
E	A2	315037.0909	6239098.9385
F	A2	31504.76500	6239104.5644
G	A2	315092.1069	6239164.3854
H	A2	315088.7277	6239164.3328
I	A3	315103.5959	6239183.1730
J	A3	315112.2292	6239190.2288
K	A3	315105.2600	6239199.2392
L	A3	315096.6708	6239192.7753
M	A4	315164.4847	6239201.4625
N	A4	315179.9454	6239219.8191
O	A4	315170.7671	6239227.5495
P	A4	315155.3064	6239209.1928
Q	A5	315210.5281	6239260.5128
R	A5	315217.3207	6239272.0215
S	A5	315210.6446	6239276.1973
T	A5	315203.7572	6239264.9719

[illegible]



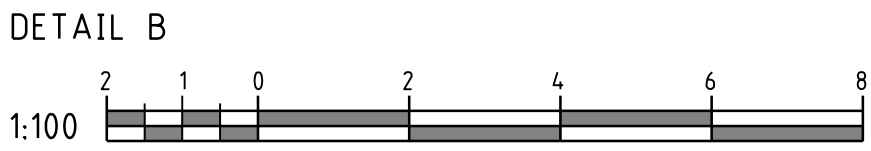
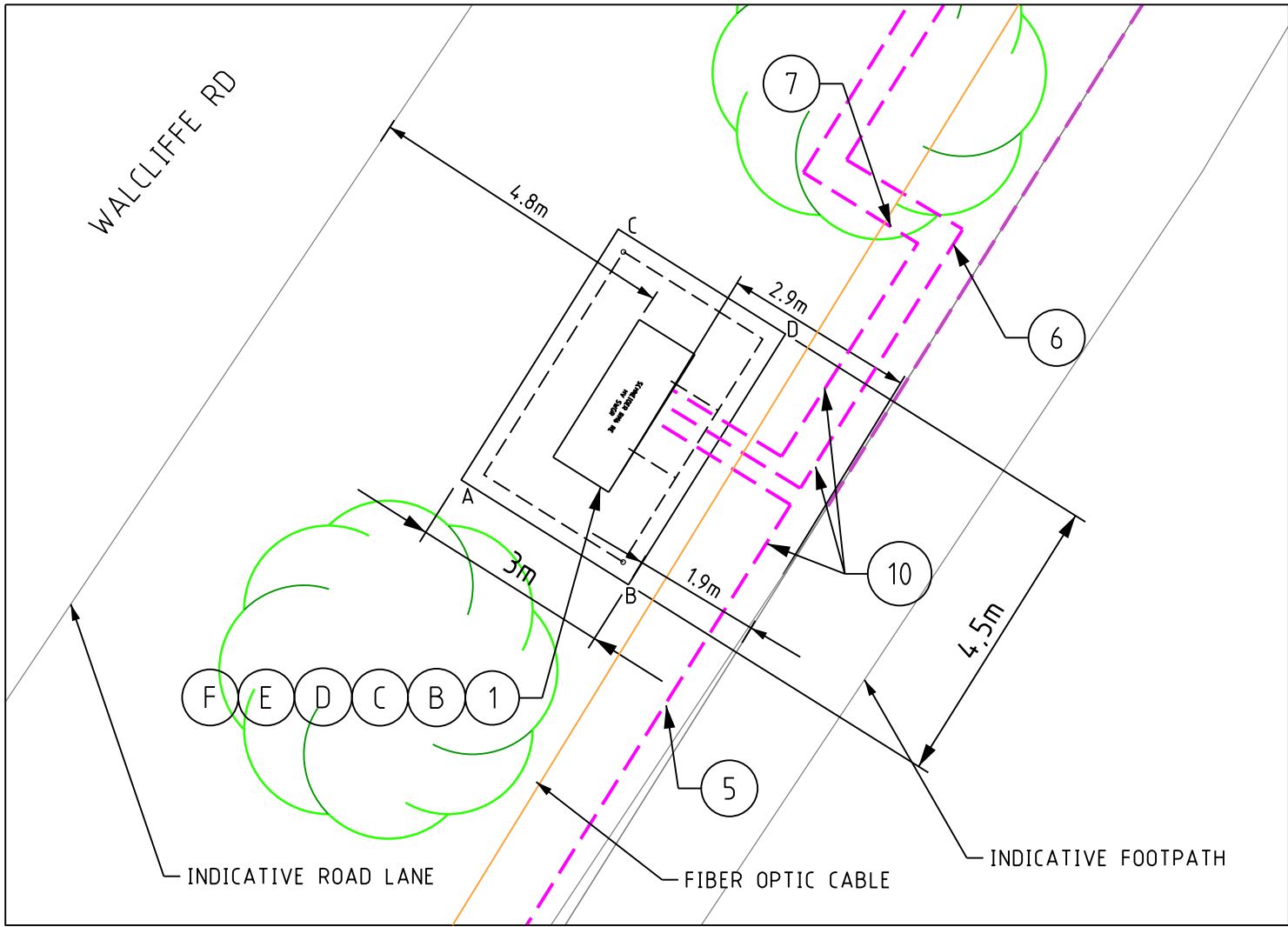
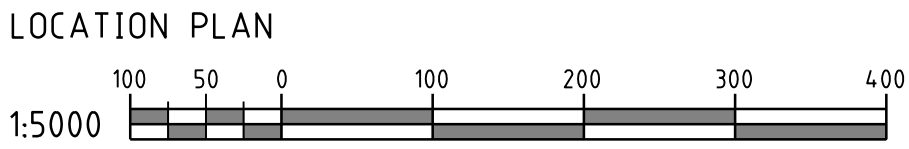
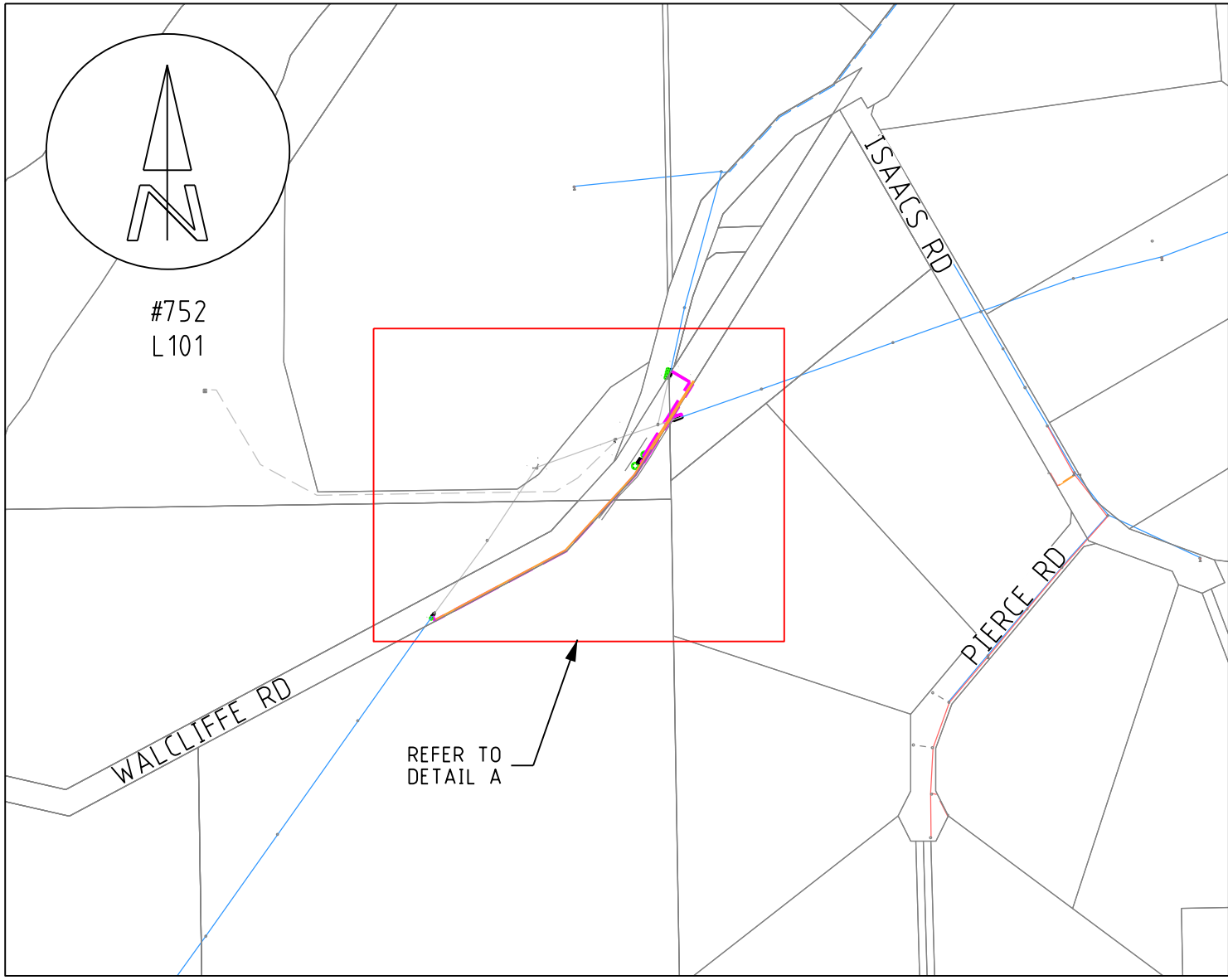

POLE SCHEDULE						As Con Check
POLE ID	POLE DETAILS	INSTRUCTION	LOCATION		DCSH REFERENCE	
			EASTING	NORTHING		
NEW POLE 1	12.5m/6kN	HV TERMINATION WITH CABLE AND OUTRIGGER STAY	315021.171	6239072.985	H09-1	
NEW POLE 2	11m/6kN	HV TERMINATION WITH CABLE AND GROUND STAY	315220.031	6239231.768	H09-1	
NEW POLE 3	11m/6kN	HV TERMINATION WITH CABLE DOF AND GROUND STAY	315211.282	6239268.724	H09-2	

NOT APPROVED for CONSTRUCTION

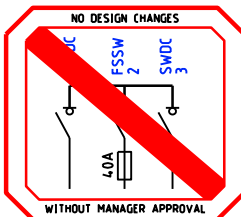

SAFETY - MAKE IT YOUR PRIMARY VALUE

DESIGNED TO BE CONSTRUCTED DE-ENERGISED UNLESS RISK ASSESSED

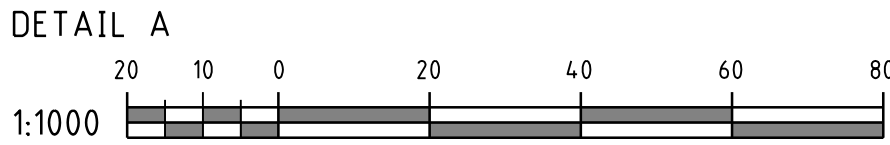
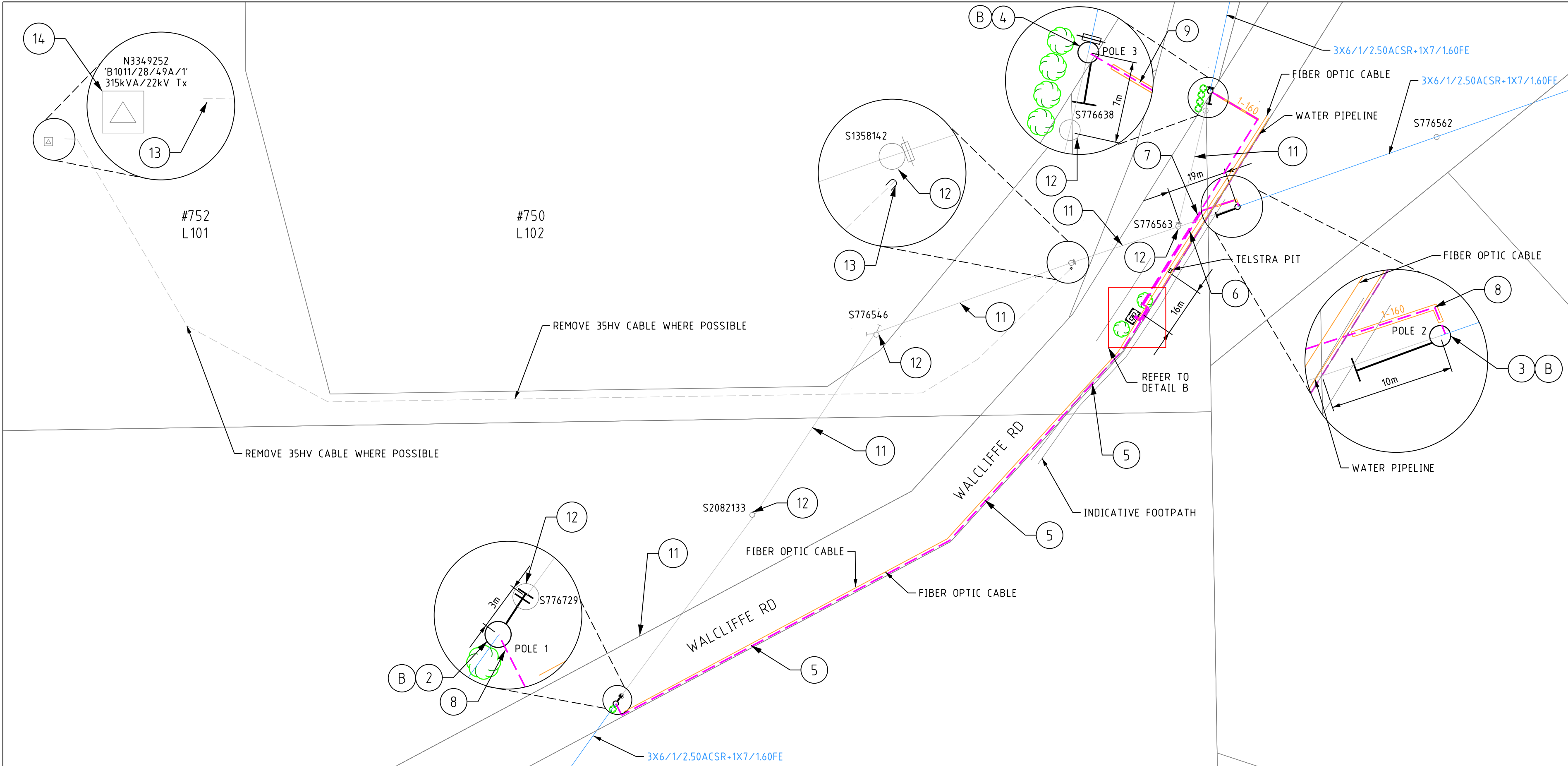

POINT ID	RMU LOCATION (MGA94 - 50)	
	EASTING	NORTHING
A	315184.045	6239195.597
B	315186.587	6239194.004
C	315186.434	6239199.411
D	315188.976	6239197.818

#### WESTERN SCOPE OF WORK

- NOTE TO CM:  
- CM TO ENSURE APRA FORM IS COMPLETED AND  
- SUBMITTED TO WATER CORP BEFORE ANY CONSTRUCTION WORK.  
- CM TO ENSURE ALL APPROVALS HAS BEEN RECEIVED PRIOR TO THE PRESTART MEETING.
- INSTALL NEW MOTORISED 3-1 SWITCHGEAR IN ROAD RESERVE AS PER THE DETAIL A AND B.  
CU: HUB\_A400 x 1  
DSPM: DSPM-3-27
  - INSTALL NEW 12.5m/6kN POLE 1 AS PER THE POLE SCHEDULE TABLE AND DETAIL A.  
INSTALL NEW HV TERMINATION CROSSARM ON NEW POLE 1.  
INSTALL NEW RUNNING EARTH TERMINATION ON NEW POLE 1.  
INSTALL NEW 19/275 OUTRIGGER STAY ON NEW POLE 1.  
CU: POB\_R x 1, HV5\_3RN x 1, CN1\_6/1/250 x 3, RE3\_7/160SC x 1, ST4\_19/200W x 1  
DCSH: H09-1, R13-3, R14-2
  - INSTALL NEW 11m/6kN POLE 2 AS PER THE POLE SCHEDULE TABLE AND DETAIL A.  
INSTALL NEW HV TERMINATION CROSSARM ON NEW POLE 2  
INSTALL NEW RUNNING EARTH TERMINATION.  
INSTALL NEW GROUND STAY.  
CU: POB\_R x 1, HV5\_3RN x 1, CN1\_6/1/250 x 3, RE3\_7/160SC x 1, ST1\_19/200W x 1  
DCSH: H09-1, R13-3, R14-1
  - INSTALL NEW 11m/6kN POLE 3 AS PER THE POLE SCHEDULE TABLE AND DETAIL A.  
INSTALL NEW HV TERMINATION DOFF CROSSARM WITH 315A DOF.  
INSTALL NEW RUNNING EARTH TERMINATION.  
INSTALL NEW GROUND STAY.  
CU: POB\_R x 1, HV8\_3N x 1, RE3\_7/160SC x 1, CN1\_6/1/250 x 3, CN11\_150 x 6  
CN39\_150/4M x 1, HV51\_315ED0 x 1, RE3\_7/160SC x 1, ST1\_19/200W x 1  
DCSH: H09-2, R13-3, R14-1
  - INSTALL NEW 400HV CABLE FROM NEW SWITCHGEAR TO NEW POLE 1.  
CU: CN53 x 235m, CN73\_240 x 3, CN54 x 8
  - INSTALL NEW 400HV CABLE FROM NEW SWITCHGEAR TO NEW POLE 2 IN 2.7m ALIGNMENT.  
CU: CN53 x 70m, CN73\_240 x 3, CN54 x 8
  - INSTALL NEW 400HV CABLE FROM NEW SWITCHGEAR TO NEW POLE 3 IN 2.7m ALIGNMENT.  
INSTALL CABLE IN POLYPIPE WHERE CROSSING ROADS.  
CU: CN53 x 110m, CN73\_240 x 3, CN54 x 10
  - AT POLE 1 AND 2, TERMINATE NEW 400HV CABLES.  
CU: HU16\_U\_0 x 2, HU16\_U\_22 x 2, CN9\_7/250AA x 6, CN70\_150 x 6  
DCSH: H09-1
  - AT POLE 3, TERMINATE NEW 400HV CABLE.  
CU: HU16\_U\_0 x 1, HU16\_U\_22 x 1, CN9\_7/250AA x 3, CN70\_150 x 6  
DCSH: H09-2
  - AT NEW SWITCHGEAR, TERMINATE NEW 3 x 400HV CABLES.  
DSPM: DSPM-3-27
  - REMOVE HV AND RE OVERHEAD AERIAL BETWEEN POLE S776729 TO NEW POLE 2.  
REMOVE HV AND RE OVERHEAD AERIAL BETWEEN TEE-OFF POLE S776563 TO NEW POLE 3.
  - REMOVE POLES AND ASSOCIATED ASSETS BETWEEN POLE S776729, S2082133, S776546, S1358142 TO S776563
  - REMOVE POLE AND ASSOCIATED ASSETS BETWEEN TEE-OFF POLE S776563 TO S776638
  - DISCONNECT EXISTING 35HV CABLE FROM B1011/22//49A/1 Tx AND FROM POLE S1358142.  
REMOVE HV CABLE (PID: C2037681) WHERE POSSIBLE. IF THERE ARE SECTIONS WHERE IT IS NOT POSSIBLE, DE-ENERGISE AND CAP THE EXISTING HV CABLE.  
CU: CN73\_240 x 4
  - DECOMMISSION AND REMOVE EXISTING B1011/22//49A/1 Tx

- 15 ENVIRONMENTAL FILTER CHECK  
THE FOLLOWING ENVIRONMENTAL ISSUES HAVE BEEN IDENTIFIED FOR THIS PROJECT. ALL RELEVANT PERMITS / PROCEDURES MUST BE OBTAINED / ADHERED TO:
- HERITAGE
  - HERITAGE AREAS
  - VEGETATION
  - LANDBASE
- PLEASE REFER TO THE ENVIRONMENTAL DRAWING FOR MORE INFORMATION.

#### CUSTOMER SCOPE OF WORK

- A THIS DRAWING IS TO BE READ IN CONJUNCTION WITH THE WESTERN AUSTRALIAN SERVICE AND INSTALLATION REQUIREMENTS.
- B CUSTOMER IS RESPONSIBLE TO OBTAIN ALL AFFECTED 3RD PARTY APPROVAL FOR NEW SWITCHGEAR LOCATION ON ROAD RESERVE AND NEW WESTERN POWER ASSETS (LOCAL GOVERNMENT AUTHORITY, 3RD PARTY, LAND OWNER AND UTILITY SERVICES).
- C CUSTOMER IS RESPONSIBLE TO OBTAIN ALL ENVIRONMENTAL APPROVAL SHOWN ON WESTERN POWER SCOPE #15 AND ENVIRONMENTAL DRAWING WHICH INCLUDES VEGETATION CLEARING PERMIT FOR NEW WESTERN POWER ASSETS.
- D SWITCHGEAR SITE WILL BE PREPARED AS PER THE WESTERN AUSTRALIAN SERVICE AND INSTALLATION REQUIREMENTS CLAUSE 14.4.8. THIS INCLUDES, BUT IS NOT LIMITED TO THE FOLLOWING:
- PEGGING, COMPACTION AND LEVELLING.
  - LOCATED 500mm ABOVE 100 YEAR FLOOD LEVEL AND NOT IN A PRECARIOUS POSITION.
  - CLEAR OF ALL SERVICES INCLUDING ENCROACHMENT.
  - CLEAN SAND FILL TO A DEPTH OF 1m IN SANDY SOILS TO A DEPTH OF 1.6m IN CLAY OR ROCK.
- E SUBSTATION TO BE DESIGNED TO MINIMUM DIMENSIONS SHOWN ON THE DRAWING AND IN CONJUNCTION WITH WESTERN POWER'S DRAWING DSPM-3-27.
- F CUSTOMER IS RESPONSIBLE FOR CONDUCTING POTHOLING AND VERIFYING THAT NO THIRD-PARTY ASSETS ARE PRESENT AT THE PROPOSED SWITCHGEAR SITE. IN THE EVENT THAT THIRD-PARTY ASSETS ARE IDENTIFIED, IT IS THE CUSTOMER'S RESPONSIBILITY TO OBTAIN APPROVAL FOR THEIR RELOCATION.

LEGEND	
HV CABLES	
CN53 - 400mm2 (3X1c)	---
CN49 - 240mm2 (3X1c)	---
CN48 - 185mm2 (3X1c)	---
CN50 - 95mm2 (3X1c)	---
CN51 - 50mm2 (3X1c)	---
CN51 - 50mm2 (1c)	---
CN46 - 35mm2 (3X1c)	---
CN47 - 35mm2 (1c)	---
EXISTING HV CABLES (SIZE AND TYPE INDICATED)	
AERIAL CONDUCTORS AND POLES	
NEW POLE (ANY TYPE AS INDICATED)	○
EXISTING POLE (ANY TYPE AS INDICATED)	○
EXISTING AERIAL CONDUCTORS (SIZE AND TYPE INDICATED)	---

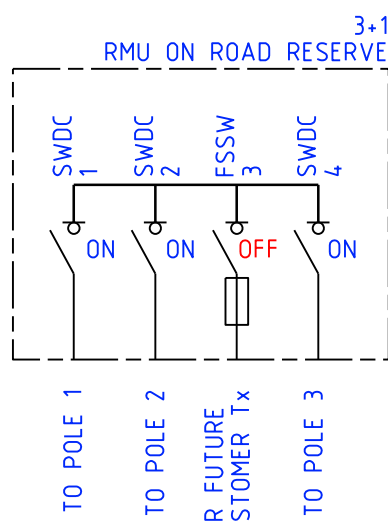

WATER PIPELINE  
IN VICINITY OF WORKS

FIBER OPTIC CABLES  
IN VICINITY OF WORKS

UNEXPLODED ORDNANCE  
IN VICINITY OF WORKS

CUSTOMER CONTACT DETAILS  
COMPANY NAME: BCA CONSULTANTS  
CONTACT: WARWICK KILWORTH TEL: 0439 448 774

## OH/UG ASSET INSTALLATION AND REMOVAL

### NETWORK VOLTAGES: 22kV/415V

L101 #752 WALLCLIFFEE RD - MARGARET RIVER WA 6285

DESIGN DRAWING

DESIGNER: CCD	
DESIGN TEAM: CCS SBM QAT - RASP	
EMAIL: ccs.sbm.qat@westernpower.com.au	DRAWING NUMBER
TEL: 13 10 87	
DATE: 02/25	SCALE: AS NOTED @ A1
GEO REF: Lat. - 33° 58' 21" S Long. - 114° 59' 51" E	SHEET 01 OF 02
REV: 1	
ORIGINAL SIZE - A1	