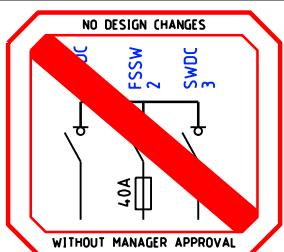

TO BE CONSTRUCTED DE-ENERGISED UNLESS RISK ASSESSED

[illegible]

HV CABLES

CN53 - 400mm2 (3X1c)	— — — — —
CN49 - 240mm2 (3X1c)	— — — — —
CN48 - 185mm2 (3X1c)	— — — — —
CN50 - 95mm2 (3X1c)	— — — — —
CN51 - 50mm2 (3X1c)	— — — — —
CN51 - 50mm2 (1c)	— — — — —
CN46 - 35mm2 (3X1c)	— — — — —
CN47 - 35mm2 (1c)	— — — — —

EXISTING HV CABLES  
(SIZE AND TYPE INDICATED)

— — — — —
-----------

CN45 - 240mm2 (1x3c) —————  
 CN44 - 185mm2 (1x3c) —————  
 CN43 - 120mm2 (1x3c) —————  
 CN42 - 25mm2 (1x3c) —————  
 CN41 - 16mm2 SL (1c) - - - - -  
 40 C PILOT - - - - -  
 EXISTING LV CABLES  
 (SIZE AND TYPE INDICATED) - - - - -

EXISTING ○

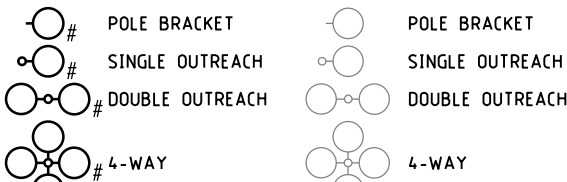

# - ALPHA CHARACTER DENOTES STREET LIGHT TYPE.  
REFER STREET LIGHT SCHEDULE FOR POLE & LUMINAIRE DETAILS.

## PILLARS / PITS / ETC

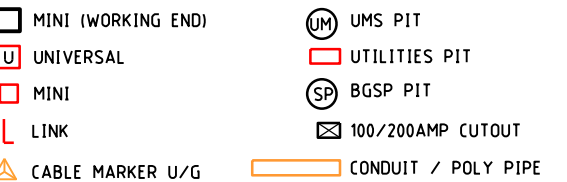

TRANSFORMER      EXISTING      SWITCHGEAR



## AERIAL CONDUCTORS AND POLES

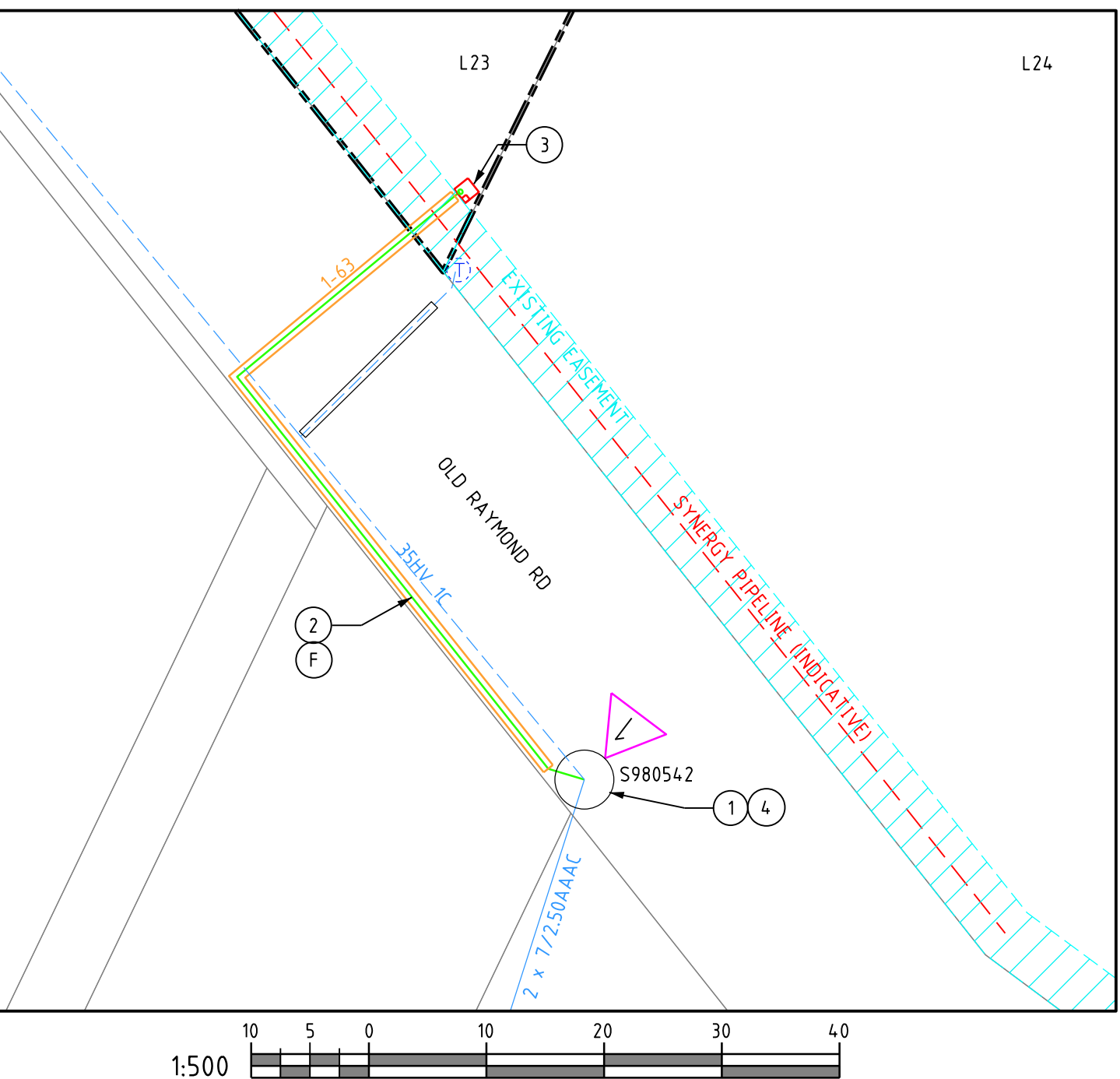
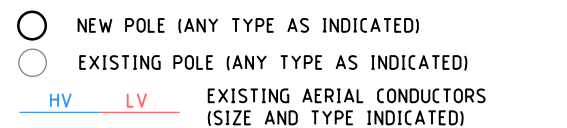

## CUSTOMER SCOPE OF WORK

- 1 REPLACE POLE S980542 WITH 1PH HV TERM POLE.  
RECONNECT EXISTING 35HV 1C CABLE TO POLE  
INSTALL NEW 25KVA TRANSFORMER ON POLE.  
CU: P06, HV30, CN1, RE3, HU57, CN9 x 2, CN70, TX5  
DCSH: H47-4 NO DOFS
- 2 INSTALL 25LV CABLE FROM POLE S980542 TO PILLAR  
SITE ON LOT 23.  
CROSS OVER OR UNDER SYNERGY PIPELINE AS SHOWN IN  
SYNERGY PIPELINE CROSSING DETAIL.  
MARK ON AS-CON THE INSTALLED OPTION.  
CU: CN42 x 85m, CN54 x 2, CN73 x 2
- 3 INSTALL MINI PILLAR ON LOT 23 AS PER PILLAR  
EXCLUSION ZONE DETAIL.  
TERMINATE 25LV CABLE TO PILLAR.  
CU: LU10  
NON-CU: CR0324  
DCSH: U08-4
- 4 TERMINATE 25LV CABLE TO NEW TX ON POLE S980542.  
CU: LU61  
DCSH: U19/3
- 5 ENVIRONMENTAL FILTER CHECKED BY THE DESIGNER. THE  
FOLLOWING ENVIRONMENTAL LAYERS HAVE BEEN  
IDENTIFIED:
  - NATIVE VEGETATION REMAINING
  - ACID SULPHATE SOILS
  - POTENTIALLY WET AREAS

- (A) THIS DRAWING IS TO BE READ IN CONJUNCTION WITH THE WESTERN AUSTRALIAN SERVICE AND INSTALLATION REQUIREMENTS.
- (B) PILLAR EXCLUSION ZONE TO BE PREPARED AS PER THE WESTERN AUSTRALIAN SERVICE AND INSTALLATION REQUIREMENTS CLAUSE 12.5.3. THIS INCLUDES, BUT IS NOT LIMITED TO THE FOLLOWING:
1. PEGGING THE PILLAR LOCATION AND ADJACENT BOUNDARY LOCATION PRIOR TO CONSTRUCTION.
  2. ONLY EASILY REMOVABLE SURFACE TREATMENT IS TO BE INSTALLED IN THIS AREA, SUCH AS BRICK PAVING.
  3. CLEAR OF ALL SERVICES.
  4. LOCATED 300mm ABOVE 100 YEAR FLOOD LEVEL AND NOT IN A PRECARIOUS POSITION.
- (C) CUSTOMER MUST COMPLY WITH POWER QUALITY LIMITS AS PER AS61000.3.6 AND WESTERN POWER TECHNICAL REQUIREMENTS.
- (D) CUSTOMERS ELECTRICAL CONTRACTOR TO ARRANGE THE TERMINATION OF ALL CONSUMER MAINS TO THE PILLAR BACK BLOCKS. MAX SIZE CONSUMER MAINS THAT CAN BE TERMINATED IS 35mm<sup>2</sup>/PHASE.
- (E) CUSTOMER TO ARRANGE FOR WESTERN POWER ELECTRICAL CONTRACTOR SERVICE REQUEST OR AN APPROPRIATELY ACCREDITED ELECTRICAL CONTRACTOR, TO INSTALL DIRECT METERING IN THE SWITCHBOARD PRIOR TO SUPPLY BEING ENERGISED.
- (F) CUSTOMER TO PROVIDE A VEGETATION PERMIT AND COMPLETE ANY CLEARING REQUESTED BY THE WESTERN POWER CONSTRUCTION MANAGER PRIOR TO CONSTRUCTION COMMENCING.  
REFER TO SHEET 2 FOR ADDITIONAL INFORMATION.

## SYNERGY PIPELINE IN VICINITY OF WORKS

## TELECOMS IN VICINITY OF WORKS

NO NATIVE VEGETATION MAY BE DISTURBED WITHOUT A PERMIT.  
IF IN DOUBT PLEASE CONTACT THE RELEVANT MANAGER WHO WILL  
CONTACT WESTERN POWER ENVIRONMENTAL OPERATIONS TO  
ARRANGE A PERMIT.

PLEASE NOTE: HEAVY PENALTIES MAY APPLY TO INDIVIDUALS AND BUSINESSES FOR DAMAGE TO NATIVE VEGETATION WITHOUT A PERMIT.

## CUSTOMER CONTACT DETAILS

COMPANY NAME:  
CONTACT: JOSHUA LAING TEL: 0432293789

NEW RESIDENTIAL SUPPLY  
SUPPLY 5KVA DADMD @ 240V

LOT 23 OLD RAYMOND RD, ROELANDS

NETWORK VOLTAGE: 22kV / 415V

DESIGNER:	DYLAN IWACH
DESIGN TEAM:	CCS DESIGN TEAM D
EMAIL:	CCS.DESIGN.D@WESTERNPOWER.COM.AU
TEL:	13 10 87
DATE: 03/25	SCALE: AS SHOWN @ A2
GEO REF:	Lat. - 33°17'46.599" S Long. - 115°48'49.372" E



westernpower

SP052272

SHEET 01 OF 02

REV: **A** | ORIGINAL SIZE - A2

A	ISSUED FOR CONSTRUCTION	D.I	03/25	HAZARD MANAGEMENT REGISTER EDM#71540719
Rev.	REVISIONS	DRN	DATE	FILE REFERENCE DETAILS





PERMIT DETAIL - 1:250

VEGETATION INSTRUCTION

WITH REGARD TO YOUR REQUESTED WORKS, IT HAS BEEN IDENTIFIED BY WESTERN POWER THAT CLEARING OR POTENTIAL CLEARING IS REQUIRED TO FACILITATE THE CONNECTION. BEING A CUSTOMER-FUNDED PROJECT, THE CUSTOMER IS RESPONSIBLE FOR OBTAINING ALL NECESSARY CLEARING APPROVALS PRIOR TO THE COMMENCEMENT OF WORKS. YOU CAN ENGAGE AN ENVIRONMENTAL CONSULTANCY TO ASSIST WITH THIS.

THE DEPARTMENT OF WATER AND ENVIRONMENTAL REGULATION (DWER) ADMINISTERS THE CLEARING PROVISIONS OF THE ENVIRONMENTAL PROTECTION ACT 1986 (EP ACT). UNDER THE EP ACT, A CLEARING PERMIT IS REQUIRED TO AUTHORISE CLEARING OF NATIVE VEGETATION UNLESS A VALID EXEMPTION APPLIES OR DWER IDENTIFIES THAT A CLEARING PERMIT IS NOT REQUIRED VIA THE FORMAL CLEARING REFERRAL PROCESS. WHILE CLEARING PERMIT APPLICATIONS ATTRACT FEES, YOU DO NOT HAVE TO PAY A FEE TO SUBMIT A REFERRAL. WHEN APPLYING TO DWER ENSURE THAT THE FOLLOWING WORDING IS INCLUDED IN THE RELEVANT FORMS:

- "ALL OTHER CONSTRAINTS HAVE BEEN CONSIDERED AND CLEARING WAS DEEMED THE MOST SIGNIFICANT IMPACT. METHODS TO AVOID AND MINIMISE CLEARING CONSIDERED DURING THE DESIGN PHASE INCLUDED;
1. PLACEMENT OF LAYDOWN AREAS, TURNAROUNDS ETC. IN PREVIOUSLY CLEARED LAND
  2. UTILISATION OF EXISTING ACCESS TRACKS WHERE POSSIBLE
  3. RESTRICTION OF WORKS TO EXISTING MAINTENANCE ZONE WHERE POSSIBLE
  4. UTILISATION OF PRUNING INSTEAD OF CLEARING WHERE POSSIBLE
  5. UTILISATION OF FARMER'S PADDOCKS AND PREVIOUSLY CLEARED AREAS WHERE POSSIBLE
  6. UNDERGROUNDING OF CABLES AND DRILLING INSTEAD OF TRENCHING
  7. SELECTION OF JOINT AND ENTRY/EXIT HOLE LOCATIONS TO AVOID CLEARING OF (HIGH VALUE VEGETATION)
  8. HELICOPTER INSTALLATION INSTEAD OF GROUND WORK
  9. EARLY AND CONTINUAL ENGAGEMENT WITH WESTERN POWER ENVIRONMENT TEAM TO HIGHLIGHT PROPOSED RISKS AND AVOID WHERE POSSIBLE
  10. USING LARGER LINE SPANS THAT CAN SPAN OVER VEGETATION
  11. USING STRUCTURES WITH SMALLER FOOTPRINTS
  12. IMPLEMENTING LOWER IMPACT CLEARING METHODOLOGIES, FOR EXAMPLE HAND CLEARING INSTEAD OF MECHANICAL CLEARING"

REFER TO <https://www.wa.gov.au/service/environment/environment-information-services/clearing-permits> FOR FURTHER INFORMATION ON CLEARING APPROVAL REQUIREMENTS. ADVICE ON RELEVANT EXEMPTIONS CAN BE OBTAINED VIA "DWER'S GUIDE 1 - EXEMPTIONS AND REGULATIONS FOR CLEARING NATIVE VEGETATION" AND CLARIFICATION CAN BE SOUGHT VIA EMAILING DWER DIRECTLY VIA [info@dwer.wa.gov.au](mailto:info@dwer.wa.gov.au).

DETAIL A OF 372m2 IS THE AREA IN WHICH A CLEARING PERMIT IS REQUIRED, WHICH WILL ALLOW FOR THE WORKS TO PROCEED. THE AREA THAT IS DEFINED IS THE OPERATIONAL POTENTIAL IMPACT OF PERFORMING THE CONSTRUCTION WORKS. THIS PERMIT ALLOWS FOR INADVERTENT DESTRUCTION OF VEGETATION. CLEARING IS ONLY REQUIRED BY THE LANDOWNER WHERE REQUESTED BY THE WESTERN POWER CONSTRUCTION MANAGER

THE IDENTIFIED CLEARING (OR POTENTIAL OF) REQUIRED RUNS ACROSS MULTIPLE LAND TENURES. THE PROPONENTS AFFECTED ARE IDENTIFIED IN RED IN THE SITE LOCATION PLAN. DWER REQUIRES THAT WRITTEN APPROVAL TO CLEAR FROM THE LANDOWNER OR LAND MANAGER (E.G. LGA, FARMER) BE PROVIDED AS PART OF A CLEARING PERMIT REFERRAL OR APPLICATION.

PLEASE NOTE THAT DWER MAY IDENTIFY THAT THE CLEARING HAS SIGNIFICANT IMPACTS AND THERE MAY BE ADDITIONAL REQUIREMENTS BEFORE OR AFTER DWER ISSUE A CLEARING PERMIT THAT MAY IMPACT THE DELIVERY DATE. THESE MAY INCLUDE FLORA OR FAUNA SURVEY REQUIREMENTS AND HYGIENE MANAGEMENT PLANS.

PLEASE ENSURE YOU PROVIDE THE WESTERN POWER SCOPING SPECIALIST/CONSTRUCTION MANAGER WITH A COPY OF ONE OF THE FOLLOWING AS SOON AS PRACTICABLE FOR REVIEW AND SUITABILITY CONFIRMATION:

- A CLEARING PERMIT; OR
- A REFERRAL DETERMINATION NOTICE ISSUED BY DWER CONFIRMING A CLEARING PERMIT IS NOT REQUIRED; OR
- WRITTEN DETAILS OF A RELEVANT CLEARING PERMIT EXEMPTION AND SUPPORTING DOCUMENTS (INCLUDING ANY REGULATOR CORRESPONDENCE).

FURTHER RELEVANT AND SUPPORTING INFORMATION IS AVAILABLE VIA DWER'S WEBSITE. IF YOU HAVE ANY QUESTIONS ABOUT WESTERN POWER'S REQUIREMENTS, PLEASE CONTACT YOUR ALLOCATED DESIGNER.

ID	EASTING	NORTHING
A	389566.96	6315185.54
B	389563.04	6315182.43
C	389540.13	6315211.31
D	389539.17	6315209.3
E	389528.73	6315222.47
F	389545.78	6315236.54
G	389548.89	6315232.62
H	389537.26	6315222.98

A	ISSUED FOR CONSTRUCTION	D.I	03/25	
Rev.	REVISIONS	DRN	DATE	FILE REFERENCE DETAILS

NEW RESIDENTIAL SUPPLY

SUPPLY 5KVA DADMD @ 240V

LOT 23 OLD RAYMOND RD, ROELANDS

PERMIT DRAWING

DESIGNER: DYLAN IWACH

DESIGN TEAM: CCS DESIGN TEAM D

EMAIL: CCS.DESIGN.D@WESTERNPOWER.COM.AU

TEL: 13 10 87

DATE: 03/25

SCALE: AS SHOWN @ A2

GEO REF: Lat. - 33°17'46.599" S  
Long. - 115°48'49.372" E

westernpower

DRAWING NUMBER

SP052272

SHEET 02 OF 02

REV: A

ORIGINAL SIZE - A2