



# Clearing Referral

## Buller Road & Somers Road Reserve

# Index

## Contents

1.	Background.....	3
2.	Proposed Clearing Brief.....	3
3.	Clearing Period.....	3
4.	Calculations.....	3
5.	Aerial Map.....	4
6.	Photos .....	4
7.	Transplantation .....	7
8.	QTRA.....	8

## 1. Background

The Shire's most recent development being the 'Railside Park' includes a six season indigenous gardens. This includes numerous varieties of native plants known to the area. One of the statement pieces is the use of Kingia's and Xanthorrhoea Pressi throughout the garden.

The Shire noticed on the Somers Road and Buller Road Road Reserve that there is 3 clusters being 8 trees being heavily affected by the day-to-day operations of the surrounding property (Fruitico). The Shire is proposing to remove these selected trees from the road reserve using machinery and ground staff and relocate these to Railside Park where they will be looked after and no longer affected by herbicide spraying.

Due to the trees being native the Shire is lodging a clearing referral, however it is the Shire's opinion that the relocation is low risk and will have more of a positive outcome for the selected trees as they are likely to survive and not die onsite due to over spraying of herbicide by the neighboring property.

## 2. Proposed Clearing Brief

The selected trees will be relocated by Shire personnel with a minimum of 15 year's experience in the Horticulture field. Relocation will include a mechanic and grounds crew.

The crew will aim not to stress the grass trees out during the transplantation phase by following the below steps.

- Remove dead matter.
- Cut the green matter back to 1/3 of its length.
- Dig up soil around the grass trees to minimize root stress.
- The 'spider web mesh' of roots are kept intact and not disturbed.
- The plant is moved to a container that contains the exact soil it came from.
- The plant is watered with a sea-mineral solution such as Seasol.

Once transplanted the trees will be cared for by our Parks and Gardens crew. The trees will be within a reticulated garden system however the Shire does have a trailer mounted watering unit which will be used also to ensure they have maximum transplant success rate.

## 3. Clearing Period

It is expected the relocation of the tree will take place around September 2025.

## 4. Calculations

The clearing will be for three native trees as outlined below.

Tree Details/ Species	Quantity
Kingias Australis	5
Xanthorrhoea Pressi	3

## 5. Aerial Map



*Image: Clearing area as per the online submission.*

## 6. Photos



*Image: Kingias Australis on Buller Road*





*Image: Kingias Australis on Somers Road*



*Image: Kingias Australis on Somers Road*





*Image: Kingia Australis on Buller Road*

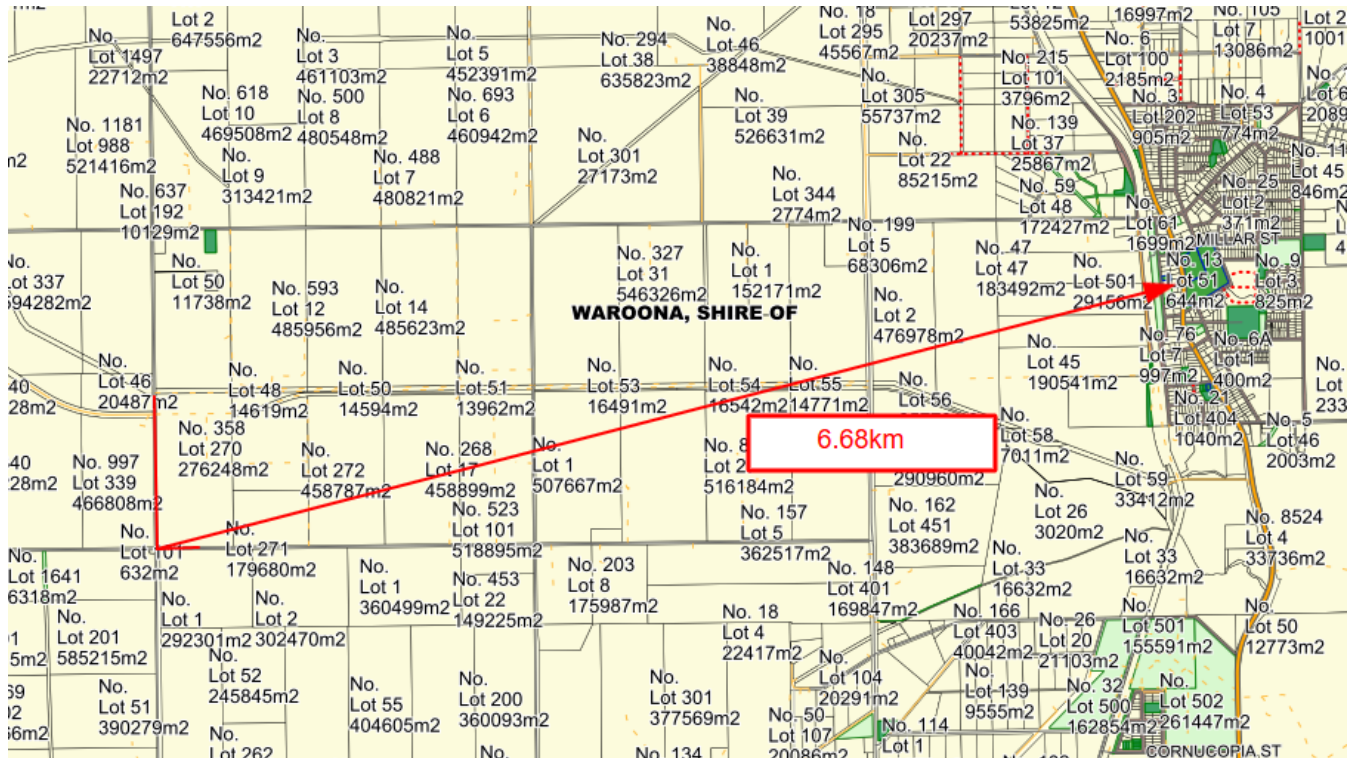

*Image: Xanthorrhoea Pressi on Somers Road*



## 7. Transplantation

As outlined in section 2 the Shire intends to transplant these species to the railside park located on Fouracre Street within the Waroona townsite. This is estimated 6.68km from their current location.



8. QTRA

Site Opposite 997 Bullers Road

Ref: PO79112

VALID

Balga (003) | Detailed Tree Risk-Benefit Assessment

Balga (003)



Summary

Risk

Highest Risk

Acceptable

Risk Reduction

Transplant to another location

Tree Management

Transplant

Review Year

2025

Date Assessed

2025-06-30 10:36

Assessed By

Sam Russell

Phone Number

0455916195

Email

sam@petestreeworx.com.au

Tree Details and Location



Species	Height (m)	Stem Ø (cm)	Crown Ø (m)
Balga	1m - 80cm	40cm	1m
Zanthoxea pressii			
Waroona			

Likelihood of Occupation



Consequences

No Image Provided

Likelihood of Failure

VITALITY

ANATOMY

LOAD

IDENTITY

DEFECT

V

A

L

I

D

crown density

wooded response growth

wood properties and structure

RIB ratio

exposure changes to the tree

changes around tree

species profile

agent wounds

COGCT

characterised decay - rot

feature or fault

Excellent vitality

Multi-headed specimens

Habitat unchanged

No sign of damage

No signs of decay presenting

Notes

The highest risk is decking health due to pesticide use

Risk Inputs

Structure

Parked

Services

Train | Tram

Property

Tree

Stem

Branch

Deadwood

O

C

F

5

5

5

Very Low

Very Low

Very Low

petestreeworx.com.au

Image: QTRA completed on 30<sup>th</sup> June 2025

Index - Buller and Somers - Clearing Referral -

Page | 8



Summary

Risk

Bullanock (002)



<b>Highest Risk</b>	<b>Acceptable</b>
Risk Reduction	Transplant to other location
Tree Management	Transplant
<b>Review Year</b>	<b>2025</b>
Date Assessed	2025-06-30 10:17
Assessed By	Sam Russell
Phone Number	0455916195
Email	sam@petestreeworx.com.au



Tree Details and Location



Species	Height (m)	Stem Ø (cm)	Crown Ø (m)
Bullanock Kingia australis	2.5 - 1.5m	25-30cm	80cm
Waroona			

Risk Inputs

Likelihood of Occupation





Structure



Parked



Services



Train | Tram



Property

Consequences





Tree



Stem



Branch



Deadwood



5  
Very Low

Likelihood of Failure

VITALITY	V	crowns density woundwood response growth	G
ANATOMY	A	wood properties architecture R/D ratio	G
LOAD	L	exposure changes to the tree changes around tree	G
IDENTITY	I	species profile age of wounds CODIT	G
DEFECT	D	woundwood decay - extent feature or fault	G

High vitality
Excellent architecture
Within buffer zone from Fruitico.
No signs of damage.Recently flowered/ flowering
No defects presenting

Notes

The highest risk is decking due to pesticide use



Bullanock (001)



Highest Risk	Acceptable
Risk Reduction	Transplant to new location
Tree Management	Transplant
Review Year	2025
Date Assessed	2025-06-30 10:01
Assessed By	Sam Russell
Phone Number	0455916195
Email	sam@petestreeworx.com.au

Risk



Tree Details and Location



Species	Height (m)	Stem Ø (cm)	Crown Ø (m)
Bullanock Kingia Australis	1.5m	30	1m
Waroona			

Risk Inputs

Likelihood of Occupation



Structure

Parked

Services

Train | Tram

Property

Consequences



Tree

Stem

Branch

Deadwood

5  
Very Low

Likelihood of Failure

VITALITY: V

ANATOMY: A

LOADS: L

IDENTITY: I

DEFECT: D

Good vitality, surrounding kingias have perished

Great architecture

Within buffer zone of Fruitico

No signs of damage. Recently flowered

No defects presenting

Good vitality, surrounding kingias have perished
Great architecture
Within buffer zone of Fruitico
No signs of damage. Recently flowered
No defects presenting

Notes

The highest risk is declining health due to pesticide use