

SITE LOCATION PLAN
SCALE: 1:2,000

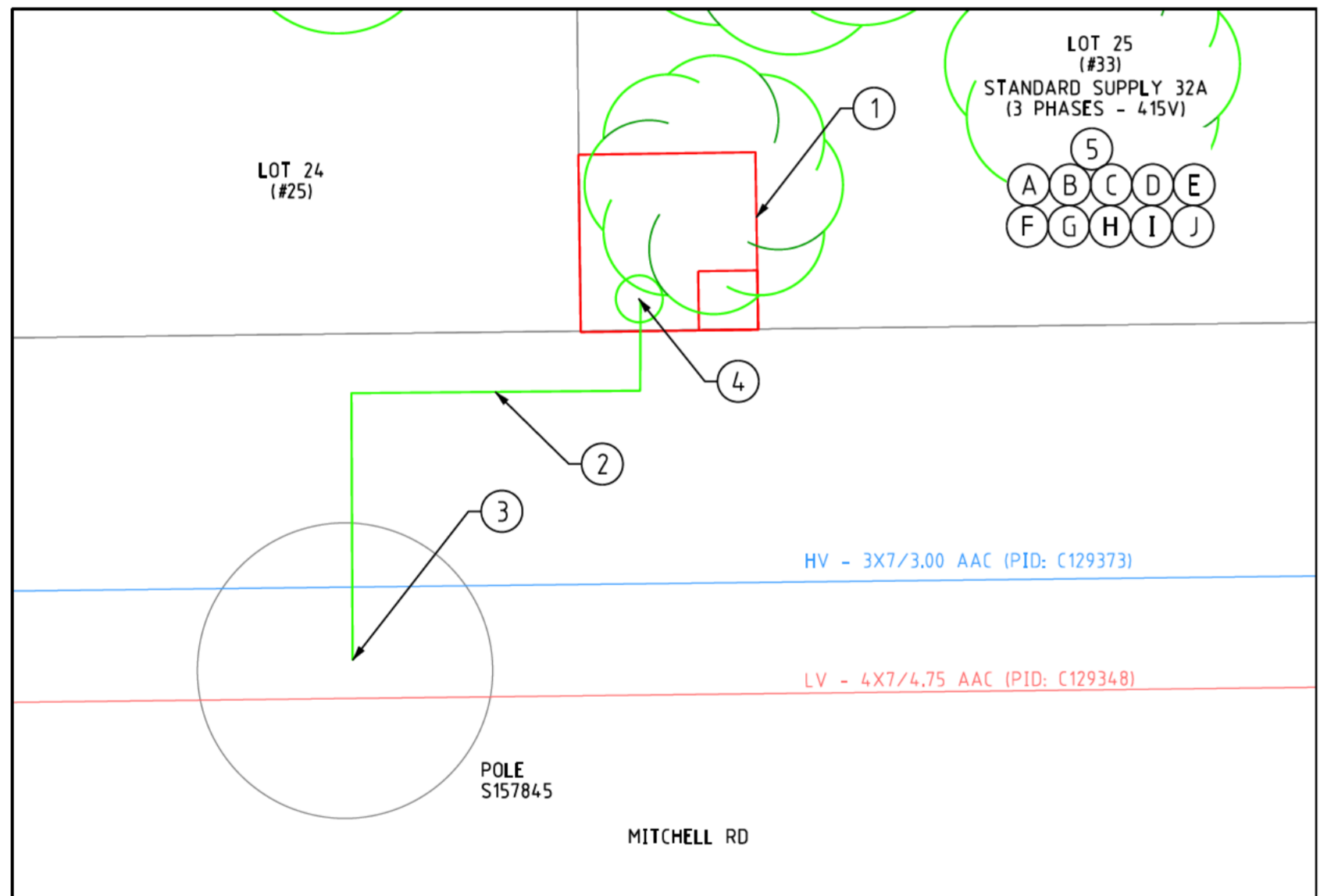

DETAIL A
SCALE: 1:50

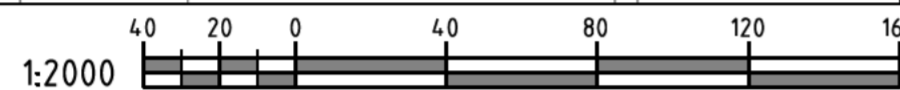
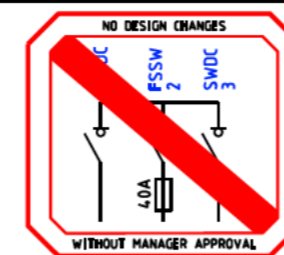
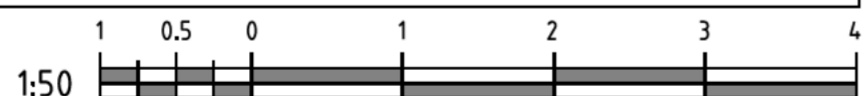

CRITICAL RISK MANAGEMENT

LEGEND

LV-SL CABLES

- CN45 - 240mm2 (1x3c)
- CN44 - 185mm2 (1x3c)
- CN43 - 120mm2 (1x3c)
- CN42 - 25mm2 (1x3c)
- CN41 - 16mm2 SL (1c)
- 40 C PILOT

EXISTING LV CABLES (SIZE AND TYPE INDICATED)

PILLARS / PITS / ETC

- MINI (WORKING END)
- UNIVERSAL
- MINI
- LINK
- CABLE MARKER U/G
- UMS PIT
- UTILITIES PIT
- BGSP PIT
- 100/200AMP CUTOUT
- CONDUIT / POLY PIPE
- 100/200AMP CUTOUT
- 100/200AMP CUTOUT

AERIAL CONDUCTORS AND POLES

- NEW POLE (ANY TYPE AS INDICATED)
- EXISTING POLE (ANY TYPE AS INDICATED)
- EXISTING AERIAL CONDUCTORS (SIZE AND TYPE INDICATED)

WESTERN POWER SCOPE OF WORKS

- INSTALL NEW MINI PILLAR ON LOT 25 (#33) AS PER CUSTOMER'S PEGGED LOCATION AND PILLAR EXCLUSION ZONE DETAIL.
CU = LU10 x 1
DCSH = U08-04
- INSTALL NEW 25LV CABLE FROM EXISTING POLE S157845 TO NEW MINI PILLAR ON LOT 25 (#33).
CU = CN42 x 30m, CN54 x 2, CN73_LV25 x 3
- TERMINATE NEW 25LV CABLE ONTO EXISTING LV BARE ON POLE S157845.
CU = LU51_25ALO x 1, LU51_25ALU x 1
DCSH = U19-T
- TERMINATE NEW 25LV CABLE INTO NEW MINI PILLAR ON LOT 25 (#33).
DCSH = U08-04
- ENVIRONMENTAL FILTER CHECKED

THE FOLLOWING ENVIRONMENTAL ISSUES HAVE BEEN IDENTIFIED FOR THIS PROJECT.

- VEGETATION
REFER TO CUSTOMER'S SCOPE OF WORK (G). WESTERN POWER MUST PROVIDE THE CUSTOMER WITH A DRAWING SHEET OF THE VEGETATION CLEARING REQUIRED. REFER TO CLEARING PERMIT WORK INSTRUCTION FOR FURTHER DETAILS.
- FAUNA
REFER TO CUSTOMER'S SCOPE OF WORK (H).
- WETLANDS AND DRAINAGE
REFER TO CUSTOMER'S SCOPE OF WORK (I).
- LAND USE PLANNING
REFER TO CUSTOMER'S SCOPE OF WORK (J).
- NATIVE TITLE
NO FURTHER ACTIONS REQUIRED FOR THIS CONSTRAINT.

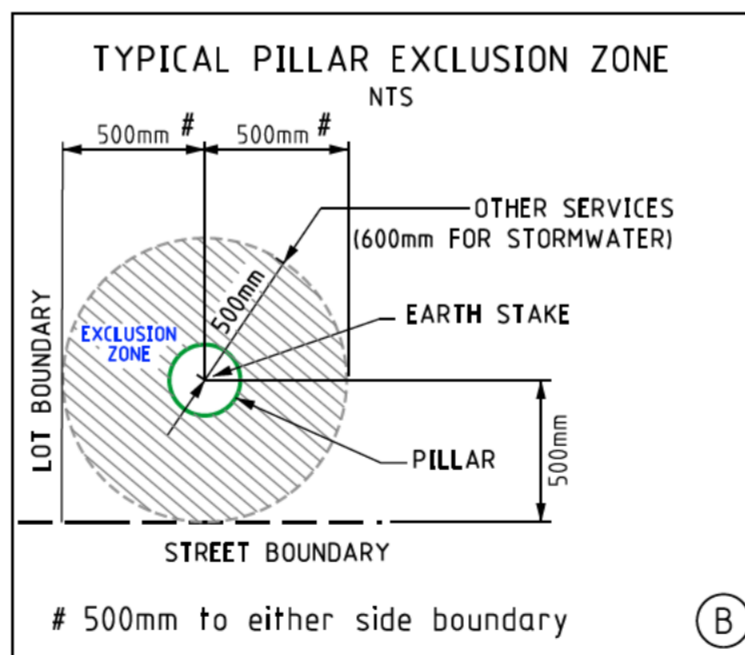

CUSTOMER SCOPE OF WORKS

- THIS DRAWING IS TO BE READ IN CONJUNCTION WITH THE WESTERN AUSTRALIAN SERVICE AND INSTALLATION REQUIREMENTS.
- PILLAR EXCLUSION ZONE TO BE PREPARED AS PER THE WESTERN AUSTRALIAN SERVICE AND INSTALLATION REQUIREMENTS CLAUSE 12.5.3. THIS INCLUDES, BUT IS NOT LIMITED TO THE FOLLOWING:
 - PEGGING THE PILLAR LOCATION AND ADJACENT BOUNDARY LOCATION PRIOR TO CONSTRUCTION.
 - ONLY EASILY REMOVABLE SURFACE TREATMENT IS TO BE INSTALLED IN THIS AREA, SUCH AS BRICK PAVING.
 - CLEAR OF ALL SERVICES INCLUDING CONTAMINATED SOIL, ASBESTOS ETC.
 - LOCATED 300mm ABOVE 100 YEAR FLOOD LEVEL AND NOT IN A PRECARIOUS POSITION.
- CUSTOMER MUST COMPLY WITH POWER QUALITY LIMITS AS PER AS/NZS TS IEC 61000.3.5 AND WESTERN POWER TECHNICAL REQUIREMENTS.
- CUSTOMER IS RESPONSIBLE TO ARRANGE FOR WESTERN POWER SERVICE REQUEST OR AN APPROPRIATELY ACCREDITED ELECTRICAL CONTRACTOR TO TERMINATE ALL CONSUMER MAINS TO THE NEW MINI PILLAR. MAXIMUM SIZE CONSUMER MAINS THAT CAN BE TERMINATED IS 35mm2/PHASE.
- CUSTOMER MSB MUST BE WITHIN 30m FROM THE PROPOSED PILLAR.
- CUSTOMER IS RESPONSIBLE TO ARRANGE FOR WESTERN POWER ELECTRICAL CONTRACTOR SERVICE REQUEST OR AN APPROPRIATELY ACCREDITED ELECTRICAL CONTRACTOR TO INSTALL DIRECT METERING IN THE SWITCHBOARD PRIOR TO SUPPLY BEING ENERGISED.
- THE CUSTOMER IS RESPONSIBLE FOR OBTAINING ALL NECESSARY CLEARING APPROVALS AND PRIOR TO WESTERN POWER COMMENCING WORKS, THE CUSTOMER IS REQUIRED TO PROVIDE A COPY OF EITHER:
 - A CLEARING PERMIT ISSUED IN THE CUSTOMER'S NAME; OR
 - A REFERRAL DETERMINATION NOTICE ISSUED BY DEPARTMENT OF WATER AND ENVIRONMENTAL REGULATION (DWER) CONFIRMING A CLEARING PERMIT IS NOT REQUIRED BY THE CUSTOMER; OR
 - WRITTEN DETAILS OF A RELEVANT CLEARING PERMIT EXEMPTION AND SUPPORTING DOCUMENTS (REGULATOR CORRESPONDENCE / LANDOWNER EXEMPTION CLEARING LETTER). THE ABOVE MUST INCLUDE RELEVANT DEVELOPMENT APPROVALS FOR THE WORKS (I.E. BUILDING APPROVALS FOR A STRUCTURE THAT REQUIRES CLEARING TO CONSTRUCT). IF REQUIRED, APPROVALS / EXEMPTIONS CAN BE SENT TO THE SAFETY, HEALTH AND ENVIRONMENT (SHE) ENVIRONMENT TEAM VIA ENVIRONMENT@WESTERNPOWER.COM.AU FOR REVIEW AND SUITABILITY CONFIRMATION. ALLOW 10 BUSINESS DAYS FOR ENVIRONMENT TEAM TO REVIEW.
- IF NATIVE VEGETATION CLEARING IS REQUIRED, THE CUSTOMER SHALL UNDERTAKE ANY NECESSARY FAUNA SURVEYS AND, IF REQUIRED, OBTAIN RELEVANT STATE / COMMONWEALTH APPROVALS FOR IMPACTS TO THIS SPECIES AND/OR ITS HABITAT. ALL SURVEYS, APPROVALS, AND RELEVANT MANAGEMENT ACTIONS SHALL BE PROVIDED TO WESTERN POWER FOR RECORD KEEPING AND REVIEW.
- THE PROJECT IS LOCATED IN MIDDLE HELENA CATCHMENT AREA (P2 ZONE) A PUBLIC DRINKING WATER SOURCE AREA WHERE RESTRICTIONS ON PERMITTED LAND USES APPLY. THERE SHOULD BE NO REFUELLING ON SITE, NOR ANY USE OR STORAGE OF CHEMICALS. A CONTINGENCY PLAN FOR MANAGING AND RESPONDING TO OIL SPILLS SHOULD BE IN PLACE.
- THE CUSTOMER IS RESPONSIBLE FOR CONSULTING WITH THE CITY OF KALAMUNDA AND CONFIRMING AND SATISFYING ANY DEVELOPMENT APPLICATION (DA) REQUIREMENTS, PROVIDING EVIDENCE TO WESTERN POWER.

ISSUED FOR CONSTRUCTION

HIGH FIRE RISK AREA

TO BE CONSTRUCTED DE-ENERGISED UNLESS RISK ASSESSED

CUSTOMER CONTACT DETAILS
N/A

Rev.	REVISIONS	DRN	DATE	FILE REFERENCE DETAILS
A	ISSUED FOR CONSTRUCTION		03/26	SHE ASSESSMENT FILTER REPORT VOLT ID18-105975859-12488943 HAZARD MANAGEMENT REGISTER VOLT ID18-105975859-12488944

32A MAX DEMAND SUPPLY - 415V
NEW STANDARD RESIDENTIAL SUPPLY
LOT 25 (#33) MITCHELL RD, WALLISTON, WA 6076
NETWORK VOLTAGE: 22kV / 415V

westernpower
DRAWING NUMBER
MP219970
SHEET 01 OF 01
REV: A ORIGINAL SIZE - A2



SITE LOCATION PLAN
SCALE: 1:1,000

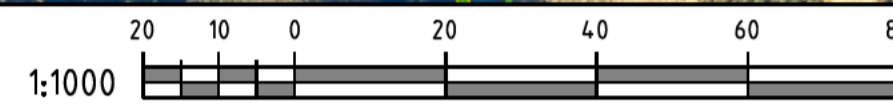

DETAIL A
SCALE: 1:100



PEG NO.	VEGETATION CLEARING COORDINATES IN MGA 94-50	
	EASTING	NORTHING
A	413062.14	6459534.828
B	413067.116	6459534.886
C	413067.076	6459538.377
D	413070.576	6459538.376
E	413070.650	6459531.998
F	413062.205	6459531.987

VEGETATION I

WITH REGARD TO YOUR POTENTIAL CLEARING WORKS, YOU AS THE CUSTOMER IS RESPONSIBLE FOR OBTAINING ALL NECESSARY PERMITS AND APPROVALS. YOU CAN CONTACT THE DEPARTMENT OF THE ENVIRONMENT AND HERITAGE FOR MORE INFORMATION ON THE CLEARING PERMIT APPLICATION PROCESS.

THE DEPARTMENT OF THE ENVIRONMENT AND HERITAGE WILL NOT AUTHORISE CLEARING WORKS WITHOUT A CLEARING PERMIT. YOU MUST APPLY FOR A CLEARING PERMIT BEFORE COMMENCING ANY CLEARING WORKS.

"ALL OTHER CONSTRAINTS AND METHODS TO AVOID A CLEARING PERMIT REFERRAL OR APPLICATION."

1. PLACEMENT OF
2. UTILISATION OF
3. RESTRICTION OF
4. UTILISATION OF
5. UTILISATION OF
6. UNDERGROUNDING
7. SELECTION OF VEGETATION
8. HELICOPTER INS
9. EARLY AND CO
10. PROPOSED RISKS AND
11. USING LARGER
12. USING STRUCTU
13. IMPLEMENTING L
14. MECHANICAL CLEARING

REFER TO <https://www.dwer.wa.gov.au/> FOR FURTHER INFORMATION. CLEARING PERMIT APPLICATIONS CAN BE SUBMITTED VIA THE DWER WEBSITE.

DETAIL A OF 36.5m2 CLEARING WORKS TO PROCEED. CONSTRUCTION WORKS TO BE COMPLETED AS REQUIRED BY THE LOCAL GOVERNMENT.

THE IDENTIFIED CLEARING WORKS AFFECTED ARE SHOWN IN RED. APPROVAL TO CLEARING WORKS MUST BE OBTAINED VIA A CLEARING PERMIT REFERRAL OR APPLICATION.

PLEASE NOTE THAT DWER MAY IDENTIFY THAT THE CLEARING HAS SIGNIFICANT IMPACTS AND THERE MAY BE ADDITIONAL REQUIREMENTS BEFORE OR AFTER DWER ISSUE A CLEARING PERMIT THAT MAY IMPACT THE DELIVERY DATE. THESE MAY INCLUDE FLORA OR FAUNA SURVEY REQUIREMENTS AND HYGIENE MANAGEMENT PLANS.

PLEASE ENSURE YOU PROVIDE THE WESTERN POWER SCOPING SPECIALIST/CONSTRUCTION MANAGER WITH A COPY OF ONE OF THE FOLLOWING AS SOON AS PRACTICABLE FOR REVIEW AND SUITABILITY CONFIRMATION:

- A CLEARING PERMIT; OR
- A REFERRAL DETERMINATION NOTICE ISSUED BY DWER CONFIRMING A CLEARING PERMIT IS NOT REQUIRED; OR
- WRITTEN DETAILS OF A RELEVANT CLEARING PERMIT EXEMPTION AND SUPPORTING DOCUMENTS (INCLUDING ANY REGULATOR CORRESPONDENCE).

FURTHER RELEVANT AND SUPPORTING INFORMATION IS AVAILABLE VIA DWER'S WEBSITE. IF YOU HAVE ANY QUESTIONS ABOUT WESTERN POWER'S REQUIREMENTS, PLEASE CONTACT YOUR ALLOCATED DESIGNER.

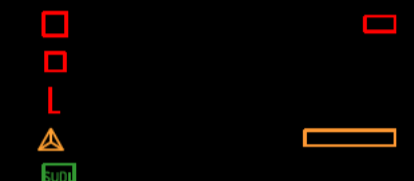
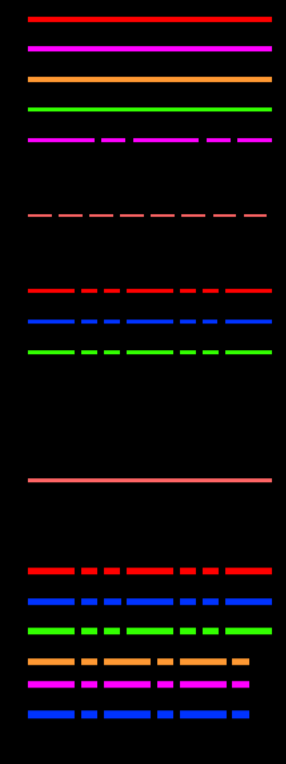

ISSUED FOR CONSTRUCTION

HIGH FIRE RISK AREA

TO BE CONSTRUCTED DE-ENERGISED UNLESS RISK ASSESSED

NO NATIVE VEGETATION MAY BE DISTURBED WITHOUT A PERMIT OR OUTSIDE OF THE PERMIT AREA. IF IN DOUBT, PLEASE CONTACT THE RELEVANT MANAGER WHO WILL CONTACT WESTERN POWER ENVIRONMENTAL TEAM.
PLEASE NOTE: HEAVY PENALTIES MAY APPLY TO INDIVIDUALS AND BUSINESSES FOR DAMAGE TO NATIVE VEGETATION WITHOUT A PERMIT.

SUPPLY - 415V
 110V SUPPLY
 ALLISTON, WA 6076
 22kV / 415V

westernpower
 DRAWING NUMBER
MP219970
 SHEET 01 OF 01
 REV: A ORIGINAL SIZE - A2